

JUDGING SCHEDULE



CROWN CLASSIC

DOG SHOW

PRESENTED BY CALEDON
KENNEL ASSOCIATION

Friday, NOVEMBER 30, 2018
Saturday, DECEMBER 1, 2018
Sunday, DECEMBER 2, 2018

INTERNATIONAL CENTRE
6900 Airport Road
Mississauga, Ontario
Hall 1



SUMMARY

| | <u>Fri.</u> | <u>Sat.</u> | <u>Sun.</u> |
|--------------|-------------|-------------|-------------|
| Group 1 | 102 | 164 | 155 |
| Group 2 | 37 | 59 | 62 |
| Group 3 | 102 | 150 | 143 |
| Group 4 | 37 | 42 | 36 |
| Group 5 | 78 | 81 | 95 |
| Group 6 | 70 | 87 | 79 |
| Group 7 | 48 | 59 | 56 |
| | <u>474</u> | <u>642</u> | <u>626</u> |
| Baby Puppies | 61 | 5 | |
| LBS | 95 | 17 | 128 |
| Specialties | | 217 | 184 |
| Sweepstakes | | 52 | 13 |
| | <u>630</u> | <u>933</u> | <u>951</u> |

FRIDAY, NOVEMBER 30, 2018

RING 1 - JUDGE: Ms. V. Lyne

| | | | |
|-----------|---|-------------------------|---------|
| 1:15 p.m. | 1 | BP - Basset Hound | 0-1 |
| | 5 | Basenji | 1-1-2-1 |
| | 1 | Beagle | 0-0-1-0 |
| | 2 | Dachshund (MS) | 0-1-1-0 |
| | 1 | BP - Dachshund (SS) | 1-0 |
| | 1 | Dachshund (SWH) | 0-1-0-0 |
| | 5 | Afghan Hound | 2-2-1-0 |
| | 2 | BP - Afghan Hound | 1-1 |
| 2:00 p.m. | 1 | Borzoi | 0-1-0-0 |
| | 2 | Deerhound | 0-0-0-2 |
| | 4 | Irish Wolfhound | 0-0-2-2 |
| | 1 | BP - Irish Wolfhound | 0-1 |
| | 3 | Norwegian Elkhound | 2-0-1-0 |
| | 2 | BP - Norwegian Elkhound | 0-2 |
| | 1 | Otterhound | 0-1-0-0 |
| | 5 | Rhodesian | 3-1-1-0 |
| | 1 | Saluki | 0-0-1-0 |
| 2:50 p.m. | 3 | Pomeranian | 0-0-2-1 |

RING 2 - JUDGE: Ms. W. Paquette

| | | | |
|------------|----|---------------------------|---------|
| 8:00 a.m. | 12 | Pointer (GSH) | 2-3-3-4 |
| | 4 | BP - Pointer (GSH) | 1-3 |
| | 14 | Ret (Chesapeake Bay) | 2-5-3-4 |
| | 1 | BP - Ret (Chesapeake Bay) | 1-0 |
| 9:15 a.m. | 5 | Ret (Flat-Coated) | 0-3-1-1 |
| | 11 | Ret (Golden) | 3-3-3-2 |
| | 1 | BP - Ret (Golden) | 0-1 |
| | 10 | Ret (NSDT) | 3-4-2-1 |
| | 1 | BP - Ret (NSDT) | 1-0 |
| 10:25 a.m. | 17 | Ret (Labrador) | 5-6-2-4 |
| 11:05 a.m. | 6 | Whippet | 1-1-0-4 |
| 11:20 a.m. | 9 | Havanese | 0-2-4-3 |
| 11:45 a.m. | 3 | Collie (Rough) | 0-1-0-2 |
| | 3 | Collie (Smooth) | 1-1-0-1 |
| LUNCH | | | |
| 1:15 p.m. | 16 | Alaskan Malamute | 3-6-4-3 |
| | 3 | BP - Alaskan Malamute | 2-1 |
| | 2 | Boxer | 0-0-2-0 |
| | 4 | Bullmastiff | 1-0-3-0 |
| | 1 | BP - Bullmastiff | 1-0 |
| | 3 | Canadian Eskimo | 1-1-1-0 |
| 2:25 p.m. | 1 | Cane Corso | 0-1-0-0 |
| | 1 | Eurasier | 0-0-1-0 |
| | 4 | Great Dane | 0-1-1-2 |
| | 1 | BP - Great Dane | 1-0 |
| | 3 | Great Pyrenees | 2-1-0-0 |
| | 1 | Greater Swiss Mtn | 0-1-0-0 |
| | 4 | Leonberger | 1-1-2-0 |
| | 1 | BP - Leonberger | 1-0 |
| | 3 | Newfoundland | 1-1-1-0 |
| | 4 | Rottweiler | 0-3-1-0 |
| 3:20 p.m. | 8 | Samoyed | 2-2-3-1 |
| | 1 | BP - Samoyed | 0-1 |
| | 1 | Schnauzer (Giant) | 0-0-0-1 |
| | 9 | Schnauzer (Std) | 2-4-0-3 |
| | 1 | BP - Schnauzer (Std) | 0-1 |
| | 6 | Siberian Husky | 1-2-0-3 |

RING 3 - JUDGE: Mr. M. Shoreman

| | | | |
|------------|---|-------|---------|
| 11:05 a.m. | 1 | Akita | 0-0-1-0 |
|------------|---|-------|---------|

RING 4 - JUDGE: Mr. D. Vice

| | | | |
|---|----|------------------------|---------|
| 9:00 a.m. | 2 | Bedlington Terrier | 1-1-0-0 |
| | 1 | Bull Terrier (Min) | 0-0-1-0 |
| | 1 | Cairn Terrier | 0-1-0-0 |
| | 1 | Cesky Terrier | 0-0-0-1 |
| | 1 | Dandie Dinmont | 0-0-1-0 |
| | 1 | Fox Terrier (S) | 1-0-0-0 |
| | 1 | Glen of Imaal | 0-0-0-1 |
| | 1 | Lakeland Terrier | 0-0-1-0 |
| | 2 | Norfolk Terrier | 0-2-0-0 |
| | 1 | BP - Norfolk Terrier | 1-0 |
| | 1 | BP - Norwich Terrier | 0-1 |
| | 2 | Parson Russell | 0-1-0-1 |
| | 1 | Russell Terrier | 0-0-0-1 |
| | 2 | Schnauzer (Min) | 0-0-1-1 |
| | 2 | BP - Schnauzer (Min) | 1-1 |
| 9:50 a.m. | 4 | Scottish Terrier | 2-1-1-0 |
| | 1 | Sealyham Terrier | 0-0-0-1 |
| | 1 | W.H.W.T. | 0-0-1-0 |
| | 2 | Airedale Terrier | 0-0-0-2 |
| | 1 | Bull Terrier | 0-1-0-0 |
| | 1 | Kerry Blue Terrier | 0-0-1-0 |
| | 8 | S.C.W.T. | 1-3-1-3 |
| | 1 | BP - S.C.W.T. | 0-1 |
| | 3 | Staff Bull Terrier | 0-2-1-0 |
| 10:45 a.m. | 12 | Bulldog | 4-5-2-1 |
| | 2 | BP - Bulldog | 0-2 |
| | 3 | Chinese Shar-Pei | 1-1-0-1 |
| | 2 | Chow Chow | 1-0-1-0 |
| | 1 | BP - Chow Chow | 0-1 |
| 11:35 a.m. | 1 | Am Eskimo Dog (Std) | 1-0-0-0 |
| | 2 | Bichon Frise | 0-1-1-0 |
| | 1 | Boston Terrier | 0-1-0-0 |
| | 3 | Lhasa Apso | 1-1-1-0 |
| | 1 | Lowchen | 0-0-1-0 |
| | 5 | Schipperke | 1-2-1-1 |
| | 1 | Shiba Inu | 0-0-1-0 |
| | 3 | Shih Tzu | 0-0-2-1 |
| | 1 | Tibetan Terrier | 0-0-1-0 |
| LUNCH | | | |
| 1:00 p.m. | 18 | French Bulldog | 3-7-6-2 |
| | 3 | BP - French Bulldog | 1-2 |
| | 7 | Poodle (Miniature) | 0-3-2-2 |
| | 1 | Dalmatian | 1-0-0-0 |
| | 2 | Keeshond | 0-0-1-1 |
| | 7 | Poodle (Standard) | 0-5-0-2 |
| | 1 | BP - Poodle (Standard) | 0-1 |
| 2:35 p.m. | 2 | Bernese Mtn Dog | 0-1-1-0 |
| | 1 | BP - Bernese Mtn Dog | 1-0 |
| | 14 | Doberman Pinscher | 3-4-4-3 |
| | 3 | BP - Doberman Pinscher | 1-2 |
| <u>RING 5 - JUDGE: Mr. J. Rowton</u> | | | |
| 8:00 a.m. | 8 | Vizsla | 3-1-1-3 |
| | 1 | Vizsla (WH) | 0-0-1-0 |
| | 1 | Weimaraner | 0-1-0-0 |

FRIDAY, NOVEMBER 30, 2018 (continued)**RING 5 - JUDGE: Mr. J. Rowton (cont'd)**

| | | | |
|------------|---|------------------------|---------|
| | 4 | Setter (English) | 2-0-2-0 |
| | 1 | Setter (Gordon) | 0-0-0-1 |
| | 1 | Setter (Irish) | 0-1-0-0 |
| | 1 | Setter (Irish R&W) | 0-0-0-1 |
| | 1 | Span (Brittany) | 0-0-1-0 |
| | 5 | Span (Eng Springer) | 3-2-0-0 |
| | 1 | Span (Welsh Spring) | 0-0-1-0 |
| | 2 | Span (Am Cocker) | 1-0-1-0 |
| | 5 | Span (Eng Cocker) | 2-1-1-1 |
| | 1 | BP - Span (Eng Cocker) | 0-1 |
| | 2 | Span (Clumber) | 0-1-1-0 |
| 9:40 a.m. | 7 | Australian Shepherd | 3-3-1-0 |
| | 2 | Bearded Collie | 1-0-1-0 |
| | 1 | Belgian Shepherd | 0-0-1-0 |
| | 1 | BP - Border Collie | 1-0 |
| | 1 | Finnish Lapphund | 0-0-1-0 |
| | 7 | German Shepherd | 3-2-1-1 |
| | 3 | Norwegian Buhund | 1-1-0-1 |
| | 1 | Old Eng Sheepdog | 0-0-0-1 |
| 10:35 a.m. | 4 | Min American Shep | 1-3-0-0 |
| | 3 | Mudi | 2-0-0-1 |
| | 8 | Shetland Sheepdog | 3-3-2-0 |
| | 5 | BP - Shetland Sheep | 2-3 |
| | 1 | Swedish Vallhund | 0-0-1-0 |
| | 2 | Welsh Corgi (C) | 0-0-2-0 |

2 Welsh Corgi (P) 1-0-1-0

3:15 p.m. 15 Portuguese Wtr Dog 1-6-4-4

RING 6 - JUDGE: Mr. J. Rowton

| | | | |
|------------|---|---------------------|---------|
| 11:40 a.m. | 7 | C.K.C. Spaniel | 2-2-2-1 |
| | 1 | BP - C.K.C. Spaniel | 1-0 |
| | 5 | Chihuahua (LC) | 2-2-0-1 |
| | 1 | BP - Chihuahua (LC) | 1-0 |
| | 3 | Chihuahua (SC) | 0-2-1-0 |

LUNCH

| | | | |
|-----------|----|----------------------|---------|
| 1:00 p.m. | 3 | Chinese Crested | 0-0-1-2 |
| | 2 | BP - Chinese Crested | 1-1 |
| | 2 | Coton de Tulear | 1-1-0-0 |
| | 2 | Griffon (Brussels) | 1-0-0-1 |
| | 1 | Italian Greyhound | 0-0-1-0 |
| | 2 | Japanese Chin | 0-2-0-0 |
| | 22 | Papillon | 3-5-9-5 |
| | 1 | BP - Papillon | 1-0 |
| 2:25 p.m. | 4 | Pekingese | 0-2-2-0 |
| | 2 | BP - Pekingese | 1-1 |
| | 8 | Pug | 2-1-4-1 |
| | 1 | Toy Manchester | 0-0-1-0 |
| | 1 | Xolo (Toy) | 1-0-0-0 |
| | 6 | Yorkshire Terrier | 3-1-2-0 |

SATURDAY, DECEMBER 1, 2018**RING 1 - JUDGE: Ms. M. Kipp**

| | | | |
|-----------|---|--------------------|---------|
| 8:00 a.m. | 4 | Bedlington Terrier | 1-2-1-0 |
| | 1 | Bull Terrier (Min) | 0-0-1-0 |
| | 2 | Cairn Terrier | 1-1-0-0 |
| | 1 | Cesky Terrier | 0-0-0-1 |
| | 1 | Dandie Dinmont | 0-0-1-0 |
| | 1 | Fox Terrier (S) | 1-0-0-0 |
| | 1 | Glen of Imaal | 0-0-0-1 |
| | 1 | Lakeland Terrier | 0-0-1-0 |
| | 2 | Norfolk Terrier | 0-2-0-0 |
| | 2 | Parson Russell | 0-1-0-1 |
| | 1 | Russell Terrier | 0-0-0-1 |
| | 2 | Schnauzer (Min) | 0-0-1-1 |
| 8:45 a.m. | 5 | Scottish Terrier | 1-2-1-1 |
| | 1 | Sealyham Terrier | 0-0-0-1 |
| | 1 | W.H.W.T. | 0-0-1-0 |
| | 2 | Airedale Terrier | 0-0-0-2 |
| | 2 | Bull Terrier | 1-1-0-0 |
| | 1 | Kerry Blue Terrier | 0-0-1-0 |
| | 8 | S.C.W.T. | 1-3-1-3 |
| | 3 | Staff Bull Terrier | 0-2-1-0 |

LUNCH

| | | | |
|-----------|----|---------------------|---------|
| 1:30 p.m. | 4 | Span (Eng Springer) | 1-1-1-1 |
| | 19 | Pointer (GSH) | 3-5-5-6 |

RING 2 - JUDGE: Dr. E. More

| | | | |
|------------|----|-------------------|----------|
| 12:45 p.m. | 2 | Pointer | 0-0-1-1 |
| | 1 | Pointer (GWH) | 1-0-0-0 |
| | 5 | Ret (Flat-Coated) | 0-3-1-1 |
| | 18 | Ret (NSDT) | 5-6-4-3 |
| 1:50 p.m. | 15 | Ret (Golden) | 4-4-5-2 |
| | 25 | Ret (Labrador) | 6-11-3-5 |

RING 3 - JUDGE: Mr. T. Catterson

| | | | |
|-----------|----|---------------------|---------|
| 8:30 a.m. | 14 | Bulldog | 4-6-2-2 |
| | 3 | Chinese Shar-Pei | 1-1-0-1 |
| | 2 | Chow Chow | 1-0-1-0 |
| | 1 | Am Eskimo Dog (Std) | 1-0-0-0 |
| | 2 | Bichon Frise | 0-1-1-0 |
| | 4 | Boston Terrier | 0-3-0-1 |
| 9:35 a.m. | 3 | Lhasa Apso | 1-1-1-0 |
| | 1 | Lowchen | 0-0-1-0 |
| | 7 | Poodle (Miniature) | 0-3-2-2 |
| | 5 | Schipperke | 1-2-1-1 |
| | 2 | Shiba Inu | 1-0-1-0 |
| | 1 | Tibetan Terrier | 0-0-1-0 |
| | 1 | Dalmatian | 1-0-0-0 |
| | 3 | Keeshond | 0-0-1-2 |
| | 7 | Poodle (Standard) | 0-5-0-2 |

RING 1 - JUDGE: Ms. V Lyne

| | | | |
|------------|----|-------------------|---------|
| 9:40 a.m. | 22 | Vizsla | 5-6-3-8 |
| | 1 | Vizsla (WH) | 0-0-1-0 |
| 10:35 a.m. | 7 | Shih Tzu | 1-3-1-2 |
| 10:55 a.m. | 6 | Leonberger | 1-2-2-1 |
| | 24 | Doberman Pinscher | 8-5-7-4 |

SATURDAY, DECEMBER 1, 2018 (continued)**RING 4 - JUDGE: Ms. W. Paquette**

| | | | | | |
|------------|----|---------------------|---------|---------|---------|
| | | | 1 | Beagle | 0-0-1-0 |
| | | | 10 | Whippet | 1-3-2-4 |
| 8:00 a.m. | 2 | Min American Shep | 1-1-0-0 | | |
| | 3 | Mudi | 2-0-0-1 | | |
| | 6 | Shetland Sheepdog | 2-2-2-0 | | |
| | 1 | Swedish Vallhund | 0-0-1-0 | | |
| | 2 | Welsh Corgi (C) | 0-0-2-0 | | |
| | 2 | Welsh Corgi (P) | 1-0-1-0 | | |
| | 1 | Aust Cattle Dog | 0-0-1-0 | | |
| | 8 | Australian Shepherd | 3-3-2-0 | | |
| 9:00 a.m. | 3 | Bearded Collie | 1-0-2-0 | | |
| | 1 | Belgian Shepherd | 0-0-1-0 | | |
| | 1 | Finnish Lapphund | 0-0-1-0 | | |
| | 11 | German Shepherd | 4-5-1-1 | | |
| | 1 | Iceland Sheepdog | 1-0-0-0 | | |
| | 3 | Norwegian Buhund | 1-1-0-1 | | |
| | 1 | Old Eng Sheepdog | 0-0-0-1 | | |
| 9:50 a.m. | 5 | Setter (English) | 2-1-2-0 | | |
| | 1 | Setter (Gordon) | 0-0-0-1 | | |
| | 1 | Setter (Irish R&W) | 0-0-0-1 | | |
| | 3 | Span (Brittany) | 0-2-1-0 | | |
| | 3 | Span (Field) | 1-2-0-0 | | |
| | 1 | Span (Welsh Spring) | 0-0-1-0 | | |
| | 5 | Weimaraner | 1-3-0-1 | | |
| | 5 | Span (Am Cocker) | 2-2-1-0 | | |
| | 6 | Span (Eng Cocker) | 2-2-1-1 | | |
| | 2 | Span (Clumber) | 0-1-1-0 | | |
| 11:10 a.m. | 4 | Dachshund (MLH) | 1-0-0-3 | | |
| | 8 | Dachshund (MS) | 2-4-2-0 | | |
| | 1 | Dachshund (SLH) | 0-0-1-0 | | |
| | 1 | Dachshund (SWH) | 1-0-0-0 | | |

RING 4 - JUDGE: Mr. D. Vice

| | | | | | |
|-----------|----|-------------------|---------|--|--|
| 1:30 p.m. | 1 | Akita | 0-0-1-0 | | |
| | 3 | Boxer | 1-0-2-0 | | |
| | 13 | Bullmastiff | 6-2-5-0 | | |
| 2:10 p.m. | 5 | Great Dane | 0-1-2-2 | | |
| | 6 | Great Pyrenees | 3-2-1-0 | | |
| | 5 | Newfoundland | 1-3-1-0 | | |
| | 2 | Schnauzer (Giant) | 0-0-1-1 | | |
| | 9 | Schnauzer (Std) | 2-4-0-3 | | |

RING 5 - JUDGE: Mr. J. Rowton

| | | | | | |
|-----------|---|--------------------|---------|--|--|
| 8:00 a.m. | 3 | Borzoi | 0-1-0-2 | | |
| | 2 | Deerhound | 0-0-0-2 | | |
| | 8 | Irish Wolfhound | 1-2-3-2 | | |
| | 3 | Norwegian Elkhound | 1-1-1-0 | | |
| | 1 | Otterhound | 0-1-0-0 | | |
| 8:40 a.m. | 6 | Rhodesian | 3-1-1-1 | | |
| | 1 | Saluki | 0-0-1-0 | | |
| | 6 | Afghan Hound | 3-2-1-0 | | |
| | 4 | Basenji | 1-1-1-1 | | |

| | | |
|----|---------|---------|
| 1 | Beagle | 0-0-1-0 |
| 10 | Whippet | 1-3-2-4 |

RING 5 - JUDGE: Ms. M. Kipp

| | | | |
|-----------|----|------------------|---------|
| 9:50 a.m. | 22 | Alaskan Malamute | 4-9-6-3 |
| | 8 | Bernese Mtn Dog | 2-4-2-0 |

RING 5 - JUDGE: Mr. M. Shoreman

| | | | |
|------------|----|----------------------|---------|
| 11:05 a.m. | 20 | Ret (Chesapeake Bay) | 4-7-3-6 |
|------------|----|----------------------|---------|

RING 5 - JUDGE: Mr. D. Vice

| | | | |
|------------|----|--------------------|---------|
| 12:40 p.m. | 16 | Portuguese Wtr Dog | 2-6-3-5 |
| | 4 | Rottweiler | 0-3-1-0 |

RING 5 - JUDGE: Mr. J. Rowton

| | | | |
|-----------|----|-------------------|---------|
| 1:30 p.m. | 2 | Black Russian | 1-1-0-0 |
| | 3 | Canadian Eskimo | 1-1-1-0 |
| | 1 | Cane Corso | 0-1-0-0 |
| | 1 | Eurasier | 0-0-1-0 |
| | 1 | Greater Swiss Mtn | 0-1-0-0 |
| | 11 | Samoyed | 3-4-3-1 |

RING 6 - JUDGE: Mr. J. Rowton

| | | | |
|------------|---|-----------------|---------|
| 11:30 a.m. | 7 | Collie (Rough) | 1-3-0-3 |
| | 6 | Collie (Smooth) | 1-3-1-1 |

RING 7 - JUDGE: Mr. D. Vice

| | | | |
|-----------|----|--------------------|---------|
| 8:30 a.m. | 6 | Chihuahua (LC) | 2-2-1-1 |
| | 3 | Chihuahua (SC) | 0-2-1-0 |
| | 3 | Chinese Crested | 0-0-1-2 |
| | 3 | Coton de Tulear | 1-1-1-0 |
| | 2 | Griffon (Brussels) | 1-0-0-1 |
| 9:10 a.m. | 10 | Havanese | 1-2-4-3 |
| | 9 | C.K.C. Spaniel | 3-2-3-1 |
| | 6 | Yorkshire Terrier | 3-1-2-0 |
| | 2 | Italian Greyhound | 0-0-1-1 |

| | | | |
|------------|---|----------------|---------|
| 10:30 a.m. | 7 | Siberian Husky | 1-2-1-3 |
|------------|---|----------------|---------|

| | | | |
|------------|----|----------|---------|
| 10:50 a.m. | 22 | Papillon | 3-5-9-5 |
|------------|----|----------|---------|

| | | | |
|------------|---|----------------|---------|
| 11:45 a.m. | 8 | Pug | 2-1-4-1 |
| | 4 | Pekingese | 0-2-2-0 |
| | 2 | Pomeranian | 0-0-2-0 |
| | 1 | Toy Manchester | 0-0-1-0 |
| | 1 | Xolo (Toy) | 1-0-0-0 |

RING 7 - JUDGE: Mr. T. Catterson

| | | | |
|-----------|----|----------------|---------|
| 2:30 p.m. | 24 | French Bulldog | 4-9-8-3 |
|-----------|----|----------------|---------|

SUNDAY, DECEMBER 2, 2018**RING 1 - JUDGE: Ms. V. Lyne**

| | | | | | | | |
|-----------|---|---------------------|---------|------------------|---------|------------------|---------|
| | | | 1 | Belgian Shepherd | 0-0-1-0 | | |
| | | | 1 | Finnish Lapphund | 0-0-1-0 | | |
| | | | 11 | German Shepherd | 4-5-1-1 | | |
| 8:00 a.m. | 1 | Aust Cattle Dog | 0-0-1-0 | | | | |
| | 8 | Australian Shepherd | 3-4-1-0 | 9:00 a.m. | 1 | Old Eng Sheepdog | 0-0-0-1 |
| | 3 | Bearded Collie | 1-0-2-0 | | 7 | Collie (Rough) | 1-3-0-3 |

SUNDAY, DECEMBER 2, 2018 (continued)**RING 1 - JUDGE: Ms. V. Lyne (cont'd)**

| | | |
|---|-------------------|---------|
| 6 | Collie (Smooth) | 4-1-1-0 |
| 5 | Shetland Sheepdog | 2-1-1-1 |
| 2 | Min American Shep | 1-1-0-0 |
| 3 | Mudi | 2-0-0-1 |
| 3 | Norwegian Buhund | 1-1-0-1 |
| 1 | Swedish Vallhund | 0-0-1-0 |
| 2 | Welsh Corgi (C) | 0-0-2-0 |
| 1 | Welsh Corgi (P) | 0-0-1-0 |

11:00 a.m. 9 Whippet 0-2-1-6

11:25 a.m. 6 Yorkshire Terrier 3-1-2-0

11:40 a.m. 13 Bullmastiff 7-1-4-1

LUNCH

1:00 p.m. 20 French Bulldog 4-8-6-2

2:40 p.m. 5 Setter (English) 3-0-2-0

1 Setter (Gordon) 0-0-0-1

1 Setter (Irish R&W) 0-0-0-1

4 Span (Brittany) 1-2-1-0

5 Span (Field) 2-2-1-0

1 Span (Welsh Spring) 0-0-1-0

6 Weimaraner 1-3-0-2

5 Span (Am Cocker) 2-2-1-0

9 Span (Eng Cocker) 2-3-2-2

2 Span (Clumber) 0-1-1-0

RING 2 - JUDGE: Dr. E. More

8:00 a.m. 1 Great Pyrenees 1-0-0-0

1 Eurasier 0-0-1-0

3 Canadian Eskimo 1-1-1-0

3 Boxer 1-0-2-0

2 Black Russian 1-1-0-0

7 Bernese Mtn Dog 1-4-2-0

8:40 a.m. 19 Alaskan Malamute 4-8-4-3

1 Akita 0-0-1-0

1:00 p.m. 1 Greater Swiss Mtn 0-1-0-0

6 Leonberger 1-2-2-1

3 Newfoundland 1-1-1-0

18 Portuguese Wtr Dog 2-6-5-5

4 Rottweiler 0-3-1-0

2 Saint Bernard 0-2-0-0

9 Schnauzer (Std) 2-4-0-3

6 Siberian Husky 1-2-0-3

RING 2 - JUDGE: Ms. W. Paquette

3:00 p.m. 7 Span (Eng Springer) 3-3-1-0

16 Vizsla 3-4-1-8

1 Vizsla (WH) 0-0-1-0

RING 4 - JUDGE: Mr. T. Catterson

9:30 a.m. 3 Basset Hound 1-1-1-0

5 Basenji 1-1-2-1

1 Beagle 0-0-1-0

2 Dachshund (MLH) 1-0-0-1

8 Dachshund (MS) 2-4-2-0

1 Dachshund (SWH) 0-1-0-0

5 Afghan Hound 2-2-1-0

10:30 a.m. 3 Borzoi 0-1-0-2

2 Deerhound 0-0-0-2

9 Irish Wolfhound 1-3-2-3

3 Norwegian Elkhound 1-1-1-0

1 Otterhound 0-1-0-0

9 Rhodesian 4-2-2-1

1 Saluki 0-0-1-0

11:40 a.m. 10 Samoyed 3-3-3-1

RING 5 - JUDGE: Mr. J. Rowton

8:00 a.m. 9 Great Dane 1-2-4-2

25 Doberman Pinscher 6-5-10-4

9:25 a.m. 11 Havanese 1-3-4-3

10:45 a.m. 8 Poodle (Miniature) 0-4-2-2

7 Poodle (Standard) 0-5-0-2

11:25 p.m. 20 Ret (Chesapeake Bay) 4-7-3-6

LUNCH

1:00 p.m. 5 Ret (Flat-Coated) 0-3-1-1

16 Bulldog 4-7-2-3

2:30 p.m. 1 Pointer 0-0-0-1

14 Pointer (GSH) 3-4-4-3

1 Pointer (GWH) 1-0-0-0

15 Ret (Golden) 3-5-5-2

16 Ret (NSDT) 2-7-4-3

20 Ret (Labrador) 6-8-2-4

RING 7 - JUDGE: Ms. W. Paquette

8:00 a.m. 1 Toy Manchester 0-0-1-0

1 Xolo (Toy) 1-0-0-0

6 Chihuahua (LC) 2-2-1-1

3 Chihuahua (SC) 0-2-1-0

3 Griffon (Brussels) 1-1-0-1

1 Maltese 0-0-1-0

4 Pekingese 0-2-2-0

2 Pomeranian 0-0-2-0

8 Pug 2-1-4-1

9:10 a.m. 11 C.K.C. Spaniel 3-3-4-1

6 Chinese Crested 0-2-1-3

3 Coton de Tulear 1-2-0-0

6 Italian Greyhound 2-1-1-2

10:15 a.m. 25 Papillon 5-5-9-6

11:15 a.m. 3 Chinese Shar-Pei 1-1-0-1

2 Chow Chow 1-0-1-0

1 Am Eskimo Dog (Std) 1-0-0-0

2 Bichon Frise 0-1-1-0

2 Boston Terrier 0-1-0-1

3 Lhasa Apso 1-1-1-0

1 Lowchen 0-0-1-0

5 Schipperke 1-2-1-1

1 Shiba Inu 0-0-1-0

1 Tibetan Terrier 0-0-1-0

3 Shih Tzu 1-1-1-0

1 Dalmatian 1-0-0-0

3 Keeshond 0-0-1-2

LUNCH

1:00 p.m. 4 Bedlington Terrier 1-2-1-0

SUNDAY, DECEMBER 2, 2018 (CONTINUED)**RING 7 - JUDGE: Ms. W. Paquette (cont'd)**

| | | | | | |
|---|--------------------|---------|---|--------------------|---------|
| | | | 1 | Russell Terrier | 0-0-0-1 |
| | | | 2 | Schnauzer (Min) | 0-0-1-1 |
| 1 | Bull Terrier (Min) | 0-0-1-0 | 2 | Scottish Terrier | 0-0-1-1 |
| 2 | Cairn Terrier | 1-1-0-0 | 1 | Sealyham Terrier | 0-0-0-1 |
| 1 | Cesky Terrier | 0-0-0-1 | 1 | W.H.W.T. | 0-0-1-0 |
| 1 | Dandie Dinmont | 0-0-1-0 | 2 | Airedale Terrier | 0-0-0-2 |
| 1 | Fox Terrier (S) | 1-0-0-0 | 2 | Bull Terrier | 1-1-0-0 |
| 1 | Glen of Imaal | 0-0-0-1 | 1 | Kerry Blue Terrier | 0-0-1-0 |
| 1 | Lakeland Terrier | 0-0-1-0 | 7 | S.C.W.T. | 1-3-0-3 |
| 2 | Norfolk Terrier | 0-2-0-0 | 3 | Staff Bull Terrier | 0-2-1-0 |

GROUP JUDGING

All groups will be judged in Ring 3/4 and Best Puppy will be judged in an adjacent ring.

Friday, November 30, 2018**Saturday, December 1, 2018****Sunday, December 2, 2018****3:30 p.m.****3:30 p.m.****3:30 p.m.**

| Group | Judge | Group | Judge | Group | Judge |
|-------------|--|----------------|-----------------------------|------------------|---------------------------|
| | | 3:00 pm | Best Overall Junior Handler | 3:00 p.m. | Jr. Handling Invitational |
| 2 | Ms. V. Lyne | 7 | Ms. W. Paquette | 3 | Dr. E. More |
| 4 | Mr. D. Vice | 6 | Mr. T. Catterson | 4 | Ms. W. Paquette |
| 7 | Mr. J. Rowton | 4 | Ms. M. Kipp | 7 | Ms. V. Lyne |
| 6 | Mr. D. Vice | 2 | Mr. J. Rowton | 1 | Ms. V. Lyne |
| 1 | Ms. W. Paquette | 5 | Mr. D. Vice | 2 | Mr. T. Catterson |
| 5 | Mr. J. Rowton | 1 | Dr. E. More | 6 | Mr. J. Rowton |
| 3 | Ms. W. Paquette | 3 | Mr. J. Rowton | 5 | Ms. W. Paquette |
| BIS BPIS | Ms. V. Lyne Best Baby Puppy in Show | BIS BPIS | Mr. D. Vice | BIS BPIS | Mr. T. Catterson |

CHANGE OF JUDGE

With C.K.C. permission, the following changes have been made:

Friday, November 30, 2018

Ms. W. Paquette has exceeded her allowable limit by 1 dog. Mr. M. Shoreman will judge 1 Akita in her place. Ms. J. Rowton has exceeded his allowable limit by 3 dogs. Ms. V. Lyne will judge 3 Pomeranians in his place.

Saturday, December 1, 2018

Dr. R. Meen is unable to fulfill his judging assignment. Mr. D. Vice will judge Best in Show in his place.

Sunday, December 2, 2018

Mr. J. Rowton has exceeded his allowable limit by 25 dogs. Ms. W. Paquette will judge the following breeds in his place: 1 American Eskimo Dog (Standard), 2 Bichon Frise, 2 Boston Terriers, 3 Chinese Shar-Pei, 2 Chow Chows, 1 Dalmatian, 3 Keeshond, 3 Lhasa Apso, 1 Lowchen, 5 Schipperke, 1 Shiba Inu and 1 Tibetan Terrier.

Exhibitors affected by these changes may wish their entries, in writing, up to one hour before the judging of their breed. Exhibitors may also enter under these changes provided they are entered on one of the other days. Entries must be made **ONE HOUR BEFORE THE SHOW** starts.

**LIMITED BREED SHOW - GROUP 3
FRIDAY, NOVEMBER 30, 2018**

RING 1 - JUDGE: Ms. V. Lyne

| | | | |
|------------|----|------------------------|---------|
| 9:00 a.m. | 1 | Akita | 0-0-1-0 |
| | 13 | Alaskan Malamute | 3-4-4-2 |
| | 3 | BP - Alaskan Malamute | 2-1 |
| | 2 | Bernese Mtn Dog | 0-1-1-0 |
| | 1 | BP - Bernese Mtn Dog | 1-0 |
| | 1 | Boxer | 0-0-1-0 |
| | 3 | Canadian Eskimo | 1-1-1-0 |
| | 1 | Cane Corso | 0-1-0-0 |
| | 1 | Eurasier | 0-0-1-0 |
| | 3 | Great Pyrenees | 2-1-0-0 |
| 10:10 a.m. | 3 | Newfoundland | 1-1-1-0 |
| | 14 | Portuguese Wtr Dog | 1-6-4-3 |
| | 2 | Rottweiler | 0-1-1-0 |
| | 7 | Samoyed | 2-1-3-1 |
| | 1 | BP - Samoyed | 0-1 |
| 11:15 a.m. | 1 | Schnauzer (Giant) | 0-0-0-1 |
| | 9 | Schnauzer (Std) | 2-4-0-3 |
| | 1 | BP - Schnauzer (Std) | 0-1 |
| | 6 | Siberian Husky | 1-1-1-3 |
| Noon | | Judging Group 3 | |

RING 3 - JUDGE: Mr. M. Shoreman

| | | | |
|------------|----|----------------------|---------|
| 10:00 a.m. | 6 | Bullmastiff | 2-0-3-1 |
| | 14 | Doberman Pinscher | 3-4-4-3 |
| | 2 | BP - Doberman Pinsch | 1-1 |
| | 4 | Great Dane | 0-1-1-2 |

RING 5 - JUDGE: Mr. J. Rowton

| | | | |
|-----------|---|-----------------|---------|
| 9:25 a.m. | 4 | Leonberger | 1-1-2-0 |
| | 1 | BP - Leonberger | 1-0 |

**LIMITED BREED SHOW - EARTHDOGS
SATURDAY, DECEMBER 1, 2018**

RING 7 - JUDGE: Mr. J. Rowton

| | | | |
|-----------|---|--|---------|
| 3:30 p.m. | 2 | Dachshund (MLH) | 1-0-0-1 |
| | 5 | Dachshund (MS) | 2-2-1-0 |
| | 1 | Dachshund (SLH) | 0-0-1-0 |
| | 1 | Border Terrier | 0-0-1-0 |
| | 1 | Bull Terrier (Min) | 0-0-1-0 |
| | 1 | Dandie Dinmont | 0-0-1-0 |
| | 1 | Parson Russell | 0-0-0-1 |
| | 1 | Russell Terrier | 0-0-0-1 |
| | 1 | Schnauzer (Min) | 0-0-1-0 |
| | 2 | Scottish Terrier | 0-1-1-0 |
| | 1 | Sealyham Terrier | 0-0-0-1 |
| | | Group Judging Upon Completion of Breeds | |

**LIMITED BREED SHOW - GROUP 1
SUNDAY, DECEMBER 2, 2018**

RING 3 - JUDGE: Ms. M. Kipp

| | | | |
|------------|----|--|---------|
| 8:00 a.m. | 1 | Pointer | 0-0-0-1 |
| | 14 | Pointer (GSH) | 3-4-4-3 |
| | 1 | Pointer (GWH) | 1-0-0-0 |
| | 13 | Ret (Chesapeake Bay) | 2-4-3-4 |
| 9:10 a.m. | 4 | Ret (Flat-Coated) | 0-3-0-1 |
| | 13 | Ret (Golden) | 3-5-4-1 |
| | 13 | Ret (NSDT) | 2-5-3-3 |
| | 4 | Setter (English) | 2-0-2-0 |
| | 1 | Setter (Gordon) | 0-0-0-1 |
| | 1 | Setter (Irish R&W) | 0-0-0-1 |
| 10:40 a.m. | 3 | Span (Brittany) | 1-1-1-0 |
| | 7 | Span (Eng Springer) | 3-2-2-0 |
| | 5 | Span (Field) | 2-2-1-0 |
| | 5 | Weimaraner | 1-3-0-1 |
| 11:30 a.m. | 16 | Ret (Labrador) | 6-6-1-3 |
| | 2 | Span (Cumber) | 0-1-1-0 |
| | | LUNCH | |
| 12:45 p.m. | 14 | Vizsla | 1-4-2-7 |
| | 1 | Vizsla (WH) | 0-0-1-0 |
| | 4 | Span (Am Cocker) | 1-2-1-0 |
| | 7 | Span (Eng Cocker) | 2-2-1-2 |
| | | Group Judging Upon Completion of Breeds | |

**ALASKAN MALAMUTE CLUB OF CANADA
NATIONAL SPECIALTY SHOW
SATURDAY, DECEMBER 1, 2018**

RING 1 - JUDGE: Ms. B. Howen McMahon

| | | | |
|-----------|---|---------------------|--|
| 2:30 p.m. | | SWEEPSTAKES | |
| | 3 | 3-6 Month Dogs | |
| | 1 | Junior Puppy Dog | |
| | 1 | 3-6 Month Bitch | |
| | 1 | Junior Puppy Bitch | |
| | 2 | 12-15 Month Bitches | |
| | 1 | 15-18 Month Bitch | |

VETERAN SWEEPSTAKES

| | |
|---|-----------------------------|
| 2 | 7 to 10 Years Veteran Dogs |
| 1 | 10 to 12 Years Veteran Dog |
| 1 | 7 to 10 Years Veteran Bitch |

followed by:

RING 1 - JUDGE: Ms. C. Paterson

| | | |
|----|------------------------|----------|
| 27 | Alaskan Malamutes | 5-10-9-3 |
| 5 | BP - Alaskan Malamutes | 3-2 |
| 1 | Alt - Alaskan Malamute | 1-0 |

followed by: Junior Handling for Alaskan Malamutes only

**BULLMASTIFF FANCIERS OF CANADA
NATIONAL SPECIALTY SHOW
SATURDAY, DECEMBER 1, 2018**

RING 2 - JUDGE: Dr. A. Jones

8:30 a.m. **SWEEPSTAKES**
1 Junior Puppy Dog
1 Junior Puppy Bitch

VETERAN SWEEPSTAKES
1 7 Years and Over Veteran Bitch

followed by:

RING 2 - JUDGE: Dr. E. More

19 Bullmastiffs 7-3-7-2
2 Brace

**GERMAN SHORTHAIRED POINTER CLUB
OF CANADA
REGIONAL SPECIALTY SHOW
SATURDAY, DECEMBER 1, 2018**

RING 2 - JUDGE: Ms. R. Giannini

10:00 a.m. **SWEEPSTAKES**
2 12-18 Month Dogs
2 Junior Puppy Bitches
1 Senior Puppy Bitch
2 12-18 Month Bitches

followed by:

RING 2 - JUDGE: Dr. E. More

27 Pointer (GSH) 4-7-8-8
5 Pointing Dogs 3-2

**CHESAPEAKE BAY RETRIEVE CLUB
OF CANADA
NATIONAL SPECIALTY SHOW
SATURDAY, DECEMBER 1, 2018**

RING 2 - JUDGE: Ms. C. Brech

3:30 p.m. **SWEEPSTAKES**
1 12-15 Month Dog
1 15-18 Month Dog
1 Senior Puppy Bitch

VETERAN SWEEPSTAKES
1 10 Years and Over Veteran Bitch

followed by:

RING 2 - JUDGE: Dr. E. More

21 Ret (Chesapeake Bay) 4-9-3-5
1 Brace

**SIBERIAN HUSKY CLUB OF CANADA
REGIONAL SPECIALTY SHOW
SATURDAY, DECEMBER 1, 2018**

RING 5 - JUDGE: Mr. J. Rowton

2:15 p.m. 15 Siberian Husky 3-2-2-8
1 Alt - Siberian Husky 1-0
2 Brace

**FRENCH BULLDOG CLUB OF CANADA
SPECIALTY SHOW
SATURDAY, DECEMBER 1, 2018**

RING 6 - JUDGE: Ms. S. Simon

9:45 a.m. **SWEEPSTAKES**
2 Junior Puppy Dogs
3 Junior Puppy Bitches
1 12-18 Month Bitch

followed by:

RING 6 - JUDGE: Mr. J. Rowton

25 French Bulldogs 4-10-8-3

**PAPILLON CANADA
NATIONAL SPECIALTY SHOW
SATURDAY, DECEMBER 1, 2018**

RING 6 - JUDGE: Ms. P. Martel

2:30 p.m. **SWEEPSTAKES**
3 Junior Puppy Dogs
1 Senior Puppy Dog
1 12-18 Month Dog
1 Junior Puppy Bitch
4 Senior Puppy Bitches
3 12-18 Month Bitches

followed by:

RING 6 - JUDGE: Ms. V. Lyne

36 Papillon 7-8-14-7
1 Alt - Papillon 1-0
2 Brace
2 Stud Dogs

**CANADIAN YORKSHIRE TERRIER
ASSOCIATION INC.
SPECIALTY SHOW
SATURDAY, DECEMBER 1, 2018**

RING 7 - JUDGE: Ms. J. Van Dusen

12:15 p.m. **SWEEPSTAKES**
1 12-15 Month Dog
4 Junior Puppy Bitches
1 Senior Puppy Bitch
1 12-15 Month Bitch

followed by:

RING 7 - JUDGE: Ms. W. Paquette

15 Yorkshire Terriers 3-6-3-3

**CANADIAN SHIH TZU CLUB
SPECIALTY SHOW
SATURDAY, DECEMBER 2, 2018**

RING 7 - JUDGE: Mr. T. Catterson

1:45 p.m. 10 Shih Tzu 2-4-2-2

**GREAT DANE CLUB OF ONTARIO
SPECIALTY SHOW
SUNDAY, DECEMBER 2, 2018**

RING 1 - JUDGE: Ms. V. Lyne

10:15 a.m. 10 Great Danes 2-2-4-2

**MINIATURE POODLE CLUB OF ONTARIO
SPECIALTY SHOW
SUNDAY, DECEMBER 2, 2018**

RING 1 - JUDGE: Ms. V. Lyne

1:50 p.m. 11 Poodle (Miniature) 1-6-2-2

**D.O.B.E. ASSOCIATION
SPECIALTY SHOW
SUNDAY, DECEMBER 2, 2018**

RING 2 - JUDGE: Dr. E. More

10:45 a.m. 27 Doberman Pinschers 5-6-10-6

**SAMOYED CLUB OF ONTARIO
SPECIALTY SHOW
SUNDAY, DECEMBER 2, 2018**

RING 2 - JUDGE: Ms. R. Hughes

9:30 a.m. **SWEEPSTAKES**
1 Junior Puppy Dog
1 12-18 Month Dog
1 Junior Puppy Bitch
1 12-18 Month Bitch

followed by:

RING 2 - JUDGE: Dr. E. More

13 Samoyed 3-5-3-2

**SHIH TZU FANCIERS OF SOUTHERN
ONTARIO
SPECIALTY SHOW
SUNDAY, DECEMBER 2, 2018**

RING 5 - JUDGE: Mr. J. Rowton

10:00 a.m. 7 Shih Tzu 2-2-2-1

**BULLDOG CLUB OF CANADA
REGIONAL SPECIALTY SHOW
SUNDAY, DECEMBER 2, 2018**

RING 6 - JUDGE: Ms. M. Chisholm

9:00 a.m. **SWEEPSTAKES**
2 Junior Puppy Dogs
1 Senior Puppy Dog
3 Junior Puppy Bitches
1 Senior Puppy Bitch
1 12-18 Month Bitch

followed by:

RING 6 - JUDGE: Ms. A. Hier

21 Bulldogs 4-10-4-3
6 BP - Bulldogs 1-6

followed by: Junior Handling for Bulldogs only

**LAKESIDE TOY DOG FANCIERS
SPECIALTY SHOW
SUNDAY, DECEMBER 2, 2018**

RING 6 - JUDGE: Mr. T. Catterson

| | | | |
|------------|----|--------------------|---------|
| 12:45 p.m. | 8 | C.K.C. Spaniel | 1-2-4-1 |
| | 6 | Chihuahua (LC) | 2-2-1-1 |
| | 3 | Chihuahua (SC) | 0-2-1-0 |
| | 4 | Chinese Crested | 0-1-1-2 |
| | 4 | Coton de Tulear | 1-2-1-0 |
| | 1 | Brace | |
| | 3 | Griffon (Brussels) | 1-1-0-1 |
| 1:55 p.m. | 10 | Havanese | 1-3-3-3 |
| | 5 | Italian Greyhound | 2-1-1-1 |
| | 1 | Maltese | 0-0-1-0 |
| 2:35 p.m. | 23 | Papillon | 5-4-9-5 |
| | 4 | Pekingese | 0-2-2-0 |
| 3:40 p.m. | 2 | Pomeranian | 0-0-2-0 |
| | 8 | Pug | 2-1-4-1 |
| | 1 | Xolo (Toy) | 1-0-0-0 |
| | 6 | Yorkshire Terrier | 3-1-2-0 |

**Group Judging Upon
Completion of Breeds**

SHOW SECRETARY

MJN SHOW SERVICES
9 Samya Court
Scarborough ON M1R 2A4

Tel. (416) 759-8593

Fax (416) 759-7790

E-mail: info@mjnshowservices.com

www.mjnshowservices.com

IMPORTANT EXHIBITOR INFORMATION

THURSDAY SETUP & GROOMING AREAS

Drive-in unloading will be available at 3:00 p.m. on Thursday until 6:00 p.m. at roll-up Door 43 at the back of Hall 1. Access to Door 43 is via the roadway between Hall 5 & 5A and Hall 6. See map of facilities.

All vehicles must be out by 6:00 p.m. Vehicles must be cleared of snow before entering and any water or oil that is spilled from vehicles must be cleaned up by the vehicle owner.

The building will be open until 10:00 p.m. Thursday and from 6:00 a.m. to 10:00 p.m. on show days. (Sunday the building closes at 8 p.m.)

Pre-booked grooming areas will be designated on the floor by numbers and name of the person booking the space. There will be a map of the grooming area at the exhibitor entrance to Hall 1. Please refer to it to locate your grooming area. (*Some exhibitors are paying for hydro, so we ask that you DO NOT rearrange these sheets.*)

There is a large, free grooming area available on your left as you enter the show at Entrance 44 at the back of Hall 1.

WRISTBANDS

Exhibitors please print out ID for check-in at the show when you will receive a wristband for in-and-out access during the shows. One wristband will be issued per entry. All others will be asked to pay admission to the shows.

On Friday morning we will be allowing exhibitors to enter without checking in at the entrance to enable quicker setting up but we ask all exhibitors to return to the Show Secretary's desk, no earlier than 10 a.m. during the day to obtain their wristbands for the weekend. The sooner you have your wristband on, the easier it will be to move in and out of the building.

PARKING

All parking is free at the International Centre.

RV PARKING (*free*)

Overnight RV parking is available to a limited number of vehicles between Halls 2 and 5 (near the exhibitors' entrance to Hall 1). There will be no hook-ups and no dumping of waste water.

All Rvs and trailers must be parked in the area indicated on the map. If you require assistance parking your vehicle, an attendant will be on duty **Thursday, November 29, between 5 and 9 p.m.**

For further information, please call 416-723-0451 (Carraway Services, TICC Parking)

All RVs need to be registered at ticcparking.com.

Reservations for RV parking begin on Monday, November 26, 2018.

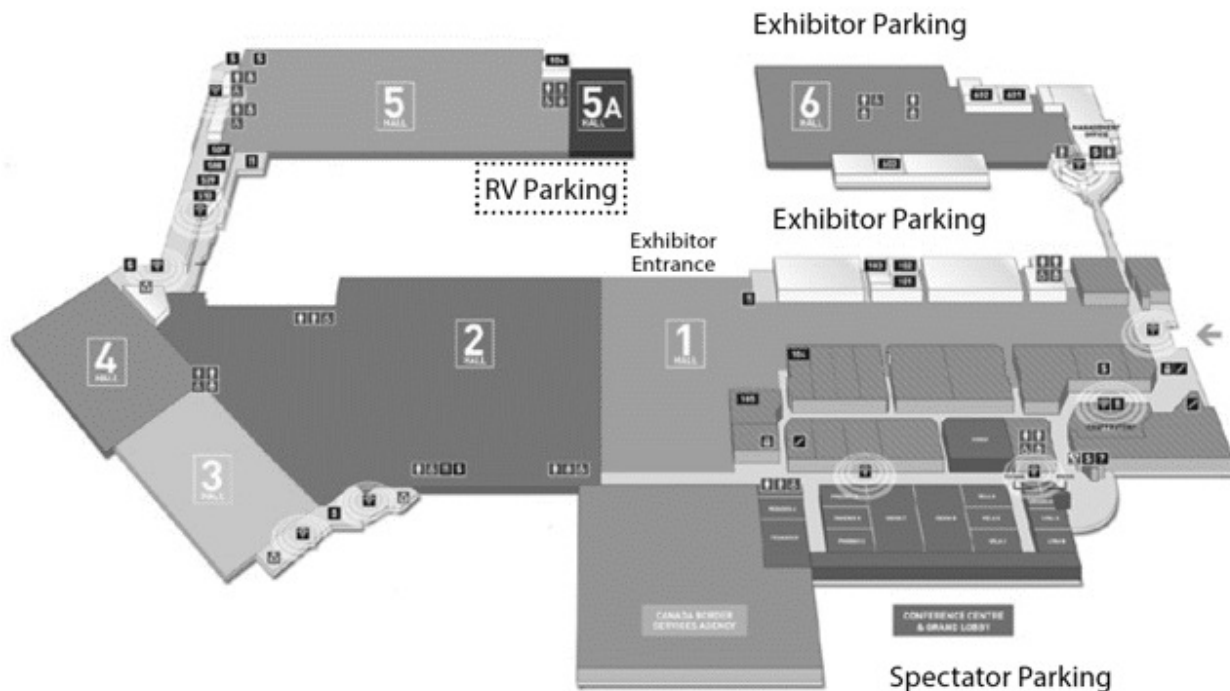

FOOD

The International Centre does not permit outside food and beverage being brought into the facility. (However, items brought in coolers for dogs are fine.) The International Centre will have a take-away snack bar in Hall 1 selling food and a bistro café in Room 104 in Hall 1. The International Centre now offers free WiFi at the entrance to all Halls.

THE ROYAL CANIN NATIONAL BREEDERS' CLASSIC
Saturday, December 1, 2018 at Noon in Rings 3 & 4

There will be two units of judging, followed by the finals. The teams drawn for each unit will be posted Friday, November 30, at the Show Secretary's desk. Judges will be drawn just prior to judging. See premium list for rules.

JUNIOR HANDLING

Saturday, December 1, 2018 - Ring 3 at 1:30 p.m. - Judge: Noreena Seery
Best Overall Junior Handler for Saturday will be judged just prior to the Groups on Saturday in Ring 3. Juniors must sign up by 12:30 p.m. at the Show Secretary's desk.

Sunday, December 2, 2018 - Ring 6 at 11:15 a.m. - Judge: Anna Hewson
Best Overall Junior Handler will be judged at the conclusion of the regular junior handling classes in Ring 6. Juniors must sign up by 10:15 a.m. at the Show Secretary's desk.

Junior Handling Invitational

Sunday, December 2, 2018 - Ring 3, just prior to the start of Group judging

Judge: Peter Scott

All first-place winners, at each competitive level (Pee wees not included), from Saturday and Sunday are invited to compete in this event. No entry is required, as this is an unofficial invitational competition. The 12 winners will advance to the final judging where each class will award a winner and from these 6 winners a single award of \$200 will be given. The remaining 5 winners will receive \$50 each..

Junior Handling Training - Friday evening, November 30, 2018 at 7:00 p.m. with Noreen Lorenz. Compliments of the Canadian Professional Handlers Association. Come along with your dog to the show site and learn from the Pros.

In Transit Area is being provided for owners/handlers who are transporting dogs not entered in the show. All dogs issued an In Transit Pass by the Show Secretary must be 6 months of age or older. The owner/agent is responsible for the care of said dog.

CGN TESTING

Caledon Kennel Association is offering testing for Canine Good Neighbour certificates at the show on Saturday and Sunday, December 1 and 2, 2018, from 10:00 a.m. to 4:00 p.m.

Cost: \$25.00 per dog.

Registrations will be accepted at the time of evaluation at the CGN Area.

Don't forget to bring your dog's CKC registered name and registration number.

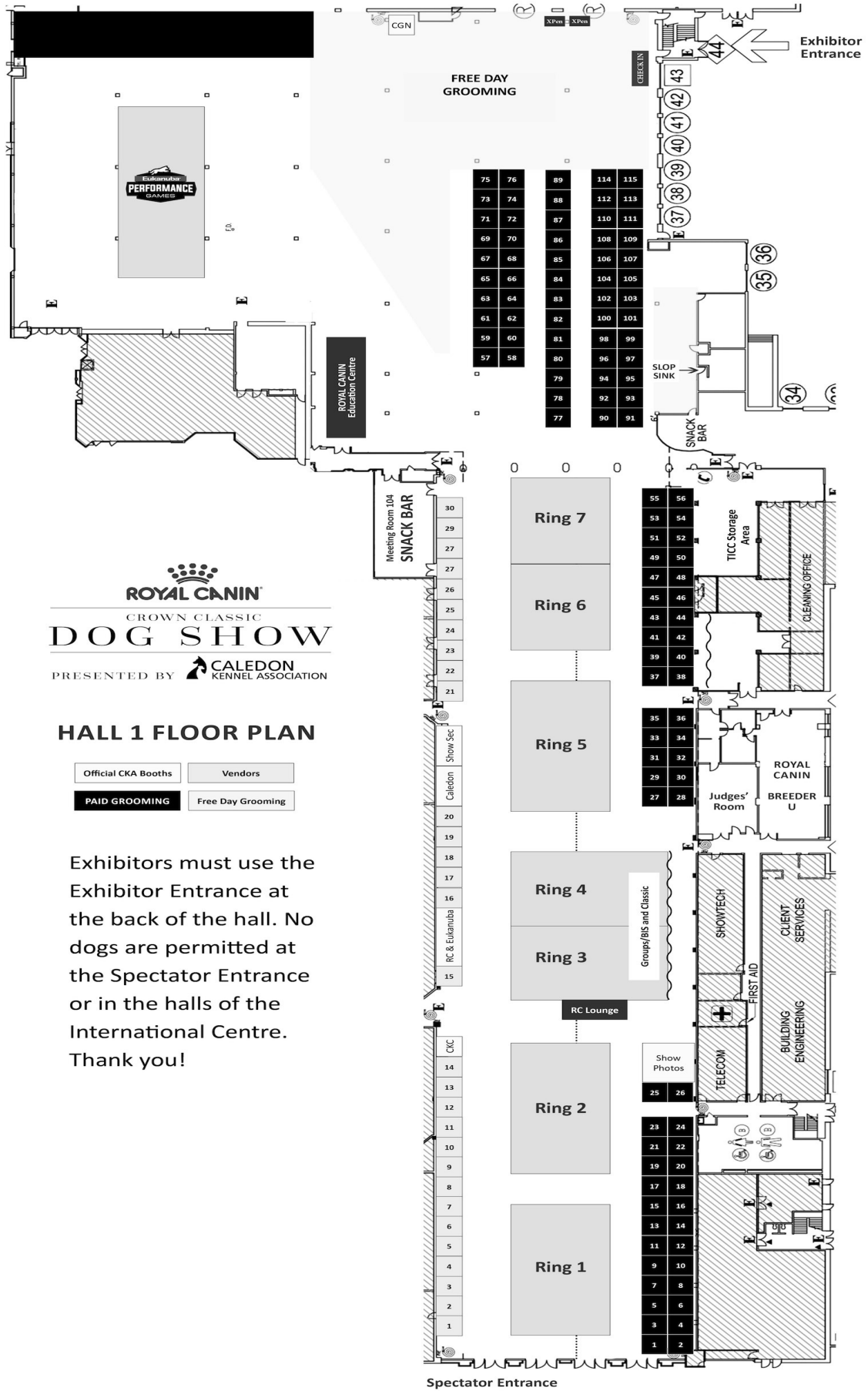

ROYAL CANIN
 CROWN CLASSIC
DOG SHOW
 PRESENTED BY  CALEDON
 KENNEL ASSOCIATION

HALL 1 FLOOR PLAN

- Official CKA Booths
- Vendors
- PAID GROOMING
- Free Day Grooming

Exhibitors must use the Exhibitor Entrance at the back of the hall. No dogs are permitted at the Spectator Entrance or in the halls of the International Centre. Thank you!

Spectator Entrance