

## Camping

There is a full hook up campground in Okotoks. Local campgrounds are subject to flooding so early reservations are recommended and be prepared to make alternate arrangements. Call the town offices to obtain information.

**On site** Portable washrooms will be available. Please park where directed.

## Directions

From Calgary – South on the #2 Highway, exit at the Okotoks overpass.  
Proceed south through the town of Okotoks to the intersection of #2A and #7 Highways.  
(There will be a Sobeys on your left at the intersection.)  
Turn right (West) on to #7 highway, continue past the Big Rock.  
Next left (South) past Big Rock – 64<sup>th</sup> Street. Proceed south on 64<sup>th</sup> Street to 455 Avenue.  
Turn left (East) on 455 Avenue and watch for signs.

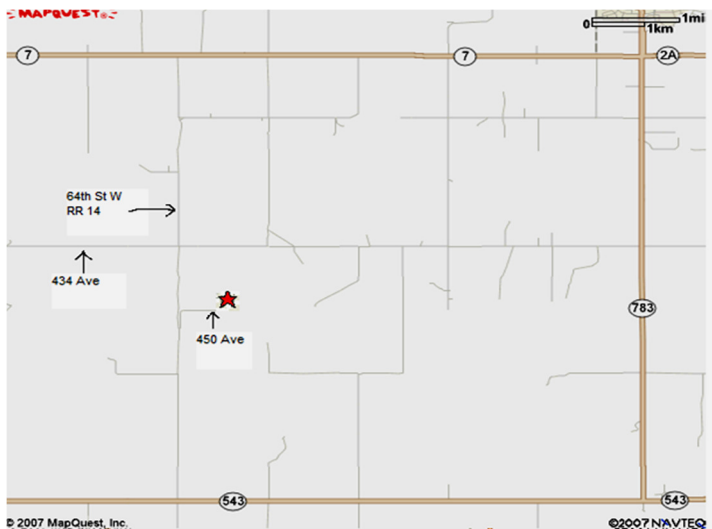
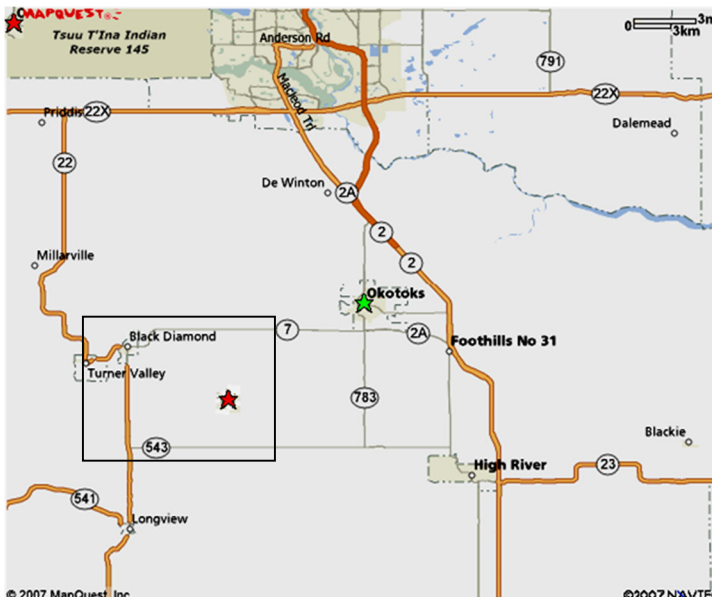

## OFFICIAL PREMIUM LIST



Border Terrier Canada

CKC Earthdog Tests

Limited Master Earthdog Entry

July 30, 2015

48120 450 Avenue W  
Okotoks, Alberta

Outdoors Rain or Shine

2 Introduction to Quarry  
2 Junior Earthdog Tests  
2 Senior Earthdog Tests  
2 Master Earthdog Tests

These events held under the rules of the Canadian Kennel Club  
(unbenched) (unexamined)

# Border Terrier Canada

## Officers of the Club

**President:** Anna Robaczewski  
**Vice President:** Pamela Dyer  
**Secretary:** Pearl Humenny  
**Treasurer:** Rosemary Shoreman

## Test Secretary

(to whom ALL entries must be sent)

Christine Duncan  
214 Douglasdale Court SE  
Calgary, Alberta T2Z 3B4  
Tel: (403) 236-0640 Fax: 1-877-99-Entry (36879)  
Email: [peaasecretary@gmail.com](mailto:peaasecretary@gmail.com)

**Test Superintendent:** Christine Duncan  
**Earth Dog Test Committee:** Marion Miners, Megan Crane, Mel Miners  
Mary Smithdorf, Christine Duncan

## CKC Officers

Canadian Kennel Club: Lance Novak, CEO  
200 Ronson Drive, Suite # 400  
Etobicoke, Ont. M9W 5Z9

CKC Director: Sharon Derrick  
60 Riverview Cl SE  
Calgary, Alberta T2C 4C4

Earthdog Zone Rep: Mary Smithdorf  
Box 14, Site 1, RR #1  
Okotoks, AB T1S 1A1

## Test Judges

Lia Bijsterveld 10500 Dennis Cr,  
Richmond, BC V7A 3R5  
Pamela Dyer 3685 Montee 4ieme Rang  
Ste-Marie-Madeleine, QC J0H 1S0  
Anna Robaczewski 6229 Regina Terrace  
Halifax NS B3H 1N4

## GENERAL INFORMATION AND TEST RULES

**ELIGIBILITY:** This test is open to all purebred Dachshunds and those CKC recognized Terriers in Group IV and the Miscellaneous Class list originally bred for or developed for use as Earthdogs, small enough to fit into a 9 inch drain, as listed in Appendix A of the CKC Earthdog Test Rules & Regulations. Dogs must be aged 6 months or older.

**ENTRY FEES:** per dog per test

<b>Advance Entry Fees if received prior to 9:00 PM, July 21, 2015:</b>	
<b>Class</b>	<b>Single Entry Fee</b>
IQ	\$15
JE, SE, ME	\$20

<b>Entry Fees if received after 9:00 PM, July 21, 2015 and Gate Entry Fees:</b>	
<b>Class</b>	<b>Single Entry Fee</b>
IQ	\$20
JE, SE, ME	\$25

**Listing Fees per entry:** if non CKC Indiv Reg's/ERN or PEN number ..... \$8.95

Mail entries may be sent to the Test Secretary, please provide an email address for confirmation of entry. **Online entries close at 9:00 pm July 28, 2015.**

Entry fees as listed above must accompany the entry. Make all cheques payable to:

**Border Terrier Canada**



**ENTER ONLINE**



**www.DogShow.ca**

TOLL FREE FAX:  
**1-877-99-ENTRY (36879)**

A service charge of 10% will be assessed. This includes entries sent online, by fax or post using a credit card for payment

**For detailed information including judges' biographies, travel and tourist information, as well as any updates, please visit our specialty page at:**

**[www.borderterriercanada.ca/2015\\_specialty/btc-package-2015.htm](http://www.borderterriercanada.ca/2015_specialty/btc-package-2015.htm)**

## GENERAL INFORMATION AND TEST RULES (Cont'd)

**ENTRIES:** Entries must be complete, signed and submitted on the official CKC entry form. The order of competing shall be the order that entries are received.

### SAME DAY MOVE UPS WILL BE ALLOWED as per Rule 6.7.1

**CLOSING DATE:** *30 minutes before the scheduled start of class* or when the stated limit has been reached. Online entries close at 9:00 pm July 28, 2015. Entries will close automatically when the following limits have been reached for each test: 10 Master Earthdog even if the official closing date and time for the entries has not arrived. Entries are accepted on a first come, first served basis. Entries for all other classes are not limited. If the ME class limit is reached prior to the closing date, a list of alternates will be kept to fill any vacancies created due to early (prior to closing date) cancellations. Entry fees will not be refunded after the closing date and time.

**CONFIRMATION OF ENTRY:** The receipt of entries will be confirmed for those providing a **return e-mail address** on their entry form.

**BITCHES IN SEASON:** Bitches in season shall not be eligible to enter the test. When a bitch comes into season after entry of the bitch has been submitted to the test secretary, a veterinarian's certificate, certifying that the bitch was in season within the 10 day period preceding the test must reach the secretary on or before the date of the test. The trial-giving club must refund the entry fee, service charge and listing fee.

**QUARRY:** The quarry used in these tests will be 2 adult gerbils.

**ATTENTION FOREIGN EXHIBITORS:** Please note that fees are due and payable in Canadian dollars. Due to fluctuating currency rates, discounted cheques will not be accepted. Personal cheques will be accepted. If you pay by personal American cheque, it must be made out for the full amount of the entry and no exchange will be refunded to the exhibitor. Do not write "Payable in Canadian Funds" or "At Par". This will not be acceptable and will not be cleared by the bank. To simplify the process, we urge you to purchase bank drafts or money orders payable in Canadian funds.

**BORDER CROSSING:** Government regulations require a valid rabies certificate for dogs entering Canada from countries not recognized by Canada as being rabies-free. The European Union pet passport is an acceptable alternative to the rabies vaccination certificate as long as all the elements outlined in the requirements are included. Canadian Food Inspection Agency requirements can be viewed at:

<http://www.inspection.gc.ca/animals/terrestrial-animals/imports/policies/live-animals/pets/dogs/eng/1331876172009/1331876307796>

**EVENT REGISTRATION NUMBER (FOREIGN BORN/FOREIGN OWNED DOG):** For the purpose of entering CKC events to obtain CKC titles, individual registration is not required for foreign born, foreign owned dogs. Foreign exhibitors may apply for an ERN (Event Registration Number). This number MUST be applied for within 30 days of entering first CKC event to avoid cancellation. Exhibitors may submit a photocopy of dog's foreign Registration Certificate and the appropriate fee along with the completed application form. The form can be downloaded from <http://www.ckc.ca/forms> or is available by contacting the CKC Order Desk at 1.800.250.8040.

**AWARDS & PRIZES:** Qualifiers in IQ will receive a Ribbon. Qualifiers in JE, SE and ME will receive a Rosette. Border Terrier Canada is pleased to offer prizes to all Border Terriers qualifying in Test I or Test II. The Canadian Scottish Terrier Club is pleased to offer prizes for qualifying Scottish Terriers competing under Lia Bijsterveld in the following classes Test I – SE and ME, Test II – JE.

**TEST PRECINCT:** The entire field south of the buildings. Dogs waiting to be tested shall be kept at least 30.5 m (100ft) from the perimeter of the test area in a designated holding area.

**REGULATIONS:** It is the responsibility of the exhibitor to be familiar with the rules pertaining to the event in which they are competing. Copies of the CKC Earthdog Test Regulations are available from the Canadian Kennel Club. Tel: (416) 675-5511.

**CKC REGULATION 15.7:** It shall be the duty and obligation of the event giving club to see that a judge, club official, volunteer or any participant at an Earthdog Test held under these regulations, is not subject to indignities. The Earthdog Test Committee Chair shall promptly report to the CKC any infringement of this regulation, and the Discipline Committee shall have the authority to take such action as it deems fit on receipt of a report indicating that this has occurred.

**TEST SITE:** Bring water, shade and shelter for you and your dogs. These tests will be run **rain or shine**. All dogs must be under control, on a leash except during the test. Flexi leads will not be allowed within the test precinct. Remember that this is private property and we are here at the pleasure of our hosts. Clean up after yourself and your dog. Please follow the directions of our parking sheriff! As is the case with most Earthdog Tests, the ground at the site is uneven. Wear appropriate footwear.

**WAIVER:** Please complete the enclosed waiver that excludes the property owners, Border Terrier Canada, and/or any person associated with the Earthdog Test from any liability for personal injury or personal property damage and submit it with your entry.

**LUNCH:** There will be a potluck lunch, please bring something to share! Restaurants are at least 15 minutes away.

## SCHEDULE FOR THE DAY

**Morning test:** Master Earthdog class will start no earlier than 8:30 AM. Introduction to Quarry will start no earlier than 9:00 AM.

**Afternoon test:** Afternoon classes will start no earlier than 1:00 PM.

Order of classes and judging assignments follow (classes may be run concurrently):

Test I:	Test II:
ME L Bijsterveld	IQ P Dyer
IQ A Robaczewski	SE A Robaczewski
SE L Bijsterveld	JE L Bijsterveld
JE A Robaczewski	ME P Dyer

## BORDER TERRIER CANADA ROOM RESPONSIBILITY POLICY

(adapted with permission from the Border Terrier Club of America Room Policy)

**Border Terrier Canada (BTC) has adopted the following rules in order to insure that its members and their dogs will be welcome at hotels in the future:**

Any individual attending a Border Terrier Canada (BTC) sanctioned event and staying in a hotel, motel, inn or campsite/fairground has the responsibility of leaving that room or campsite exactly as found. This includes picking up after dog(s) on the grounds. Anyone who damages a room or campsite/fairground and does not report the damage to the hotel/campsite/fairground management, and make immediate restitution or arrangements to do so within a period of time agreed upon by the management, will be subject to any or all of the following actions by the BTC Board of Directors.

1. May be banned from showing at the next BTC sanctioned event(s).
2. May be subject to CKC sanctions.
3. Membership in the BTC may be terminated and may not be allowed to be reinstated.

### Damages shall be defined as:

1. Flea infestation, urine, defecation and/or any damage to hotel/campsite/fairground property (walls, bedspreads, carpets, drapes, etc.).
2. Any verified complaint by the host hotel/campsite/fairground.
3. Any verified complaint by a BTC member.

### BTC Room Regulations:

1. All dogs shall be crated and quiet when left alone in a room. Noisy dogs shall be quieted upon request, even if this means the owner/handler must stay in the room with the dog.
2. Individuals will be expected to immediately report any damage by dogs or themselves to the hotel or campsite/fairground management, and to assume complete financial responsibility for those damages.
3. No bathing or grooming will be allowed in rooms. A grooming room will be available whenever possible.
4. Dogs are to be allowed on hotel furniture/beds ONLY if the furniture is covered with protective covering provided by the owner/handler.
5. All owners/handlers will take preventative measures to assure that their dogs are free of fleas, mites, intestinal parasites and other communicable diseases prior to arriving at the hotel/campsite.

## BORDER TERRIER CANADA ANNUAL GENERAL MEETING

Friday July 31st at Spruce Meadows. Time and location to be announced at the show.

## BANQUET/SILENT AUCTION Saturday, Aug 1, 2015 6:00 pm

Join us upstairs in the North American View Building overlooking the North American and All Alberta Ring for good food and even better company. Whether it is protected from any inconsiderate summer storms in the "Fish Bowl" or enjoying a perfect evening on the covered balconies, this venue has us covered.

**Barbecue Burger Menu** cost per person \$30 - deadline to reserve

Classic Caesar Salad with fresh grated aged parmesan and garlic croutons  
Certified Angus Beef® & Vegetarian Burgers on a cornmeal Kaiser  
Grilled Thuringer Bratwurst on a rustic roll with sweet mustard & All Beef Jumbo Hot Dog with a hot dog buns  
Topping Station: Canadian cheddar and Swiss cheese, tomatoes, lettuce, kosher dills, Spanish onions, mustard, ketchup and relish  
Assorted Gourmet Cookies: chocolate chunk, white chocolate macadamia, oatmeal raisin and double chocolate

**To reserve, please complete and send the form below together with your cheque to:**

**Megan Crane**  
225040 Range Road 282  
Rocky View County, AB T1X 0H9

Or alternately print off a form from [www.borderterriercanada.ca](http://www.borderterriercanada.ca).

**Deadline for receipt of BBQ reservations together with payment is Friday 17th July 2015.**

To donate to the **Silent Auction**, please contact Megan Crane at [megancrane123@gmail.com](mailto:megancrane123@gmail.com). For those who are travelling and will be bringing their donations with them, please email Megan with a description of your item so she can create a bid sheet. All donations will be collected on Friday July 31st.

BBQ Reservation Form		
Name:		
Kennel Name (if any):		
Address:		
City:	Prov:	Postal Code:
Tel:		E-mail:
Saturday evening BBQ	_____ tickets @ \$30.00	Total \$_____

## CKC Non-Member Participation Fee

*(This only applies to dogs wholly owned by non-members and is not applicable to CKC members or dogs co-owned with a CKC member, nor does it affect US exhibitors who must apply for an ERN number as noted above)*

A non-member resident in Canada is subject to the fee. Dogs co-owned with a CKC member are exempt. There are 2 options for non-members:

- a) Join the CKC, or
- b) Pay the Non-Member Participation Fee

The fee is a yearly charge based on the calendar year January 1 to December 31 in which the awards, legs, points, titles, etc. were achieved. It is not based on the number of dogs or titles or awards earned, and is assessed against the owner(s).

Non-members will receive a letter from CKC Head Office informing them that they have 30 days to join the Club or pay the Non-Member Participation Fee.

Payment of the Non-Member Participation Fee or becoming a CKC member will protect all awards, points, titles and legs in the calendar year in which they were earned. Failure to pay the fee within 30 days of the notice will result in all awards, legs, points, titles being cancelled. Once cancelled the awards, legs, points or titles will be given to the next applicable dog. Once cancellation takes place any subsequent awards titles, legs, etc. earned will automatically be cancelled without further notice.

*Please note that the CKC Membership application and the Non-Member Participation Fee forms are available on the website under CKC Services and then Forms On-Line. If submitting a Membership Application, please ensure that you also complete the Non-Member Participation Fee form so that CKC is aware of the dogs involved.*

## Border Terrier Canada Earthdog Participation Agreement

Smithart Kennels  
Site 1 Box 14 RR 1  
48120 450 Ave W  
Okotoks, AB T1S 1A1

403.540.9186  
smithart@outlook.com

### Waiver and Indemnity

It shall be known that:

Name \_\_\_\_\_

(known as participant)

spouse & minor children, if present \_\_\_\_\_

(also known as participants)

Address \_\_\_\_\_

Town, Province/State, Postal Code/Zip Code \_\_\_\_\_

Phone \_\_\_\_\_ Email \_\_\_\_\_

Hereby desires to engage in and does engage in any or all of the following canine, or other activities provided at Smithart Kennels, 48120 450 Avenue W, Okotoks, AB, T1S 1A1, owned by Mark N. and Mary C. Smithdorf.

Earthdog Tests

As a Volunteer  As a Participant  As a Spectator  As a Camper

In consideration of the above activities, services and entry fees paid, receipt and sufficiency of which is hereby acknowledged, the Participant hereby does forever and finally release, remise, satisfy, acquit, satisfy and forever discharge Border Terrier Canada, Smithart Kennels, Mark N. and Mary C. Smithdorf (including employees, teachers, trainers, and agents) of and from all manner of action and actions, cause and causes of action, suit debts, dues, sums of money, bonds, billings, contracts, controversies, agreements, promises, damages, variances, judgments, executions, claims and demands whatsoever, in the law or in equity, which may arise or might in the future arise or herein after may arise for or against Smithart Kennels, the Border Terrier Canada, or the landowners for the activities as stated above.

Photo and video release. My signature below authorizes the Border Terrier Canada to use images of me and my family to document the events we participate in. This document is meant to be a full and complete release from any and all liability that may arise on the properties of Smithart Kennels, Mark N. and Mary C. Smithdorf and employees, jointly and severally. This release is given freely and voluntarily by the participant and is meant to remain in existence throughout the duration of my presence on the property for any period of time in association with the canine event and/or other activities whether I am or am not found to be negligent while handling or near a dog in the above mentioned activities.

Date \_\_\_\_\_ Signature of participant(s) \_\_\_\_\_

Legal Guardian (if participant is a minor child) \_\_\_\_\_

**THIS AGREEMENT MUST BE SIGNED FOR YOUR ENTRY(S) TO BE ACCEPTED**

**Dog Show<sup>TM</sup>.ca**      **ENTER OUR 10th ANNIVERSARY CONTEST!**



**ENTER ONLINE AT [WWW.DOGSHOW.CA](http://WWW.DOGSHOW.CA)**  
**AND WIN A TRIP\* FOR TWO TO**  
**THE 2016 CRUFTS IN BIRMINGHAM, ENGLAND**







A service charge of 10% will be assessed. This includes entries sent online, by fax or post using a credit card for payment

\* No purchase required. Full contest details available at [www.DogShow.ca/Contest](http://www.DogShow.ca/Contest)

OFFICE USE		OFFICIAL CANADIAN KENNEL CLUB ENTRY FORM  <b>Border Terrier Canada</b> July 30, 2015		OFFICE USE
I ENCLOSE \$ _____		ENTRY FEES \$ _____		
		LISTING FEES \$ _____		
<b>PLEASE TYPE OR PRINT CLEARLY</b>				
BREED		Variety:	___ MALE ___ FEMALE	
<b>ENTER IN ONE OF THE FOLLOWING CLASSES:</b>				
Test I	Test II			Call Name:
IQ _____	IQ _____			
JE _____	JE _____			
SE _____	SE _____			
ME _____	ME _____			
REG. NAME OF DOG				
CHECK ONE AND ENTER NUMBER HERE		DATE OF BIRTH		
<input type="checkbox"/> CKC REG. NO. <input type="checkbox"/> CKC MISC. CERT. NO. <input type="checkbox"/> CKC PEN NO.		<input type="checkbox"/> CKC ERN NO. <input type="checkbox"/> LISTED		
		____ / ____ / ____ Day / Month / Year		
NUMBER:		PLACE OF BIRTH ___ CANADA ___ ELSEWHERE		
BREEDER(S)				
SIRE				
DAM				
REG'D OWNER(S)				
OWNER'S ADDRESS				
CITY		PROV./STATE	POSTAL CODE	
NAME OF OWNER'S AGENT (IF ANY) AT THE SHOW				
AGENT'S ADDRESS				
CITY		PROV./STATE	POSTAL CODE	
ID'S WILL NOT BE MAILED – PLEASE SUPPLY VALID EMAIL ADDRESS BELOW FOR ENTRY CONFIRMATION				
I CERTIFY that I am the registered owner(s) of the dog or that I am the authorized agent of the owner(s) whose name(s) I have entered above and accept full responsibility for all statements made in this entry. In consideration of the acceptance of this entry, I (we) agree to be bound by the rules and regulations of the Canadian Kennel Club and by any additional rules and regulations appearing in the premium list.				
SIGNATURE OF OWNER OR AGENT			TELEPHONE NUMBER	
E-MAIL ADDRESS:				

OFFICE USE		OFFICIAL CANADIAN KENNEL CLUB ENTRY FORM  <b>Border Terrier Canada</b> July 30, 2015		OFFICE USE
I ENCLOSE \$ _____		ENTRY FEES \$ _____		
		LISTING FEES \$ _____		
<b>PLEASE TYPE OR PRINT CLEARLY</b>				
BREED		Variety:	___ MALE ___ FEMALE	
<b>ENTER IN ONE OF THE FOLLOWING CLASSES:</b>				
Test I	Test II			Call Name:
IQ _____	IQ _____			
JE _____	JE _____			
SE _____	SE _____			
ME _____	ME _____			
REG. NAME OF DOG				
CHECK ONE AND ENTER NUMBER HERE		DATE OF BIRTH		
<input type="checkbox"/> CKC REG. NO. <input type="checkbox"/> CKC MISC. CERT. NO. <input type="checkbox"/> CKC PEN NO.		<input type="checkbox"/> CKC ERN NO. <input type="checkbox"/> LISTED		
		____ / ____ / ____ Day / Month / Year		
NUMBER:		PLACE OF BIRTH ___ CANADA ___ ELSEWHERE		
BREEDER(S)				
SIRE				
DAM				
REG'D OWNER(S)				
OWNER'S ADDRESS				
CITY		PROV./STATE	POSTAL CODE	
NAME OF OWNER'S AGENT (IF ANY) AT THE SHOW				
AGENT'S ADDRESS				
CITY		PROV./STATE	POSTAL CODE	
ID'S WILL NOT BE MAILED – PLEASE SUPPLY VALID EMAIL ADDRESS BELOW FOR ENTRY CONFIRMATION				
I CERTIFY that I am the registered owner(s) of the dog or that I am the authorized agent of the owner(s) whose name(s) I have entered above and accept full responsibility for all statements made in this entry. In consideration of the acceptance of this entry, I (we) agree to be bound by the rules and regulations of the Canadian Kennel Club and by any additional rules and regulations appearing in the premium list.				
SIGNATURE OF OWNER OR AGENT			TELEPHONE NUMBER	
E-MAIL ADDRESS:				