

**Official Premium List  
Working Certificate Tests  
August 24 & 25, 2024**



**Working Certificate Tests  
2 Working Certificate Tests \* 2 Working Certificate Intermediate Tests  
\* 2 Working Certificate Excellent Tests**

**Open to all Retrievers, Irish Water Spaniels, Poodles, Airedales, and Barbets**

**Entries Close:**

**Closing date for August 24 test is August 21 (9:00 PM)**

**Closing date for August 25 is August 24 (6:00 PM)**

**THERE WILL BE NO TAILGATE BBQ**

**WC Test Headquarters**  
Regina Retriever Club Pit

All competitors are to meet at headquarters at 8:00 AM both mornings and **WAIT FOR THE CONVOY** to go to the test. Tests will start at **9:00 AM.**

Saturday, August 24: 1 WC, 1 WCI, 1 WCX  
Sunday, August 25 : 1 WC, 1 WCI, 1 WCX

**Permission has been granted by the Canadian Kennel Club to hold these events under the rules of the Canadian Kennel Club**

Non-Member Participation Fee 24-12-

3. Non-member participation fee

b) An annual non-member participation fee for awards and titles will be charged to a Canadian non-member of CKC. The fee will match the ERN fee.

In order to protect the awards/titles earned, the non-member will have a choice either to become a CKC member or to pay the non-member participation fee. Failure to comply within 30 days of notification will cause all awards and titles to be cancel

## ENTRIES

Enter online at [www.dogshow.ca](http://www.dogshow.ca) or mail entries (official CKC entry form), along with a cheque, payable to the REGINA RETRIEVER CLUB. Cheques are to be dated no later than the closing date.



A service charge of 5% will be assessed. This includes entries sent online, by fax or post using a credit card or interac for payment.

Mail cheques and completed entries to:

Laurie Wilkinson  
219 Blue Sage Drive,  
Moose Jaw, SK S6J 1N5

E-mail entries will not be accepted.

**Closing date for August 24 test is August 21 @ 9:00 pm**  
**Closing date for August 25 test is August 24 @ 6:00 pm**

Running order will be randomly selected. Multiple entries by the same owner/handler will be separated.

A separate entry form for EACH DOG in EACH EVENT is required

All entries must be accompanied by the entry fee in full. A TCN fee of \$10.50 is applicable per dog per event unless the dog's entry carries a CKC individual registration number on the dog being entered or ERN number.

**Entry Fees** - WC - \$35.00 WCI - \$40.00 WCX - \$45.00

Standard CKC rosettes to all dogs qualifying in each event.

### **CLUB OFFICERS**

President: Ian Kutarna  
Vice-president: Axton Mihial  
Treasurer: Tyler Kuntz  
Secretary: Randy Slawson

### **WORKING CERTIFICATE TEST COMMITTEE**

#### **CHAIRPERSON:**

Bob Forbes                      [bob.forbes@sasktel.net](mailto:bob.forbes@sasktel.net)                      Cell: (306) 551-6524

#### **EVENT SECRETARY**

Laurie Wilkinson:              [lwilkinson@sasktel.net](mailto:lwilkinson@sasktel.net)                      Cell: (306) 690-6837

CKC Executive Director: Jeff Cornett, Canadian Kennel Club, 5397 Eglinton Avenue W. Suite 101, Etobicoke, ON M9C 5K6

CKC Provincial Director: (Sask.) Val Bandas, R.R. #2, Craven, SK S0G 0W0

Provincial WC Rep: Lynn Campbell, Box 176, Clavet, SK S0K 0Y0

Chapter 14, Paragraph 7, of the CKC WC Test rules state: It shall be the duty and obligation of the test-giving club to see that a judge, club official, volunteer, or any participant at a event held under these rules, is not subject to indignities of any kind. The Working Certificate Test Committee Chair shall promptly report to the CKC any infringement of this regulation, and the Discipline Committee shall have the authority to take such action as deems fit on receipt of a report indicating that this has occurred.

## Judging Schedule

Saturday, August 24

Sunday, August 25

Test	Judges	Test	Judges
WC @ 9:00am	Brenda Anton-Tempel Kote Abbott	WC @ 9:00am	Patti Kipper Yvonne Dyck
WCI follows WC	Brenda Anton-Tempel Dave MacDonald	WCI to follow WC	Patti Kipper Yvonne Dyck
WCX follows WCI	Brenda Anton-Tempel Dave MacDonald	WCX follows WCI	Patti Kipper Axton Mihial

**WC to start at 9:00 AM each day.** All land stakes will be run first followed by all water stakes.

BIRDS: Ducks, pheasants or pigeons may be used

### **ACCOMMODATIONS**

Trailer Parking and Campground:

Comfort Plus - 306 781-2810 - 12km east of Regina just off Hwy #1

Dyer Straits Campground - (306)789-2404 - 12km east of Regina on Hwy #1 at Jct #48, north service road

Hotels: Sleep Inn - 306-791-1925 - Emerald Park - tell them you're in town for the tests and they'll waive the pet fee (please confirm)

Days Inn (306) 522-3297

Regina Motel 6 (306) 565-2251

Regina Super 8 (306) 789-8833

Regina Travel Inn 1-800-465-2223

## MAP TO REGINA RETRIEVER CLUB GROUNDS

Regina  
Retriever Club  
Grounds (the  
Pit)

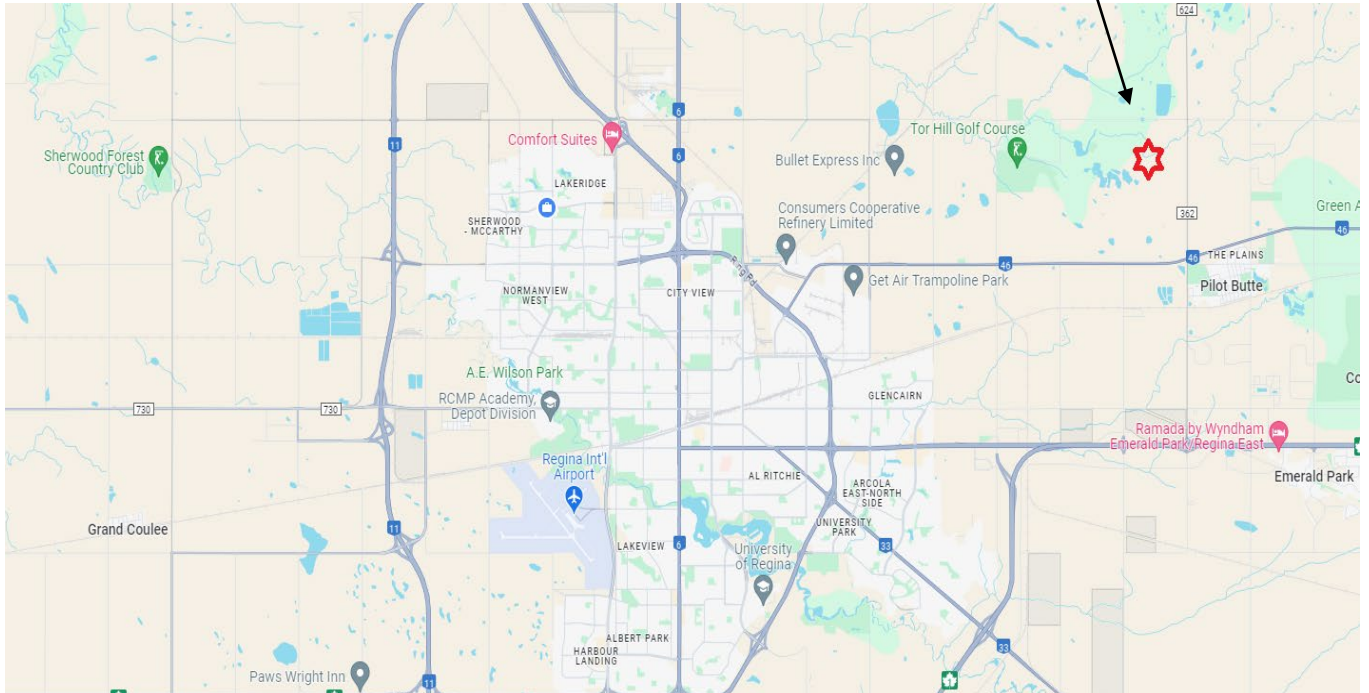

From McDonald Street (Highway 46) 4 miles (6.4 kms) past Fleet Street, turn north, past the construction site and left into the Club Pit.

If you have any questions as to the location, please contact one of the test committee members for assistance.