

Official Premium List

**Stormont, Dundas, & Glengarry Dog Association**

**Entries Close**  
**TUESDAY, JULY 30, 2013**  
**AT 8 p.m.**

**Eukanuba** 

Friday, Saturday, Sunday, Monday

**August 23, 24, 25, 26, 2013**

114<sup>th</sup>, 115<sup>th</sup>, 116<sup>th</sup>, 117<sup>th</sup>

**4 All Breed Championship Shows**

125<sup>th</sup>, 126<sup>th</sup>, 127<sup>th</sup>, 128<sup>th</sup>, 129<sup>th</sup>, 130<sup>th</sup>

**6 All Breed Obedience Trials (LIMITED ENTRY)**

29<sup>th</sup>, 30<sup>th</sup>, 31<sup>st</sup>, 32<sup>nd</sup>, 33<sup>rd</sup>, 34<sup>th</sup>

**6 All Breed Rally Trials (LIMITED ENTRY)**

**5 All Breed Agility Trials\* (Limited Entry) \*Separate Show Secretary**

Long Sault Campgrounds, Woodlands Campsite, Long Sault, ON. Canada

<http://www.stlawrenceparks.com/lsp.htm>

These Shows held under the rules of The Canadian Kennel Club (CKC) - This event held *Outdoors* - Unbenched & Unexamined

“no cover will be provided in case of inclement weather”

**All Breed Baby Puppy offered each day**

**All Breed Best Bred By – Friday Aug 23, 2013 – ONLY**

**All Breed Brace – Sunday August 25, 2013 – ONLY**

**(10) SPECIALTIES**

**Saturday, August 24, 2013**

**Borzoi** Canada  
Ottawa Valley **All Setter** Association  
Rideau **Terrier** Club - Group 4 Specialty

**Irish Setter** Club of Canada  
**Pointer** Club of Canada – National  
German **Shorthaired Pointer** Club of Canada - National  
**Vizsla** Canada (National)

**Sunday, August 25, 2013**

**Border Terrier** Club of Ontario  
Ottawa Valley **Pointing Dog** Club  
Specialty for **Miniature Schnauzer** Only - Rideau **Terrier** Club

**BOOSTERS**

**Boosters for** – ALL TERRIERS, Barbet, Borzoi, ALL POINTERS, Braque Français, Kleiner Munsterlander Vorstehund, Wire-Haired Pointing Griffon, Pointer, Pointer (GLH, GSH, GWH), Pudelpointer, Rhodesian Ridgeback, Spaniel (Blue Picardy, Brittany, French), Spinone Italiano, Weimaraner, Setters (English, Gordon, Irish and Irish Red & White), Vizsla (SM & WH), Spaniel (English Springer), Bernese Mountain Dog, Schnauzer (Standard)

**Junior Handling - SD & G - Conformation - Sunday August 25, 2013**

To comply with instructions issued by the CKC we will be unable to accept, cancel, or substitute any entry reaching our show secretary after the official closing date.

**S** stormont  
**D** undas  
**&**  
**G** lengarry  
**L**ong Sault  
**O**N



## Stormont, Dundas, & Glengarry Dog Association - Officers

(At time of Publication)

President.....Rachelle O'Meara  
Secretary.....Sandra Cummings  
Directors:.....Jodie O'Meara

Vice-President .....Candy Beauchamp  
Treasurer .....Connie Charlebois

### Show Committee (At time of Publication)

**Show Superintendent..... Jodie O'Meara, (613) 443-2262, banquise@sympatico.ca**  
Co - Show Superintendent..... Kristy Tedford      Show Chairperson: ..Jodie O'Meara  
Chief Ring Steward ..... Candy Beauchamp      Booth Rental.....Jeff Dale, jdale@trademarkmedia.ca  
RV & Trailer Parking - Jeff Dale, 613-366-2030 ext# 2000    jdale@trademarkmedia.ca

**Show Photographer - Dean Dennis Photography, 613-314-2816**

**EMAIL: deandennisphotography@gmail.com**

**No pictures may be taken for the purpose of resale at the SD & G dog show by anyone other than the official show photographer(s) without express written consent from the SD & G club.**

Veterinarian – St. Lawrence Valley Animal Hospital, 435 Pitt St., Cornwall, ON (613) 932-4094

Show Secretary - **COLMAR Show Service**, 340 Mercer St., Chatham, ON, Canada N7M 6E1

Phone: (519) 351-3147    Email: [colmar@ciaccess.com](mailto:colmar@ciaccess.com)    website: [www.colmars.com](http://www.colmars.com)

### Canadian Kennel Club

(at time of publishing)

**Head Office:** Lance Novak, Executive Director,

400 – 200 Ronson Dr., Etobicoke, ON. M9W 5Z9. (416) 675-5511

**Eastern Ontario CKC Director Zone 5 – Bob Rowbotham,**

505 Airport Rd., RR # 4, Stirling, ON K0K 3E0 – bob@rock107.ca

**Conformation Rep.....Robert Whitney,**

313 Pipeline Rd RR#2, Castleton, ON, K0K 1M0 rwhitney@xplornet.com

**Obedience Rep.....Frances Holmes**

112 Grey Stone Dr., Carp, ON KOA 1L0 frances@thetraininghall.com

**Agility Rep .....Sandra Esford**

1452 Wallbridge Loyalist Rd Belleville ON K8N 4Z5 goldencol@sympatico.ca

**Junior Handling Rep.....Kim Groves, 10 Grimes St., Brighton, ON K0K 1H0 avatarbmd@sympatico.ca**

### Catalogue Advertising

Bus Card or Quarter Page \$20.00 - Half Page \$ 30.00 - Full Page \$ 60.00 - Send camera ready materials along with a cheque payable to Stormont, Dundas, & Glengarry Dog Association by August 4, 2011, to: COLMAR Show Service, 340 Mercer St., Chatham, ON. N7M 6E1

**Booth Space** - Jeff Dale, 613-366-2030 ext# 2000    jdale@trademarkmedia.ca

All Booth Space is on a First Come First Serve Basis

**10 x 10 - \$ 245.00, 10 x 20 - \$ 280.00, 10 x 30 or 20 x 20 - \$ 315 per day**

**Electrical \$ 40.00 extra, includes 1 Table included**

We welcome all exhibitors and spectators, including persons with disabilities. If you require accommodation of a disability, please make your accommodation known to the club in advance. Please contact the Superintendent by the closing date to ensure that we can do our best to accommodate your needs.

### **BEST BRED BY EXHIBITOR – Conformation - Friday, August 23, 2013**

The Stormont, Dundas & Glengarry dog Association is pleased to offer an UNOFFICIAL CLASS COMPETITION for breeders who enter the Bred By Exhibitor Class on **Friday, August 23, 2013, ONLY.**

**This class is open only to dogs entered in the "bred by" class.** There is no additional charge for this competition. Judging in this competition will be held after each official class is completed at the breed and group level, by the regular breed judge. Each winner will be eligible to compete for Best Bred by Exhibitor in his or her respective groups. Each group winner of the Best Bred by Exhibitor will be eligible to compete for Best Bred By Exhibitor in Show. A Judge will judge best Bred by Exhibitor in Show upon completion of General Specials. A flat ribbon will be awarded at the breed level. A Rosette will be awarded to all Group winners in this competition. A trophy and rosette will be awarded to the Best Bred By Exhibitor in Show.

**Note:** Overflow camping hydro (electric) is \$50.00 and

**MUST to be pre paid** by August 15, 2013

Please forward payment to; Jodie O'Meara,

6135 Garlandside Rd., Cumberland, ON K4B 1S7

For more information contact - Jeff Dale, [jdale@trademarkmedia.ca](mailto:jdale@trademarkmedia.ca)

**Judges** - SD & G - Conformation

**Fabián Daza Almendrales** ..... Avenida 9 No. 116-20 Consultorio 626, **Bogotá, Columbia**  
**Mr. Richard Beauchamp** ..... 1241 Knollwood Dr , PMB #4, Cambria, **CA USA** 93428-3343  
**Jim Bricknell** ..... 690 Pinegrove Rd, RR 1, Roblin **.ON K0K 2W0**  
**Nicholas Debedout**..... Cra 80 No 152-25, **Bogotá, Columbia**  
**Peter Frost** .....28 Currajong Road East Hawthorn, **Australia** 3123  
**Jose Haro Haro**.....Cádiz, **Spain**  
**David Kirkland**..... 387 Holly Brook Rd., Sanford, **NC USA** 27330-6450  
**Jim Osborn** ..... 1030 Route 105 Kirks Ferry, Chelsea **QC J9B 1P3**  
**Ray Smith** .....550 Haute-Riviere Rr #2 Chateauguay **QC J6J 5W6**  
**David Swartwood** .....255 Cunningham Road Rr 2 Gananoque **ON K7G 2V4**  
**Betsy Yates**..... 1462 Sedgefield Dr., New Albany, **OH USA** 43054-9424

**Judging Assignments – Conformation** \* Denotes Group Judge

Group	Friday August 23, 2013	Saturday August 24, 2013	Sunday August 25, 2013	Monday August 26, 2013
1	Barbet, Kleiner Münsterländer Vorsteherhund, Retriever (Chesapeake Bay), Spaniel (American Water, Blue Picardy, Brittany, Clumber, Eng Cocker, Eng Springer, Field, French, Irish Water, Sussex, Welsh Springer, Spanish Water Dog, Spinone Italiano, Vizsla (SH, WH), Weimaraner <b>Jim Bricknell</b> Balance of Breeds <b>David Swartwood</b> *	Spaniel (American Water, Blue Picardy, Brittany, Clumber, Eng Cocker, Eng Springer, Field, French, Irish Water, Sussex, Welsh Springer, Spanish Water Dog, Spinone Italiano <b>Jose Haro</b> Griffon (Wire Haired Pointing), Kleiner Münsterländer Vorsteherhund, Pointer, Pointer (GLH, GWH), Pudelpointer, Retriever (Chesapeake Bay), Setter (English, Gordon, Irish, Irish R & W) <b>Betsy Yates</b> Balance of Breeds <b>F. Almendrales</b> *	Pointer, Setter (Irish) <b>N. Debedout</b> Spaniel (American Water, Blue Picardy, Brittany, Clumber, Eng Cocker, Eng Springer, Field, French, Irish Water, Sussex, Welsh Springer, Spanish Water Dog, Spinone Italiano <b>Peter Frost</b> Balance of Breeds <b>Jose Haro</b> *	Spaniel (American Water, Blue Picardy, Brittany, Clumber, Eng Cocker, Eng Springer, Field, French, Irish Water, Sussex, Welsh Springer, Spanish Water Dog, Spinone Italiano <b>N. Debedout</b> Setters (English, Gordon, Irish, Irish R & W) <b>F. Almendrales</b> Balance of Breeds <b>Peter Frost</b> *
2	<b>F. Almendrales</b>	Dachshund (MLH, MS, MWH, MLH, SS, SWH) <b>David Swartwood</b> Borzoï <b>Betsy Yates</b> Balance of Breeds <b>N. Debedout</b>	<b>Peter Frost</b>	<b>Ray Smith</b>
3	<b>F. Almendrales</b>	<b>Peter Frost</b>	<b>Jim Osborn</b>	<b>N. Debedout</b>
4	<b>Jose Haro</b>	Irish, Kerry Blue, Lakeland, Norfolk, Norwich, Schnauzer (Min), Scottish, Sealyham, Skye, SC Wheaten, Staffordshire Bull, Welsh, West Highland White <b>David Swartwood</b> Balance of Breeds <b>F. Almendrales</b> *	<b>Peter Frost</b>	<b>N. Debedout</b>
5	<b>David Kirkland</b>	<b>R. Beauchamp</b>	<b>N. Debedout</b>	<b>F. Almendrales</b>
6	<b>David Kirkland</b>	<b>R. Beauchamp</b>	<b>N. Debedout</b>	<b>Ray Smith</b>
7	<b>Jim Bricknell</b>	<b>N. Debedout</b>	<b>F. Almendrales</b>	<b>Peter Frost</b>
BIS BPIS	<b>F. Almendrales</b> & Best Bred By Ex	<b>N. Debedout</b>	<b>Peter Frost</b> & Best Brace	<b>Ray Smith</b>

## Obedience & Rally Judges

Susan des Cotes..... Orangeville, ON

Diana E Mackenzie ..... 119 Buckingham Dr., Hamilton, ON L9C 2G8

### OBEDIENCE (LIMITED ENTRY) –Assignments

Rally / Obedience entries limited to 420 minutes per day/per judge – Trials may close earlier

Class	Trial # 1 Aug 23, 2013	Trial # 2 Aug 23, 2013	Trial # 3 Aug 24, 2013	Trial # 4 Aug 24, 2013	Trial # 5 Aug 25, 2013	Trial # 6 Aug 25, 2013
All Classes	<b>Susan des Cotes</b>	<b>Diana Mackenzie</b>	<b>Susan des Cotes</b>	<b>Diana Mackenzie</b>	<b>Susan des Cotes</b>	<b>Diana Mackenzie</b>

### RALLY (LIMITED ENTRY) - Assignments

Class	Trial # 1 Aug 23, 2013	Trial # 2 Aug 23, 2013	Trial # 3 Aug 24, 2013	Trial # 4 Aug 24, 2013	Trial # 5 Aug 25, 2013	Trial # 6 Aug 25, 2013
All Classes	<b>Diana Mackenzie</b>	<b>Susan des Cotes</b>	<b>Diana Mackenzie</b>	<b>Susan des Cotes</b>	<b>Diana Mackenzie</b>	<b>Susan des Cotes</b>

Rally / Obedience entries limited to 420 minutes per day/per judge – Trials may close earlier

### US Obedience Exhibitors

Any dog holding an AKC - CD Title is not eligible for Novice A, but may enter Novice B.

Any dog holding an AKC - CDX Title is not eligible for Open A, but may enter Open B.

### CLASSES – OBEDIENCE

The following Official CKC Classes will be provided:

Pre – Novice, Novice "A", & "B", "C", Intermediate Novice, Open "A", Open "B", and Utility A & B.

### 6.9 MOVING UP – OBEDIENCE CKC Rules And Regulations (Effective January 01, 2012)

6.9.1 A dog that is registered in the records of the CKC or has a PEN, and ERN, or a MCN and has fulfilled the requirements for a title in accordance with these rules but at the time of the closing of entries for the trial has not received confirmation of the title may be moved to the next level of competition providing the request is submitted to the trial secretary on the appropriate move-up form by the owner or handler a minimum of one hour before the opening of the first trial on that day, schedule permitting.

6.9.2 When one or more trials are held on the same day in the same venue, the request for moving the dog up must be made a minimum of one hour prior to the scheduled start of the trial for which the dog is being moved up to, schedule permitting.

6.9.3 In the case of limited entry trial, move ups are permitted and the club is exempt from Section 4.3.4.



6.9.5 If it is established by the CKC that a dog moved up to the next level has not completed the requirements for the lower level before moving up, then all qualifying ribbons and/or awards earned by the dog incorrectly entered shall be forfeited and cancelled by the CKC and the owner may be subject to disciplinary action.

6.9.6 In order for a dog to be eligible to move up, the dog must be individually registered in the CKC or have a Performance Event Number (PEN), an Event Registration Number (ERN) or a Miscellaneous Certification Number (MCN) before entries close. The addition of a CKC number after close of entries does not make the dog eligible and will result in referral to the Discipline Committee.

6.9.7 Exhibitors incorrectly entered in the "A" class are permitted to move the dog to the corresponding "B" class up to one hour before the start of the trial.

### PERFORMANCE EVENT NUMBER (PEN)

Effective Jan 01, 2002, a Performance Event Number (PEN), allows an unregistrable dog of a CKC recognized breed to participate in those competitive events that are appropriate for the breed. Those events are as follows: Obedience, Tracking, Herding, Draft Dogs, Agility, Lure Coursing, Earthdog Tests, Hunt Tests, Working Certificate Tests, and Pointing Field Dog Tests. A Dog that is eligible for a PEN may not be entered as a listed dog. Dogs may only enter events after a PEN has been issued to that dog. This restriction shall also apply to dogs with ILP numbers. Unregistrable Dog means, a dog of a recognized CKC breed that cannot be registered because of unknown parentage or the unavailability of its registration papers.

OFFICIAL CANADIAN KENNEL CLUB FORM		<b>SD &amp; G Dog Association - AGILITY</b>	
			
<b>ENTRIES TAKEN AFTER MAY 31, 2013</b>			
<b>Dates</b>	<b>Agility</b>	Entry Fee \$ 25.00 CDN or USD per run All Trials (10 run Pack) \$200.00 Weekend Package(Sat & Sun 4 Trials, 8 runs) - \$ 160.00 Listing Fee: \$ 9.70 CDN or USD <i>per run</i> Limit 300 per day (includes all Trials) <b>Agility Entries Close: Tuesday August 8, 2013</b> at 8:00 pm or when limited has been reached	
Friday August 23, 2013	<input type="checkbox"/> Trial 1		
Saturday, August 24, 2013	<input type="checkbox"/> Trial 2 <input type="checkbox"/> Trial 3		
Sunday, August 25, 2013	<input type="checkbox"/> Trial 4 <input type="checkbox"/> Trial 5		
<b>Please Make ALL Cheques Payable to SD &amp; G Dog Association</b>			
Please Print or Type CLEARLY		<b>TOTAL FEES FOR THIS ENTRY: \$</b>	
<b>REGULAR STANDARD</b>			
<input type="checkbox"/> Novice A	<input type="checkbox"/> Novice B	<input type="checkbox"/> Intermediate	<input type="checkbox"/> Excellent A <input type="checkbox"/> Excellent B
<b>REGULAR JWW</b>			
<input type="checkbox"/> Novice A	<input type="checkbox"/> Novice B	<input type="checkbox"/> Intermediate	<input type="checkbox"/> Excellent A <input type="checkbox"/> Excellent B
<b>SELECTED STANDARD</b>			
<input type="checkbox"/> Novice		<input type="checkbox"/> Intermediate	<input type="checkbox"/> Excellent A <input type="checkbox"/> Excellent B
<b>SELECTED JWW</b>			
<input type="checkbox"/> Novice		<input type="checkbox"/> Intermediate	<input type="checkbox"/> Excellent A <input type="checkbox"/> Excellent B
<b>VETERANS STANDARD</b>			
<input type="checkbox"/> Novice		<input type="checkbox"/> Intermediate	<input type="checkbox"/> Excellent A <input type="checkbox"/> Excellent B
<b>VETERANS JWW</b>			
<input type="checkbox"/> Novice		<input type="checkbox"/> Intermediate	<input type="checkbox"/> Excellent A <input type="checkbox"/> Excellent B
<b>JUMP HEIGHT</b>		<input type="checkbox"/> 4 "	<input type="checkbox"/> 8 " <input type="checkbox"/> 12" <input type="checkbox"/> 16" <input type="checkbox"/> 20" <input type="checkbox"/> 24"
<b>BREED</b>		Height at Withers -	
<b>CALL NAME</b>		<b>SEX:</b> <input type="checkbox"/> MALE OR <input type="checkbox"/> FEMALE	
<b>REGISTERED NAME OF DOG</b>			
Check One & Enter Number Here <input type="checkbox"/> CKC Reg # <input type="checkbox"/> CKC PEN # <input type="checkbox"/> CKC ERN # <input type="checkbox"/> CKC Misc Cert.# <input type="checkbox"/> LISTED		<b>Date Of Birth:</b> Please Circle Month Jan Feb Mar Apr May June July Aug Sept Oct Nov Dec Day _____ Year _____.	<b>PLACE OF BIRTH?</b> <input type="checkbox"/> Canada <input type="checkbox"/> Elsewhere
BREEDER(S)			
SIRE			
DAM			
REGISTERED OWNER(S)			
OWNER'S ADDRESS			
CITY	PROV/STATE	POSTAL CODE/ZIP	
NAME OF OWNERS AGENT (IF ANY) AT THE SHOW			
AGENT'S ADDRESS			
CITY	PROV/STATE	POSTAL CODE/ZIP	
<b>Mail ID to:</b> <input type="checkbox"/> OWNER Or <input type="checkbox"/> AGENT			
<small>I certify that I am the registered Owner(s) of the dog or that I am the authorized agent of the Owner(s) whose name(s) I have entered above and accept full responsibility for all statements made in this entry. In Consideration of the acceptance of this entry, I (we) agree to be bound by the rules and regulations of the Canadian Kennel Club and any additional rules and regulations appearing in the premium list. Also, by signing this form I certify that I will not hold the Show giving Club, it's members, Directors, Employees, or Agents, liable in the event of any accident or misfortune however caused.</small>			
Signature of Agent or Owner		Phone Number	Email address

**Mail To: Gail Giles, 1523 Lazier Rd., RR#2, Shannonville, ON K0K 3A0**

**SD & G ALL BREED AGILITY TRIALS - - AUGUST 23, 24, 25, 2013**

Entries Open May 31, 2013 8:00 am - Agility Entries Close: Aug 8/13 at 8:00 pm,  
or when the limit of 300 runs per day has been met

**Agility Trial Secretary: Gail Giles**

1523 Lazier Rd., RR#2, Shannonville, ON K0K 3A0

**For a Complete Premium List for these trials visit the  
Belleville & District Kennel Club Website at <http://bellevilledogclub.com/>**

***5 Standard Classes and 5 JWW Classes over the weekend***

Outdoors, on grass surface, ring size 110' x 110'  
No cover provided in case of inclement weather

<b>Agility Judges and Assignments</b>		
<b>Friday, August 23</b>	<b>Trial 1 All Classes</b>	<b>Sandra Esford, Belleville ON</b>
<b>Saturday, August 24</b>	<b>Trial 2 &amp; 3 All Classes</b>	<b>Marie Josee Thuot, Sherbrooke QC</b>
<b>Sunday, August 25</b>	<b>Trial 4 &amp; 5 All Classes</b>	<b>Sharon Dunsmore, Pickering ON</b>

**Agility Entry Fees (Canadian Funds or U.S. Funds)**

Entry of each dog per run ..... \$ 25.00

All Trials Package of 10 run ..... \$ 200.00

Weekend Package(Sat &Sun all 4 Trials, 8 runs)..... \$ 160.00

***Same day entry \$30.00 available only if limit not reached***

Listing fee, per dog per trial ..... \$ 9.70\*\*

*All fees include HST and are payable in Canadian Funds.*

*Post-dated cheque will not be accepted.*

*\*\*A listing fee is required for all dogs entered, **who do not have** an individual CKC Registration number, an E.R.N. number or a P.E.N. Number*

*Make Cheque or Money Order payable to*

***Stormont, Dundas & Glengarry Dog Association (SG&D Dog Association)***

**Mail Agility Entries To: *Agility Trial Secretary, Gail Giles,***

1523 Lazier Rd., RR#2, Shannonville, ON K0K 3A0

***Entryline will also take entries for this trial***

**Agility Order of Classes**

Friday and Saturday, (Tall to Small) Ex Std. Trial 1, Ex Std Trial 2, Intermediate Std Trial 1, Intermediate Std Trial 2, Novice Std Trial 1, Novice Std Trial 2, Ex JWW Trial 1, Ex JWW Trial 2, Intermediate JWW Trial 1, Intermediate JWW Trial 2, Novice JWW Trial 1, Novice JWW Trial 2

Sunday, (Small to Tall)

Ex Std. Trial 3, Ex Std Trial 4, Intermediate Std Trial 3, Intermediate Std Trial 4, Novice Std Trial 3, Novice Std Trial 4, Ex JWW Trial 3, Ex JWW Trial 4, Intermediate JWW Trial 3, Intermediate JWW Trial 4, Novice JWW Trial 3, Novice JWW Trial 4

OFFICIAL CANADIAN KENNEL CLUB FORM		Armband #	
<b>SD&amp;G - CONFORMATION</b>			
<input type="checkbox"/> Friday, August 23, 2013		<input type="checkbox"/> Sunday, August 25, 2013	
<input type="checkbox"/> Saturday, August 24, 2013		<input type="checkbox"/> Monday, August 26, 2013	
<b>Obedience</b>	<b>Dates</b>	<b>Rally</b>	
<input type="checkbox"/> Trial 1 <input type="checkbox"/> Trial 2	<b>Friday August 23, 2013</b>	<input type="checkbox"/> Trial 1 <input type="checkbox"/> Trial 2	
<input type="checkbox"/> Trial 3 <input type="checkbox"/> Trial 4	<b>Saturday, August 24, 2013</b>	<input type="checkbox"/> Trial 3 <input type="checkbox"/> Trial 4	
<input type="checkbox"/> Trial 5 <input type="checkbox"/> Trial 6	<b>Sunday, August 25, 2013</b>	<input type="checkbox"/> Trial 5 <input type="checkbox"/> Trial 6	
		<b>Price List</b>	
		Entry Fee: \$ 29.00 CDN/USD	
		Baby Puppy Entry Fee: \$ 25.00 CDN/USD	
		Listing Fee: \$ 9.70 CDN or USD	
		Other Fees: Sweepstakes, Exhibition, & Non – Regular - \$ 15.00 CDN or USD	
<input type="checkbox"/> Pre Paid and Pre Ordered Catalogue \$ 10.00 CDN/USD    TOTAL FEES FOR THIS ENTRY: \$			
Make <b>Cheques Payable</b> to SD & G Dog Association <b>Entries Close: Tuesday JULY 30, 2013 at 8 pm</b>			
<b>Conformation</b>	<b>Rally (Limited Entry)</b>	<b>Obedience (Limited Entry)</b>	
<input type="checkbox"/> Baby Puppy (3-6 mos) <input type="checkbox"/> Bred By Exhibitor	<b>Jump Heights</b>	<input type="checkbox"/> Pre - Novice <input type="checkbox"/> Open A <input type="checkbox"/> Utility A	
<input type="checkbox"/> Jr. Puppy (6 – 9 mos) <input type="checkbox"/> Open	<input type="checkbox"/> 6" <input type="checkbox"/> 8" <input type="checkbox"/> 12" <input type="checkbox"/> 16"	<input type="checkbox"/> Novice A <input type="checkbox"/> Open B <input type="checkbox"/> Utility B	
<input type="checkbox"/> Sr. Puppy (9 – 12 mos) <input type="checkbox"/> Specials Only	<input type="checkbox"/> Novice A <input type="checkbox"/> Novice B	<input type="checkbox"/> Novice B <input type="checkbox"/> Exhibition	
<input type="checkbox"/> 12 – 18 month <input type="checkbox"/> Brace (Sun Only)	<input type="checkbox"/> Advanced A <input type="checkbox"/> Advanced B	<input type="checkbox"/> Novice C	
<input type="checkbox"/> Canadian Bred <input type="checkbox"/> Exhibition	<input type="checkbox"/> Excellent A <input type="checkbox"/> Excellent B	<input type="checkbox"/> Intermediate Novice	
		Jump Heights <b>Height      Width</b>	
<b>BREED</b>		<b>SEX:</b> <input type="checkbox"/> MALE OR <input type="checkbox"/> FEMALE	
<b>REGISTERED NAME OF DOG</b>			
Check One & Enter Number Here		<b>IS THIS A PUPPY?</b>	
<input type="checkbox"/> CKC Reg #		<input type="checkbox"/> Yes or <input type="checkbox"/> No	
<input type="checkbox"/> CKC PEN #		<b>PLACE OF BIRTH?</b>	
<input type="checkbox"/> CKC ERN #			<input type="checkbox"/> Canada
<input type="checkbox"/> CKC Misc Cert.#			<input type="checkbox"/> Elsewhere
<input type="checkbox"/> LISTED			
<b>BREEDER(S)</b>			
<b>SIRE</b>			
<b>DAM</b>			
<b>REGISTERED OWNER(S)</b>			
<b>OWNER'S ADDRESS</b>			
<b>CITY</b>	<b>PROV/STATE</b>	<b>POSTAL CODE/ZIP</b>	
<b>NAME OF OWNERS AGENT (IF ANY) AT THE SHOW</b>			
<b>AGENT'S ADDRESS</b>			
<b>CITY</b>	<b>PROV/STATE</b>	<b>POSTAL CODE/ZIP</b>	
<b>Mail ID to:</b> <input type="checkbox"/> OWNER Or <input type="checkbox"/> AGENT			
I certify that I am the registered Owner(s) of the dog or that I am the authorized agent of the Owner(s) whose name(s) I have entered above and accept full responsibility for all statements made in this entry. In Consideration of the acceptance of this entry, I (we) agree to be bound by the rules and regulations of the Canadian Kennel Club and any additional rules and regulations appearing in the premium list. Also, by signing this form I certify that I will not hold the Show giving Club, it's members, Directors, Employees, or Agents, liable in the event of any accident or misfortune however caused.			
Signature of Agent or Owner		Phone Number	
a 15% + HST, charge applies on Credit Card Charges		Email address	
<input type="checkbox"/> VISA <input type="checkbox"/> MasterCard <input type="checkbox"/> AMEX		<b>Expiry Date:</b> Month >      Year >	
<b>Card Number:</b> --      --      --      --			
<b>Name of Card Holder:</b>			
<b>Fax #</b>	<b>Mail To:</b> COLMAR Show Service, 340 Mercer St, Chatham, ON, Canada N7M 6E1		
<b>519-351-3223</b>	<b>Web Site:</b> www.colmars.com		

All Fees are payable at time of entry. No entry will be processed or entered in this show without payment.  
Listing fees are applicable for all dogs entered in the shows that do not have an individual CKC Reg. Number or an ERN number.

## **SANCTION MATCH** - Friday August 23, 2013 after Best in Show

For more information: Canadian Association of Parson Russell Terrier Fanciers,  
Susan Crawford, scrawford@gmch.fergus.net

### **Entry Information**

\*\*\* All fees include HST \*\*\*\*\*

	Canadian Funds	US Funds
**Entry Fee, of each dog, per entry per show/day .....	\$ 29.00	\$ 29.00
Listing Fee – per dog, per show/day .....	\$ 9.70	\$ 9.70
All Non – Regular & Unofficial Classes & All Breed Brace.....	\$ 15.00	\$ 15.00
Exhibition Only.....	\$ 15.00	\$ 15.00
Specialty Brace.....	\$ 15.00	\$ 15.00
Specialty Parades (Must be in Exhibition or one Regular Classes).....	N/C	N/C
Sweepstakes .....	\$ 15.00	\$ 15.00
Pre-Ordered & Prepaid Catalogue .....	\$ 10.00	\$ 10.00

All Fees are payable at time of entry. No entry will be processed or entered in this show without payment.

Listing fees are applicable for all dogs entered in the shows that do not have an individual CKC Reg. Number or an ERN number.

Tendering of an NSF cheque in payment of entry fees shall be considered non-payment of fees (8.8.2).

**\*\*A service charge of \$35.00 CDN OR US FUNDS will be applied to all NSF cheques.\*\***

### **Make ALL cheques payable to: Stormont, Dundas, & Glengarry Dog Association**

**and MAIL TO: COLMAR Show Service, 340 Mercer St., Chatham, ON, Canada N7M 6E1**

**With the uncertainty and unreliability of the postal system and email, it is advisable to send your entry via priority post, registered mail, or Entrylite. It is your responsibility to verify receipt of any electronic entries or email correspondence. We cannot be held responsible for mail lost in transit or misdirected electronically or physically.**

### **Fax Entries - VISA - MasterCard & American Express - Entries**

You may fax your entry directly to us at 519-351-3223. Also you may charge your entries to your Visa/MasterCard/AMEX. Include the card number, expiry date, and name on the card, on the entry form, or a separate piece of paper. A NON - REFUNDABLE administration fee of 15% plus HST will be charged.

**All Credit Card Charges Will Be Made in Canadian Funds.**

**ANY REFUNDS WILL BE MADE IN CANADIAN FUNDS FROM THE SHOW GIVING CLUB.**

### **General Entry Information**

- LIMITED NUMBER OF CATALOGUES WILL BE AVAILABLE AT THE SHOW FOR \$ 15.00 CDN/USD.
- To comply with instructions issued by the Canadian Kennel Club we will be unable to accept, cancel, or substitute an entry reaching our Show Secretary after the closing date, except for moving class dogs to Specials.
- All entry confirmations and Judging Schedules will be mailed as soon as possible after entries close.
- It is your responsibility to verify the receipt of any electronic entries prior to the advertised closing date. A valid means of payment must accompany all entries.
- In the event that the dog is absent, excused by a Veterinarian or Judge, disqualified, or barred from competition by action of the bench Committee, no entry fees will be refunded.
- There is no refund for duplicate entries. All efforts will be made to find all duplicate entries. However, if the entry has been processed and appears in the official catalogue, no refund will be made.
- The Stormont, Dundas, & Glengarry Dog Association & COLMAR Show Service will not be responsible for cash sent through the mail.
- Overpayments will be applied to the General Trophy fund. Therefore, please calculate fees carefully.
- No entry will be accepted unless accompanied by full entry fees. NO post-dated cheques.
- Incomplete entries will be returned. Handlers and agents please note the full address of all owners must be filled in. **Refunds will not be given for anyone double entering the same dog.**
- Exhibitors must abide by errors made in entering their dogs regardless of how or by whom the entries were made.
- Only dogs eligible for registration with CKC may enter this show and trial.
- Bitches, when in season**, are not permitted to compete in the Trial, however, entry fees will be refunded, providing a veterinarian's certificate stating that the bitch was in season within the 10 day period preceding the trial, is submitted to the Trial Secretary, on or before the date of the trial.

**The Stormont, Dundas, & Glengarry Dog Association reserves the right to refuse any entries, subject to CKC rules.**

### **All Emails & Faxes**

It will be the responsibility of the exhibitor to ensure that any electronic submission, either email or facsimile, or any document transmitted electronically reaches the proper authority or recipient within the times and limits as regulated for each document in the CKC Rules & Regulations.

Sent fax receipts and / or copies of sent emails will not be taken as evidence of receipt by the recipients.



### **ENTRYLINE - Dog Show Entry Service**

PHONE: 1-800-293-2935 FAX: 1-519-754-0796 www.theentryline.com (a Secured Site)

**" The Dog Show Entry Service that lets you focus on winning"**

**Important: Entries taken until: 6:00 pm on day of closing** This is a privately owned business and charges a fee for this service



## BOOSTERS

**AIREDALE Terrier Club of Canada**  
**Sat Aug 24, 2013** Judge: **Fabián Daza Almendrales**  
Through the generosity of friends and members Airedale Terrier Club of Canada is pleased to offer the following awards:  
BOB

**Club Barbet Canada**  
**Saturday, August 24, 2013**  
Judge: **Fabián Almendrales**  
Through the generosity of friends and the members of Club Barbet Canada the following prizes will be offered.  
BOB, BOS, BPIB, BOW, WB & WD

**Bernese Mountain Dog Club of Canada**  
**Saturday, August 24, 2013** Judge: **Peter Frost**  
Through the generosity of friends and the members of Bernese Mountain Dog Club of Canada the following prizes will be offered.  
BOB, BOS, BPIB, BOW, WB & WD

**Borzoi Canada**  
**Sunday, August 25, 2013** Judge: **Peter Frost**  
Through the generosity of friends and the members of Borzoi Canada the following prizes will be offered.  
BOB, BOS, BPIB, BOW, WB & WD

**Border Terrier Club of Ontario**  
**Saturday, Aug 24/13** –Judge: **Peter Frost**  
Through the generosity of friends and members The Border Terrier Club of Ontario is pleased to offer the following prizes  
BOB, BOS, BPIB, BOW, WB, & WD.

**Cairn Terrier Club of Canada – ON E Region**  
**Saturday, Aug 24/13** –Judge: **Fabián Almendrales**  
Through the generosity of friends and members The Cairn Terrier Club of Canada- OER is pleased to offer the following prizes  
BOB, BOS, BPIB, BOW, WB, & WD.

**German Shorthaired Pointer Club of Canada**  
**Sunday, Aug 25/13** –Judge: **Jose Haro**  
Through the generosity of friends and members The German Shorthaired Pointer Club of Canada is pleased to offer the following prizes  
BOB, BOS, BPIB, BOW, WB, & WD.

**Irish Setter Club of Canada**  
**Sunday, Aug 25/13** –Judge: **Nicholas Debedout**  
All Rebate fees from this booster will be applied to the Club Rescue Fund

**Std Schnauzer Club of Canada**  
**Saturday, August 24, 2013** Judge: **Peter Frost**  
Through the generosity of friends and members Std Schnauzer Club of Canada is pleased to offer the following awards:  
BOB, BOS, BPIB, BOW, WB, WD, RWD & RWB  
High in Class for both Rally Trials on Sunday August 25  
**High in Trial for both Obedience Trials on Sunday August 25**

**Ottawa Valley All Setter Association**  
**Sunday, August 25, 2013**

Setters (Irish)  
Judge: **Nicholas Debedout**

Setters (English, Gordon, Irish Red & White)  
Judge: **Jose Haro**  
In lieu of prizes, the Ottawa Valley All Setter Association will be donating a portion of the rebate received to a charity of the club's choice..

**Canadian Association of Parson Russell Terrier Fanciers**  
**Saturday, August 24, 2013**  
Judge: **Fabián Almendrales**  
Through the generosity of friends and members Canadian Association of Parson Russell Terrier Fanciers is pleased to offer the following prizes  
BOB, BOS, BPIB, BOW, WB, & WD..

**Ottawa Valley Pointing Dog Club**  
(All Pointing Breeds)  
**Saturday, Aug 24/13**

Braque Français, Pointer (GSH), Vizsla (SM & WH), Weimaraner  
Judge: **Fabián Almendrales**

Kleiner Munsterlander Vorstehund, Wire-Haired Pointing Griffon, Pointer, Pointer (GLH, GWH), Pudelpointer, Setter (Irish, English, Gordon, Irish R & W)  
Judge: **Betsy Yates**

Spaniel (Blue Picardy, Brittany, French), Spinone Italiano,  
Judge: **Jose Haro**  
In lieu of prizes, the Ottawa Valley Pointing Dog Club will be donating a portion of the rebate received to a charity of the club's choice

**Pointer Club of Canada**  
**Sunday, Aug 25/13** –Judge: **Nicholas Debedout**  
Through the generosity of friends and members The Pointer Club of Canada is pleased to offer the following prizes  
BOB, BOS, BPIB, BOW, WB, & WD.

**The Rhodesian Ridgeback Club of EASTERN Canada**  
**Saturday, Aug 24/13** Judge: **Nicholas Debedout**  
Through the generosity of friends and members The Rhodesian Ridgeback Club of Canada is pleased to offer keeper trophies for the following awards,  
BOB, BOS, BPIB, BOW, WB, WD  
High Qualifying Score in Class in the Rally Trials on Saturday August 24  
Highest Qualifying in Trial in Obedience Trials on Saturday August 24

**Rideau Terrier Club – All Terriers**  
**Sunday, August 25, 2013** Judge: **Peter Frost**  
Through the generosity of friends and members the Rideau Terrier Club is pleased to offer the following awards:  
Group 1<sup>st</sup>, 2<sup>nd</sup>, 3<sup>rd</sup>, 4<sup>th</sup> & BPIG.

### Legend of Abbreviations

**BB** = Best of Breed, **BOS** = Best Of Opposite Sex, **WD** = Winners Dog, **WB** = Winners Bitch, **BW** = Best of Winners, **BP** = Best Puppy In Breed & **HQS** = Highest Qualifying Score, The Stormont, Dundas & Glengarry Dog Association is pleased to offer rosettes for Best Of Breed, Best Of Opposite Sex, Winners Dog, Winners Bitch, Best of Winners, Best Puppy In Breed The Clubs have offered to support the entry in their breed

**Eukanuba** 

OFFICIAL CANADIAN KENNEL CLUB FORM		<b>SD&amp;G - CONFORMATION</b>			Armband #
<input type="checkbox"/> Friday, August 23, 2013		<input type="checkbox"/> Sunday, August 25, 2013			
<input type="checkbox"/> Saturday, August 24, 2013		<input type="checkbox"/> Monday, August 26, 2013			
<b>Obedience</b>	<b>Dates</b>	<b>Rally</b>	<b>Price List</b>		
<input type="checkbox"/> Trial 1 <input type="checkbox"/> Trial 2	<b>Friday August 23, 2013</b>	<input type="checkbox"/> Trial 1 <input type="checkbox"/> Trial 2	Entry Fee: \$ 29.00 CDN/USD		
<input type="checkbox"/> Trial 3 <input type="checkbox"/> Trial 4	<b>Saturday, August 24, 2013</b>	<input type="checkbox"/> Trial 3 <input type="checkbox"/> Trial 4	Baby Puppy Entry Fee: \$ 25.00 CDN/USD		
<input type="checkbox"/> Trial 5 <input type="checkbox"/> Trial 6	<b>Sunday, August 25, 2013</b>	<input type="checkbox"/> Trial 5 <input type="checkbox"/> Trial 6	Listing Fee: \$ 9.70 CDN or USD		
			Other Fees: Sweepstakes, Exhibition, & Non - Regular - \$ 15.00 CDN or USD		
<input type="checkbox"/> Pre Paid and Pre Ordered Catalogue \$ 10.00 CDN/USD    TOTAL FEES FOR THIS ENTRY: \$					
Make <b>Cheques Payable</b> to SD & G Dog Association <b>Entries Close: Tuesday JULY 30, 2013 at 8 pm</b>					
<b>Conformation</b>		<b>Rally (Limited Entry)</b>		<b>Obedience (Limited Entry)</b>	
<input type="checkbox"/> Baby Puppy (3-6 mos) <input type="checkbox"/> Bred By Exhibitor		<b>Jump Heights</b>		<input type="checkbox"/> Pre - Novice <input type="checkbox"/> Open A <input type="checkbox"/> Utility A	
<input type="checkbox"/> Jr. Puppy (6 - 9 mos) <input type="checkbox"/> Open		<input type="checkbox"/> 6" <input type="checkbox"/> 8" <input type="checkbox"/> 12" <input type="checkbox"/> 16"		<input type="checkbox"/> Novice A <input type="checkbox"/> Open B <input type="checkbox"/> Utility B	
<input type="checkbox"/> Sr. Puppy (9 - 12 mos) <input type="checkbox"/> Specials Only		<input type="checkbox"/> Novice A <input type="checkbox"/> Novice B		<input type="checkbox"/> Novice B <input type="checkbox"/> Exhibition	
<input type="checkbox"/> 12 - 18 month <input type="checkbox"/> Brace (Sun Only)		<input type="checkbox"/> Advanced A <input type="checkbox"/> Advanced B		Jump Heights	
<input type="checkbox"/> Canadian Bred <input type="checkbox"/> Exhibition		<input type="checkbox"/> Excellent A <input type="checkbox"/> Excellent B		Height    Width	
		<input type="checkbox"/> Intermediate Novice			
<b>BREED</b>				SEX: <input type="checkbox"/> MALE OR <input type="checkbox"/> FEMALE	
REGISTERED					
<b>NAME OF DOG</b>					
Check One & Enter Number Here			<b>Date Of Birth:</b> Please Circle Month		<b>IS THIS A PUPPY?</b>
<input type="checkbox"/> CKC Reg #			Jan   Feb   Mar   Apr   May   June		<input type="checkbox"/> Yes or <input type="checkbox"/> No
<input type="checkbox"/> CKC PEN #			July   Aug   Sept   Oct   Nov   Dec		<b>PLACE OF BIRTH?</b>
<input type="checkbox"/> CKC ERN #			Day _____ Year _____		<input type="checkbox"/> Canada
<input type="checkbox"/> CKC Misc Cert.#					<input type="checkbox"/> Elsewhere
<input type="checkbox"/> LISTED					
<b>BREEDER(S)</b>					
<b>SIRE</b>					
<b>DAM</b>					
<b>REGISTERED OWNER(S)</b>					
<b>OWNER'S ADDRESS</b>					
<b>CITY</b>		<b>PROV/STATE</b>		<b>POSTAL CODE/ZIP</b>	
<b>NAME OF OWNERS AGENT (IF ANY) AT THE SHOW</b>					
<b>AGENT'S ADDRESS</b>					
<b>CITY</b>		<b>PROV/STATE</b>		<b>POSTAL CODE/ZIP</b>	
<b>Mail ID to:</b> <input type="checkbox"/> OWNER Or <input type="checkbox"/> AGENT					
I certify that I am the registered Owner(s) of the dog or that I am the authorized agent of the Owner(s) whose name(s) I have entered above and accept full responsibility for all statements made in this entry. In Consideration of the acceptance of this entry, I (we) agree to be bound by the rules and regulations of the Canadian Kennel Club and any additional rules and regulations appearing in the premium list. Also, by signing this form I certify that I will not hold the Show giving Club, it's members, Directors, Employees, or Agents, liable in the event of any accident or misfortune however caused.					
Signature of Agent or Owner _____					Phone Number _____
a 15% + HST, charge applies on Credit Card Charges					Email address _____
<input type="checkbox"/> VISA <input type="checkbox"/> MasterCard <input type="checkbox"/> AMEX		<b>Expiry Date:</b> Month > _____ Year > _____			
<b>Card Number:</b> _____ -- _____ -- _____ -- _____					
<b>Name of Card Holder:</b> _____					
<b>Fax #</b>		<b>Mail To:</b> COLMAR Show Service, 340 Mercer St, Chatham, ON, Canada N7M 6E1			
<b>519-351-3223</b>		<b>Web Site:</b> www.colmars.com			

All Fees are payable at time of entry. No entry will be processed or entered in this show without payment.  
Listing fees are applicable for all dogs entered in the shows that do not have an individual CKC Reg. Number or an ERN number.

### EVENT REGISTRATION NUMBER (ERN)

Effective Jan 1/92, all dogs that are foreign born and foreign owned and enter Canada for the sole purpose of entering CKC events will no longer require a CKC registration number, but will require an Event Registration Number (ERN). The ERN number MUST be applied for within 30 days of the first day of entering a CKC event. For further information, contact: **The Canadian Kennel Club**

Phone (416) 675-5511 FAX (416) 675-6506 HOURS: 9:00 a.m. – 5:00 p.m.

### GENERAL INFORMATION

#### **CKC Conformation Rules & Regulations 12.2.2 - PUPPIES 3-6 Months** (January 1, 2007)

- a) Dogs 3 months of age and under 6 months of age on the day of the show may be entered in Exhibition Only, providing that the owner of the puppies has also entered a dog in one of the regular official classes.  
b) Puppies in this category may not compete in any official, unofficial or non-regular classes including parades.

**COLMAR Note: Listing Fees do not apply & need not be paid for "Exhibition Only" entries.**

- ◆ Limited number of catalogues will be available at the show. (Pre-ordering is highly recommended.)
- ◆ The show precincts **30 feet from any ring or building housing show executives.**
- ◆ **"No Show - All Breed or Specialty, Event, Performance Event, or Best in Show Judging, shall be delayed for any Exhibitor who has a conflict in another ring or event. All exhibitors are expected to have alternative arrangements made for any possible conflict."**
- ◆ The Show Superintendent has the authority to ask exhibitors to move or take down any crates and private exercise pens, etc. Failure to do so when requested could result in disciplinary action.
- ◆ Exhibitors are requested to keep their grooming and crating areas clean and tidy. If space is at a premium, exhibitors must remove exercise pens if requested by the Show Superintendent or designate.
- ◆ Dogs not entered in these shows will NOT be allowed within the precincts of the show & trial.
- ◆ The Show Superintendent will be in full charge of the show, governed by CKC rules.
- ◆ If, because of riot, civil disturbance, or other acts beyond the controls of the management, it is impossible to open or complete the show or trial, no refund of Entry Fees will be made.
- ◆ It shall be the duty and obligation of the show-giving club to ensure that a judge or any show committee members are not subjected to any indignities. The Conformation Show Committee shall promptly report to the CKC any infringement of this regulation, and the Discipline Committee will have the authority to take such action as it deems fit on receipt of a report indicating that this has occurred.
- ◆ The COLMAR Show Service & the Stormont, Dundas, & Glengarry Dog Association will use care and diligence for the welfare of all dogs, exhibitors and spectators, but will not be responsible for, nor assume any liability in the event of accident or misfortunes, however caused.
- ◆ Dogs need only to arrive 15 minutes before scheduled judging time and will be excused from each show when not required for further judging. Waiting for dogs will not be possible and handlers with several breeds must arrange for alternate handlers if judging times for their breeds conflict.
- ◆ COLMAR Show Service will only collect and utilize data and information that you provide us, and only for the purposes of the service we provide exhibitors entering a CKC (Canadian Kennel Club) event, and the subsequent documents generated for this event, and required by the CKC. The type and accuracy of the information is solely contingent upon what you voluntarily provide to us. We will not use or disclose personal information for the purposes other than those for which it was collected, except with consent or as required by law. Personal information will not be retained longer than needed for the specified purposes.

### SD & G Junior Handling Conformation

All Junior Handling Classes offered - **Sunday, August 25, 2013 Judge: TBA**

All Juniors should register with the Show Secretary one hour before competition. Stormont, Dundas & Glengarry Dog Association is pleased to offer Flats for 1st to 4th in each class, and a Rosette for Best Junior Handler overall.

***Prizes For Junior Handling Sponsored By Best in Show - Show Supplies***



# Eukanuba®

### **Champions and Championship Points**

*Chapter 15.1* A dog awarded WINNERS at a championship show shall be credited with a number of championship points (ranging from 0 to 5) and the number of championship points credited to a dog awarded WINNERS shall be as provided hereunder.

*15.1.2* The schedule to be employed in the determination of the number of points to be allocated a dog awarded Winners shall be:

Dogs Competing*	1	2	3 to 5	6 to 9	10 to 12	13 or more
<b>Points Allocated</b> *includes the dog awarded WINNERS	0	1	2	3	4	5

In counting the number of eligible dogs in competition, a dog that is disqualified, dismissed, excused or ordered from the ring by the judge shall **NOT** be included in the calculation for championship points.

**Note:** To determine the number of championship points earned by a dog awarded WINNERS, total all the dogs in competition which the dog defeated, directly or indirectly, for the highest of the following official breed awards, Winners, Best of Winners, Best of Breed, or Best of Opposite Sex, then consult the schedule set forth above.

*Section 15.1.8*, ... a dog awarded WINNERS which also places in the regular group competition shall be credited with the following additional points, provided that a dog was defeated at the Group level.

Number of breeds competing at Group level	Dog placed First	Dog Placed Second	Dog Placed Third	Dog Placed Fourth
<b>13 or more</b>	5	4	3	2
<b>10 to 12</b>	4	3	2	1
<b>6 to 9</b>	3	2	1	1
<b>5</b>	2	1	1	1
<b>4</b>	2	1	1	0
<b>3</b>	2	1	0	0
<b>2</b>	1	0	0	0
<b>1</b>	0	0	0	0

*Section 15.1.9*, A dog may not be credited with more than five (5) championship points in a single show.

*Section 15.1.11*, A dog awarded WINNERS which also places Best in Show at an all-breed Championship Show shall be credited with five (5) championship points inclusive of any points earned at breed or group level.

*Section 15.1.12 (c)*, In order for a dog to be recognized as a Champion and its owner provided with a Championship certificate, the dog must...have earned at least one 2 point win either at the breed or group level.

### **Moving a Class Dog to Specials**

*Chapter 8, Section 8.9.1*, A dog which is individually registered in the records of the Canadian Kennel Club, and has completed the requirements for a championship in accordance with these rules but at the time of the closing of entries for a show has not received confirmation of the title, may be transferred from one of the regular classes to "Specials Only", providing the transfer is submitted to the Show Secretary in WRITING by the owner or handler at least one (1) hour prior to the opening of the show.

*Section 8.9.3*, When one or more all-breed and/or specialty shows are held on the same day, in the same venue, the request for moving of class dogs to specials must be made prior to the scheduled opening of the first show.

Every day of a 2 or more day show is a separate show. Please note that this rule is effective up to one (1) hour prior to the opening of the show, NOT one hour prior to the judging of the breed.

**CKC Rules & Regulations 4.1.3** - A judge officiating at a show held under these rules shall not be subjected to indignities of any kind during the progress of the show. It shall be the duty and obligation of the club holding the show to see that this rule is effectively carried out.

### **Trophy List**

Though the generosity of members and friends, the Stormont, Dundas, & Glengarry Dog Association, is pleased to offer prizes and Rosettes for the following each day:

Best in Show, Best Puppy in Show, High In Trial, High in Obedience & Rally Class,  
First in Each Group, Best Puppy in Each Group. Rosettes for Best Brace in Group & Show  
Performance Event New Title Rosettes will be offered to any Exhibitor that receives their Title  
in Obedience, Rally, or Agility, at these Trials.

It is the exhibitors' responsibility to pick up their rosette, all rosettes must be picked up at the show.

No rosettes will be mailed.

Best In Show Dog show supplies will be offering gift certificates for Best Brace in Group and Best Brace Overall.

### **NON CKC MEMBER PARTICIPATION FEE - CANADIAN RESIDENTS ONLY** Effective April, 2011.

The CKC will be instituting a Non-Member Participation fee for all Canadian residents who participate in a CKC event but are not CKC members. The non member participation fee is paid in any year a title is earned and covers all titles and dogs owned by that individual. In order to protect the awards/titles earned, the non-member will have a choice either to become a CKC member or to pay the non-member participation fee. Failure to comply within 30 days of notification will cause all awards and titles to be cancelled This applies to dogs wholly owned by non members resident in Canada, and does not apply to U.S. exhibitors nor to CKC members or dogs co-owned with a CKC member

OFFICIAL CANADIAN KENNEL CLUB FORM		Armband #
<b>SD&amp;G - CONFORMATION</b>		
<input type="checkbox"/> Friday, August 23, 2013		<input type="checkbox"/> Sunday, August 25, 2013
<input type="checkbox"/> Saturday, August 24, 2013		<input type="checkbox"/> Monday, August 26, 2013
<b>Obedience</b>	<b>Dates</b>	<b>Rally</b>
<input type="checkbox"/> Trial 1 <input type="checkbox"/> Trial 2	<b>Friday August 23, 2013</b>	<input type="checkbox"/> Trial 1 <input type="checkbox"/> Trial 2
<input type="checkbox"/> Trial 3 <input type="checkbox"/> Trial 4	<b>Saturday, August 24, 2013</b>	<input type="checkbox"/> Trial 3 <input type="checkbox"/> Trial 4
<input type="checkbox"/> Trial 5 <input type="checkbox"/> Trial 6	<b>Sunday, August 25, 2013</b>	<input type="checkbox"/> Trial 5 <input type="checkbox"/> Trial 6
		<b>Price List</b>
		Entry Fee: \$ 29.00 CDN/USD
		Baby Puppy Entry Fee: \$ 25.00 CDN/USD
		Listing Fee: \$ 9.70 CDN or USD
		Other Fees: Sweepstakes, Exhibition, & Non – Regular - \$ 15.00 CDN or USD
<input type="checkbox"/> Pre Paid and Pre Ordered Catalogue \$ 10.00 CDN/USD    TOTAL FEES FOR THIS ENTRY: \$		
Make <b>Cheques Payable</b> to SD & G Dog Association <b>Entries Close: Tuesday JULY 30, 2013 at 8 pm</b>		
<b>Conformation</b>	<b>Rally (Limited Entry)</b>	<b>Obedience (Limited Entry)</b>
<input type="checkbox"/> Baby Puppy (3-6 mos) <input type="checkbox"/> Bred By Exhibitor	<b>Jump Heights</b>	<input type="checkbox"/> Pre - Novice <input type="checkbox"/> Open A <input type="checkbox"/> Utility A
<input type="checkbox"/> Jr. Puppy (6 – 9 mos) <input type="checkbox"/> Open	<input type="checkbox"/> 6" <input type="checkbox"/> 8" <input type="checkbox"/> 12" <input type="checkbox"/> 16"	<input type="checkbox"/> Novice A <input type="checkbox"/> Open B <input type="checkbox"/> Utility B
<input type="checkbox"/> Sr. Puppy (9 – 12 mos) <input type="checkbox"/> Specials Only	<input type="checkbox"/> Novice A <input type="checkbox"/> Novice B	<input type="checkbox"/> Novice B <input type="checkbox"/> Exhibition
<input type="checkbox"/> 12 – 18 month <input type="checkbox"/> Brace (Sun Only)	<input type="checkbox"/> Advanced A <input type="checkbox"/> Advanced B	<input type="checkbox"/> Novice C
<input type="checkbox"/> Canadian Bred <input type="checkbox"/> Exhibition	<input type="checkbox"/> Excellent A <input type="checkbox"/> Excellent B	<input type="checkbox"/> Intermediate Novice
		Jump Heights <b>Height</b> <b>Width</b>
<b>BREED</b>		<b>SEX:</b> <input type="checkbox"/> MALE OR <input type="checkbox"/> FEMALE
<b>REGISTERED NAME OF DOG</b>		
Check One & Enter Number Here		<b>IS THIS A PUPPY?</b>
<input type="checkbox"/> CKC Reg #		<input type="checkbox"/> Yes or <input type="checkbox"/> No
<input type="checkbox"/> CKC PEN #		<b>PLACE OF BIRTH?</b>
<input type="checkbox"/> CKC ERN #		
<input type="checkbox"/> CKC Misc Cert.#		
<input type="checkbox"/> LISTED		<input type="checkbox"/> Canada
		<input type="checkbox"/> Elsewhere
<b>BREEDER(S)</b>		
<b>SIRE</b>		
<b>DAM</b>		
<b>REGISTERED OWNER(S)</b>		
<b>OWNER'S ADDRESS</b>		
<b>CITY</b>	<b>PROV/STATE</b>	<b>POSTAL CODE/ZIP</b>
<b>NAME OF OWNERS AGENT (IF ANY) AT THE SHOW</b>		
<b>AGENT'S ADDRESS</b>		
<b>CITY</b>	<b>PROV/STATE</b>	<b>POSTAL CODE/ZIP</b>
<b>Mail ID to:</b> <input type="checkbox"/> OWNER Or <input type="checkbox"/> AGENT		
I certify that I am the registered Owner(s) of the dog or that I am the authorized agent of the Owner(s) whose name(s) I have entered above and accept full responsibility for all statements made in this entry. In Consideration of the acceptance of this entry, I (we) agree to be bound by the rules and regulations of the Canadian Kennel Club and any additional rules and regulations appearing in the premium list. Also, by signing this form I certify that I will not hold the Show giving Club, it's members, Directors, Employees, or Agents, liable in the event of any accident or misfortune however caused.		
Signature of Agent or Owner		Phone Number
a 15% + HST, charge applies on Credit Card Charges		Email address
<input type="checkbox"/> VISA <input type="checkbox"/> MasterCard <input type="checkbox"/> AMEX		<b>Expiry Date:</b> Month >   Year >
<b>Card Number:</b> _____ --   _____ --   _____ --   _____		
<b>Name of Card Holder:</b> _____		
<b>Fax #</b>	<b>Mail To:</b> COLMAR Show Service, 340 Mercer St, Chatham, ON, Canada N7M 6E1	
<b>519-351-3223</b>	<b>Web Site:</b> www.colmars.com	

All Fees are payable at time of entry. No entry will be processed or entered in this show without payment.  
Listing fees are applicable for all dogs entered in the shows that do not have an individual CKC Reg. Number or an ERN number.

NATIONAL SPECIALTY SHOW  
**Borzoi Canada**  
Saturday August 24, 2013



**CONFORMATION - Regular & Non-Regular Classes**

**Nicholas Debedout**, Cra 80 No 152-25, Bogotá, Columbia

**SWEEPSTAKES - All Sweepstakes Classes**

**Alistair Sutherland**

**OFFICERS**

President ..... Cherie Hunchak                      Secretary / Treasurer.... Judy Carleton  
Vice-President East ..... Pam Calver                      Vice President West .... Tarja Kleemola  
Directors: **Maritimes** - Vacant, **Ontario** - Rita Walker, **Manitoba** - Reed Fowlie, **Saskatchewan** -  
Brad Magnus, **Alberta** - Susan Shaw, **BC** - Linda Falkner  
**Rescue coordinator** - Pam Calver  
Show Chair ..... Paul Allard & Steve Pedro  
Show Superintendent ..... Jodie O'Meara                      Show Secretary ..... COLMAR Show Service

**Regular Classes** - (divided by sex) – Baby Puppy (3-6 mos), Jr Puppy 6- 9 mos, Sr Puppy 9- 12 mos,  
12 - 18 Month, Canadian Bred, Bred by Exhibitor, Open), Specials Only, Veterans.  
& Sexually Altered Class

**Non-Regular Classes** - Exhibition Only, Brace, Team, Stud Dog, Brood Bitch, Best Head,

Field Dog Class (Dogs that have earned a qualifying score at a CKC Hunt Test or Field Trial, or  
dogs that have earned a qualifying score at a AKC Hunt Test or Field Trial)

**TROPHIES AND ROSETTES**

Through the generosity of Sponsors, Friends and Members of Borzoi Canada, a suitable Trophy or Prize &/or Rosette or Ribbon will be offered for Best of Breed, Best of Opposite, Best Puppy in Breed, Winners (Male & Female), Best of Winners, Reserve Winners (Male & Female), Bred by Exhibitor (Male & Female), Best Bred By Exhibitor , Veterans (Male & Female) , Best Veteran , Field Champion (Male & Female), Best Field Champion, Altered (Male & Female), Best Altered in Breed, Best Brace, Best Team, Best Stud Dog, Best Brood Bitch, Best Baby in Breed, Best Head.

**Award Of Merit:** One rosette and/or Trophy/Prize will be offered for every ten dogs competing at Best of Breed level, awards of merit will be presented at the discretion of the judge.

*(All Dogs Entering the ring to Compete for Best Of Breed will be counted).*

**Perpetual Trophy:** The Borzoi Canada "Lady Sirhan National Specialty Perpetual Trophy" and a keeper plaque will be presented for the BISS winner.

**Sweepstakes**

Please Note: All Dogs entered in Sweepstakes must also be entered in one of the regular classes at the specialty.

This specialty will include Regular and Veteran Sweepstakes as follows:

Sweepstakes classes (divided by sex) – 3-6 mos, 6 - 9 Mos, 9 -12 Mos, & 12 -18 Mos,

Veteran Sweepstakes (divided by sex) – 7 - 9 yrs, 9 -11 yrs & 11 yrs & over, as of the day of the specialty.

Prizes: SWEEPSTAKES & VETERAN SWEEPSTAKES

Best in Sweepstakes ..... 50% of entry money

Best of Opposite in Sweepstakes ..... 25% of entry money

25% will be retained by SD & G DA for administration.

Rosettes and/or prizes will be awarded for Best in Sweepstakes and Best of Opposite in Sweepstakes

**SPECIAL EVENTS:** *Meet and Greet* prior to show and Luncheon will be served

*Armband Draw* (must be present at the show to win), *Raffle*, & *Silent Auction* (tentative)

For More information regarding this specialty

Paul Allard & Steve Pedro at [freckashpeng@sympatico.ca](mailto:freckashpeng@sympatico.ca)

# IRISH SETTER CLUB OF CANADA - NATIONAL SPECIALTY

## SATURDAY AUGUST 24, 2013

### CONFORMATION - Regular & Non-Regular Classes

**Jose Haro Haro, Cádiz, Spain**

### SWEEPSTAKES – All Sweepstakes Classes

**Marie Tinlin, 1217 Brandon Road, Odessa, Ontario K0H 2H0**

### OFFICERS

President.....Dr. Nancy Higgitt Vice-President .....Laureen Strelloff  
Secretary/Treasurer.....Mike O'Brien Show Chair .....Mike O'Brien  
Directors: BC – Pam Legault, Prairies – Roberta Tucker, Ontario – Joan Colbourn,  
Quebec – Myriam Huot, Atlantic – Barbara Deg  
Show Superintendent.....Jody O'Meara Show Secretary..... COLMAR Show Service

### CLASSES - Divided by Sex

Regular Classes: Baby Puppy (3 – 6 mos), Jr (6-9), Sr (9-12), (12-15), (15-18), Cdn Bred, Bred By Ex, Open, Veteran (7-10 yrs & 10yrs +), Specials Only & Altered (spayed/neutered dogs allowed in Veterans class)

Non – Regular: Exhibition Only, Stud Dog, Brood Bitch, Brace,

Unofficial: Team & Field (must have at least 1 qualifying score in a CKC or AKC hunting event & must be entered in a regular specialty event or Exhibition Only; may be spayed/neutered)

### SWEEPSTAKES as of the day of the specialty

**Please Note:** All Dogs entered in Sweepstakes must also be entered in one of the official classes at the specialty.

This specialty will include SWEEPSTAKES, VETERAN SWEEPSTAKES as follows:

All Sweepstakes classes divided by sex - 3-6 mos, 6 - 9 Mos, 9 -12 Mos, 12 – 18 mos & 15 -18 Mos,

All Veteran Sweepstakes classes divided by sex - 7-10 yrs, 10 yrs +

### PRIZES (Sweepstakes & Veteran Sweepstakes)

75 % of the entry money received for each class will be awarded to the winner of each class

Rosettes 1st to 4th place in each class. - A rosette will be offered to the Best in Sweepstakes.

25% will be retained by ISCC for administration.

### Trophies & Prizes

Through the generosity of its, members and friends the Irish Setter Club of Canada will offer suitable prizes and rosettes, for the following awards:

Best Of Breed, Best Of Opposite Sex, Best Canadian Bred, Best Of Winners, Winners Dog, Winners Bitch, Reserve Winners Dog, Reserve Winners Bitch, Best Puppy, Best Veteran , Best Of Breed Altered.

Rosettes will be awarded for the placements in each class.

AWARD OF MERIT (Rosette &/or Trophy) may also be presented at the, judge's discretion (at the rate of 1 Award/10 dogs in Best of Breed, competition. All prizes must be claimed at the show.

Trophies &/or Rosettes will be given for the Highest Qualifying Score accumulated by an Irish Setter in each of the SD& G all breed trials in Obedience, Rally and Agility over the 3 days of trials.

Trophies &/or Rosettes will be given to the Irish Setter achieving the Highest Qualifying Score in each field class (Field Dog Junior, Field Dog, Field Dog Excellent), and for the Highest Overall Qualifying Score in the Field Test.

A Rosette and Trophy will be awarded to the Irish Setter that achieves the highest score in the ISCC Versatility competition. The score will be based on achievements in two or more of the following competitions associated with the Specialty: Specialty Conformation, host club Obedience, Rally and/or Agility competitions, and the Field Test (see special events below).

### Special Events

The Performance Field Test will take place on Tuesday, August 27, 2013 as part of the Ottawa Valley Pointing Dog Club. For information, contact: [www.ovpdc.org](http://www.ovpdc.org).

The ISCC Versatility Award will be awarded after the Specialty and the OVPDC Field Test to the Irish Setter that best meets the Club's versatility criteria during the Specialty, the all-breed competitions in obedience, rally and agility, and the Field Test. Competition rules are found on the ISCC website: <http://www.irishsettercanada.org> to help competitors prepare early for this event.

### Junior Handling

Trophy & Rosette will be awarded for Best Overall Junior Handler. Rosettes will be awarded for 1<sup>st</sup> in each class.

### Social

A Meet and Greet will be held at ringside after Best in Show on Saturday August.24, 2013

For More information regarding the Irish Setter Club of Canada National Specialty

**Contact:** Mike O'Brien, 613-258-9136, [info@irishsettercanada.org](mailto:info@irishsettercanada.org) [www.irishsettercanada.org](http://www.irishsettercanada.org)

**PLEASE CHECK EACH SPECIALTY FOR THE CLASSES THAT ARE OFFERED**

<input type="checkbox"/> <b>Borzoi</b> Canada- Saturday Aug 24/13 <input type="checkbox"/> <b>Irish Setter</b> Club of Canada- Saturday Aug 24/13 <input type="checkbox"/> <b>Ottawa Valley All Setter</b> Association- Saturday Aug 24/13 <input type="checkbox"/> <b>Pointer</b> Club of Canada National - Sat August 24, 2013 <input type="checkbox"/> <b>German Shorthaired Pointer</b> CC –Sat August 24, 2013	<b>SD &amp; G Specialties</b> <input type="checkbox"/> Rideau <b>Terrier</b> Club - Group Four Specialty- Sat Aug 24/13 <input type="checkbox"/> <b>Vizsla</b> Canada (National) - Saturday August 24, 2013 <input type="checkbox"/> <b>Border Terrier</b> Club of ON - Sunday August 25, 2013 <input type="checkbox"/> Ottawa Valley <b>Pointing Dog Club</b> - Sunday August 25, 2013 <input type="checkbox"/> <b>Miniature Schnauzer</b> – RTC -Sunday, August 25, 2013	Armband # _____
<b>Price List - Entry Fee:</b> \$ 29.00 CDN/USD <b>Listing Fee:</b> \$ 9.70 & Baby Puppy No Listing Fee <b>Other Fees:</b> Exhibition, Sweepstakes, Non Regular, \$15.00 CDN/USD		
<b>PRE - ORDERED CATALOGUES - <input type="checkbox"/> ALL BREED \$ 10.00 CDN/USD</b>		
<b>Cheques Payable to SD &amp; G Dog Association</b>		<b>Entries Close: Tuesday July 30, 2013 at 8pm</b>
<b>CONFORMATION</b>		
<input type="checkbox"/> BABY. Puppy (3-6 mth) <input type="checkbox"/> 12 - 18 months <input type="checkbox"/> Canadian Bred <input type="checkbox"/> Open <input type="checkbox"/> Veteran <input type="checkbox"/> JR. Puppy (6 – 9 mth) <input type="checkbox"/> 12 - 15 months <input type="checkbox"/> Bred By Exhibitor <input type="checkbox"/> Specials Only <input type="checkbox"/> Sexually Altered <input type="checkbox"/> SR. Puppy (9 – 12 mth) <input type="checkbox"/> 15 - 18 months		
<b>SWEEPSTAKES</b>		
<input type="checkbox"/> 3-6 MONTHS <input type="checkbox"/> 9 - 12 months <input type="checkbox"/> 15-18 months <input type="checkbox"/> 7-9 years <input type="checkbox"/> 9 years + <input type="checkbox"/> 11-12 years <input type="checkbox"/> 6 - 9 MONTHS <input type="checkbox"/> 12-15 months <input type="checkbox"/> 12-18 months <input type="checkbox"/> 7 -10 years <input type="checkbox"/> 10 years + <input type="checkbox"/> 13 years + <input type="checkbox"/> 18 - 24 months <input type="checkbox"/> 9 -11 years <input type="checkbox"/> 11 years + <input type="checkbox"/> 3 Generation Sweepstakes		
<b>SPECIALTY OBEDIENCE</b>		
<input type="checkbox"/> Pre- Novice <input type="checkbox"/> Novice A <input type="checkbox"/> Novice B <input type="checkbox"/> Novice C <input type="checkbox"/> Open A <input type="checkbox"/> Open B <input type="checkbox"/> Utility A <input type="checkbox"/> Utility B <input type="checkbox"/> Intermediate Novice   <b>JUMP HEIGHTS</b> Height -    Width -		
<b>NON REGULAR CLASSES</b>		
<input type="checkbox"/> Exhibition Only <input type="checkbox"/> Brace <input type="checkbox"/> Brood Bitch <input type="checkbox"/> Stud Dog <input type="checkbox"/> Parade of Veterans <input type="checkbox"/> Parade of Titleholders <input type="checkbox"/> Field Dog <input type="checkbox"/> TEAM <b>ANY OTHER CLASS NOT LISTED</b> <input type="checkbox"/>		
<b>BREED</b>		<input type="checkbox"/> Short - Haired <b>SEX:</b> <input type="checkbox"/> MALE OR <input type="checkbox"/> FEMALE <input type="checkbox"/> Long - Haired
<b>REGISTERED NAME OF DOG</b>		
Check One & Enter Number Here <input type="checkbox"/> CKC Reg # <input type="checkbox"/> CKC PEN # <input type="checkbox"/> CKC ERN # <input type="checkbox"/> CKC Misc Cert.# <input type="checkbox"/> LISTED	<b>Date Of Birth:</b> Please Circle Month Jan Feb Mar Apr May June July Aug Sept Oct Nov Dec Day _____ Year _____.	<b>IS THIS A PUPPY?</b> <input type="checkbox"/> Yes or <input type="checkbox"/> No <b>PLACE OF BIRTH?</b> <input type="checkbox"/> Canada <input type="checkbox"/> Elsewhere
<b>BREEDER(S)</b>		
<b>SIRE</b>		
<b>DAM</b>		
<b>REGISTERED OWNER(S)</b>		
<b>OWNER'S ADDRESS</b>		
<b>CITY</b>	<b>PROV/STATE</b>	<b>POSTAL CODE/ZIP</b>
<b>NAME OF OWNERS AGENT (IF ANY) AT THE SHOW</b>		
<b>AGENT'S ADDRESS</b>		
<b>CITY</b>	<b>PROV/STATE</b>	<b>POSTAL CODE/ZIP</b>
<b>Mail ID to:</b> <input type="checkbox"/> OWNER Or <input type="checkbox"/> AGENT		
I certify that I am the registered Owner(s) of the dog or that I am the authorized agent of the Owner(s) whose name(s) I have entered above and accept full responsibility for all statements made in this entry. In consideration of the acceptance of this entry, I (we) agree to be bound by the rules and regulations of the Canadian Kennel Club and any additional rules and regulations appearing in the premium list. Also, by signing this form I certify that I will not hold the Show giving Club, it's members, Directors, Employees, or Agents, liable in the event of any accident or misfortune however caused.		
Signature of Agent or Owner _____		Phone Number _____
a 15% + HST, charge applies on all Credit Card Charges		Email address _____
<input type="checkbox"/> VISA <input type="checkbox"/> MasterCard <input type="checkbox"/> AMEX <b>Expiry Date:</b> Month > _____ Year > _____		
<b>Card Number:</b> _____ - _____ - _____ - _____		
<b>Name of Card Holder:</b> _____		
<b>Fax #</b> 519-351-3223		<b>Mail To:</b> COLMAR Show Service, 40 Mercer St, Chatham, ON, Canada N7M 6E1
<b>Web Site:</b> www.colmars.com		

All Fees are payable at time of entry. No entry will be processed or entered in this show without payment.  
 Listing fees are applicable for all dogs entered in the shows that do not have an individual CKC Reg. Number or an ERN number



SPECIALTY SHOW for ALL Setters (English, Gordon, Irish and Irish Red & White)

## OTTAWA VALLEY ALL SETTER ASSOCIATION

PROUDLY SPONSORED BY



Thirty-Eighth Annual Specialty Show

**Saturday, August 24, 2013**



**CONFORMATION - Regular & Non-Regular Classes**

**Peter Frost**, 28 Currajong Road East Hawthorn, Australia 3123

**SWEEPSTAKES All Classes -**

**Connie O'Brien**, Mountain, ON, Canada

### OFFICERS

President – Bill Cockburn      Vice-President – Marie Tinlin      Treasurer- Deborah Cook  
Secretary – Wendy Watson      Membership – Debbie Cook      Rescue - Patrick & Vicky Hunt  
Directors – Tina Cockram, Mary Lou Levesque, Bonnie Whitten  
**Show Chairs - Wendy Watson** wwbirdie1@gmail.com,  
& **Bill Cockburn** devonshire.englishsetters@gmail.com  
Show Superintendent .....Jodie O'Meara      Show Secretary ..... COLMAR Show Service

**CLASSES - Divided by Sex** Regular Classes: Jr (6-9), Sr (9-12), (12-18), CDN Bred, Bred By Ex, Open, Veteran, Specials Only. (Please Note Spayed/Neutered dogs may participate in the Veteran class)

**Non – Regular Classes:** Exhibition Only, Stud Dog, Brood Bitch & Brace, All Setter breeds combined. Field Dog, must have one leg towards Field Title & all Setter Breeds & sexes combined Entries in these classes may be spayed or neutered & must be entered in any OVASA Specialty class or Exhibition Only. Judging of these Non-Regular Classes will be held immediately after Best of Breed of the Last Setter Breed

**Unofficial Classes:** Best Setter in Multiple Breed Specialty (Best Setter in each breed to compete), Best Setter Puppy in Multiple Breed Specialty (Best Setter Puppy in each breed to compete), Best Setter Veteran in Multiple Breed Specialty (1st place Veteran Dog and 1st place Veteran Bitch in each breed to complete. There will be no Best of Veteran Award at Breed Level).

**Parade of Rescue Dogs:** For Setter Dogs or Bitches that have been placed in a new home by the Rescue System No fee and no registration number required. May be spayed or neutered. Non-competitive.

### TROPHIES AND ROSETTES

Through the kindness and generosity of its members and friends, OVASA is pleased to offer the following: Rosettes for 1st to 4th place for All Official Classes. Trophies and Rosettes will be awarded for Best of Breed, Best of Opposite Sex, Best Puppy, Best of Winners (Rosette only), Winners Dog, Winners Bitch, Reserve Winners Dog, Reserve Winners Bitch, Veteran Dog (Rosette only), Veteran Bitch (Rosette only), For all Combined Breeds – Best Setter in Multiple Breed Specialty, Best Setter Puppy in Multiple Breed Specialty, Best Setter Veteran in Multiple Breed Specialty, Field Dog, Stud Dog, Brood Bitch & Brace. **Award Of Merit:** One rosette will be offered for every ten dogs competing at Best of Breed level. Awards of merit will be presented at the discretion of the judge.

**Obedience** Highest Qualifying Score by a Setter in Obedience on the day of the Specialty.

### Perpetual Trophies

The following perpetual trophies will be awarded but will remain with the hosting club:

**The Killane Rogue Memorial Trophy**, Best Setter in Specialty - Donated by the late John & Muriel Royston.

**The Spruce Trophy**, BOB – English Setter –Donated by Joan Detmold

**The Gunnstalk Trophy**, BOB – Gordon Setter –Donated by Sandy Gunn

**The Bryjade Trophy**, BOB – Irish Setter –Donated by Don & Janice Craig

**The Irish R & W Setter Trophy**, BOB – Irish R & W Setter –Donated by the Irish R & W Setter Club of Canada

**The Gus Polley Memorial Trophy**, Best Puppy in Specialty –Donated by Tina Cockram, Lori Stewart & Jill Taylor

**The Horace S. Hollands Memorial Trophy**, Best Puppy in Sweeps - Donated by the Late Mrs. Anne Snelling

**The Veteran Sweepstakes Trophy**, Best Veteran in Sweeps –Donated by Len & Cheryl Walker

### SWEEPSTAKES

**Please Note:** All Setters entered in Sweepstakes must be entered in one of the official classes or Exhibition only at the specialty.

This specialty will include Sweepstakes, Veteran Sweepstakes as follows: for All Setter Breeds

All Regular Sweepstakes classes NOT divided by sex - 6 - 9 mos, 9 -12 mos, 12 – 15 mos & 15 -18 Mos.

All Veteran Sweepstakes classes NOT divided by sex - 7-10 yrs, 10 years and over, as of the day of the specialty.

**Prizes: SWEEPSTAKES & VETERAN SWEEPSTAKES**

Rosettes 1st to 4th place in each class. - A rosette will be offered to the Best in Sweepstakes.

**Prize money:** 75% of the entry money received will be divided by the total number of entries and awarded to the winner of each of the classes based on the number of dogs entered in that class.

No additional money will be awarded to the Best in Sweepstakes.- Balance of 25% will be retained for Administration.

For More information regarding the OVASA Specialty

Wendy Watson - wwbirdie1@gmail.com **OR**

Bill Cockburn - devonshire.englishsetters@gmail.com

---

---

National SPECIALTY SHOW  
**GERMAN SHORTHAIRED POINTER CLUB OF CANADA**  
**Saturday, August 24, 2013**



**CONFORMATION - Regular & Non-Regular Classes**

**Betsy Yates**, 1462 Sedgefield Dr., New Albany, OH USA 43054-9424

**SWEEPSTAKES** – All Classes - **Peter Scott**, 56 Gilmour Rd., Guelph, ON N1H 6H9

**OFFICERS**

President .....	Maxine Moinier	Vice - President .....	Tammy Parris				
Treasurer.....	Barbara Taws	Secretary .....	Maria Foster				
Directors: (Atlantic)	Karen Walsh (Quebec)	Francois Bernier (Ontario)	Nancibeth Koutstaal (Saskatchewan)	Diane Nolan (Alberta)	Steve Short and Angel Wagner (BC)	Kathy Brennan	
Show Chair.....	Lorrie Brennan,	nuthatchkennels@gmail.com					
Show Superintendent .....	Jodie O'Meara	Show Secretary .....	COLMAR Show Service				

**CLASSES** - Divided by Sex - Regular Classes: Baby Puppy (3-6 mos), Junior (6-9), Senior (9-12), (12-18), Canadian Bred, Bred By Exhibitor, Open, Veteran, Specials Only, and Exhibition Only.

**NON-REGULAR CLASSES:** Brace, Field Dog\*, Field Bitch\*, Stud Dog & Brood Bitch

\*Field Dog & Field Bitch Class: for all German Shorthaired Pointers who have earned a Qualifying Score at a Licensed CKC Field Dog Test (Canada) or at a Licensed AKC Hunting Test (USA), or a placement at a Licensed CKC Field Trial (Canada) or at a Licensed AKC Field Trial (USA), prior to the closing of entries

Note: Dogs entered for the unofficial classes must also be entered in one of the official classes or Exhibition Only. If entered in unofficial classes, spayed/neutered dogs must be entered in exhibition only.

**Trophies & Rosettes**

Through the generosity of friends and members, the German Shorthaired Pointer Club Of Canada will offer suitable rosettes &/or trophies for: Best Of Breed, Best Of Opposite Sex, Best Puppy In Breed, Best Of Winners, Winners Male & Female, Reserve Winners Male & Female, Veteran Dog & Veteran Bitch, Best Overall Veteran, Best Canadian Bred in Breed, Best Bred By Exhibitor in Breed, Best Stud Dog, Best Brood Bitch, Best Field Dog & Best Field Bitch, Best Overall Field Dog, & Award of Merit. **Award Of Merit:** *One rosette will be offered for every ten dogs competing at Best of Breed level. Awards of merit will be presented at the discretion of the judge.*

**SWEEPSTAKES**

**Please Note:** All Dogs entered in Sweepstakes must also be entered in one of the official classes at the specialty. All Regular Sweepstakes classes divided by sex - 6 - 9 Mths, 9 - 12 Mths, & 12 - 18 Mths, as of the day of the specialty. All Veteran Sweepstakes classes are to be divided by sex - 7-9 yrs, 9 to 12 yrs, 12 yrs +, as of the day of the specialty.

**Prizes: SWEEPSTAKES** - 1<sup>st</sup> in each class - 50% of entry fees in that class

15 % of all entries, for Best in Sweepstakes. - 10 % of all entries, awarded for Best Opposite Sex in Sweeps.

Rosettes awarded for 2<sup>nd</sup> to 4<sup>th</sup> placements in each class. Balance of 25% will be retained for Administration

**Junior Handling** - Trophy & Rosette will be awarded for Best Overall Junior. Rosettes awarded for 1<sup>st</sup> in each class.

**Optigen Cone Degeneration Clinic**

The German Shorthaired Pointer Club of Canada is pleased to offer a cone degeneration testing opportunity at its upcoming National Specialty Show on August 24, 2013 in Long Sault, Ontario.

We are grateful to Optigen for setting up these savings!

The Cone Degeneration test is offered at **\$120, a 25% discount** off the regular price.

**You MUST sign online first at Optigen** ([www.optigen.com](http://www.optigen.com)). Please use the **code GSPNS138** to get the discount.

This code will be active from August 10th to 24th, 2013. You will have to **bring your papers with you to the show.**

This test is open to other breeds as well, please refer to OptiGen's test page for test/breed availability.

We are happy to accept swabs mailed in from those who cannot attend as long as they are received before the show date. We cannot accept submissions after August 24, 2013. The CD test at the show is open to other breeds.

We open participation to anyone who owns a GSP to send samples directly to OptiGen in addition to those coming to the event. To get the discount rate, you must sign online at Optigen between August 10th and 24<sup>th</sup>, AND ship your sample no later than August 30, 2013. Any sample received after September 6, 2013 by Optigen will not be allowed to receive the GSPCC discount.

Please contact Lise Cere at [braquias@yahoo.ca](mailto:braquias@yahoo.ca) for more information.

**2013 Specialty- Host Hotel**

Best Western Parkway Inn – 1515 Vincent Massey Drive, Cornwall, ON,

A set of rooms has been booked under GSPCC

Please phone the hotel directly to make reservations. 613-932-0451

All GSPCC exhibitors and their families are invited to join us for a dinner on Saturday night. For more information please contact Lyndsay Ferguson, [lyndsayerinferguson@gmail.com](mailto:lyndsayerinferguson@gmail.com)

For More information regarding the GSPCC National Specialty

**Contact: Lorrie Brennan** - [nuthatchkennels@gmail.com](mailto:nuthatchkennels@gmail.com)

**POINTER CLUB OF CANADA  
NATIONAL SPECIALTY  
SATURDAY AUGUST 24, 2013**



**CONFORMATION - Regular & Non-Regular Classes**

**Jose Haro Haro, Cádiz, Spain**

**SWEEPSTAKES – All Sweepstakes Classes**

**Genevieve Munro, Erin, ON**

**OFFICERS**

President.....	Jo Griffith	Vice-President.....	Genevieve Munro	
Secretary .....	Rhonda Ace	Treasurer.....	Jill Koch	
Show Chair .....	Jo Griffith			
Directors: BC –	Jill Koch, Alberta –	Brett Maggs, Manitoba –	Barb Bigelow, Ontario –	Rhonda Ace
Show Superintendent.....	Jody O’Meara			
Show Secretary .....	COLMAR Show Service			

**CLASSES - Divided by Sex**

**Regular Classes:** Jr (6-9), Sr (9-12), (12-18), Cdn Bred, Bred By Ex, Open, Veteran, Specials Only  
& Altered (spayed/neutred dogs allowed in Veterans class)

**Non – Regular:** Exhibition Only, Stud Dog, Brood Bitch, Brace,

Field Dog Class (Dogs that have earned a qualifying score at a CKC Hunt Test or Field Trial, or  
dogs that have earned a qualifying score at a AKC Hunt Test or Field Trial)

**SWEEPSTAKES**

**Please Note:** All Dogs entered in Sweepstakes must also be entered in one of the official classes at the specialty.

This specialty will include SWEEPSTAKES, VETERAN SWEEPSTAKES as follows:

All Regular Sweepstakes classes divided by sex - 6 - 9 Mos, 9 -12 Mos, & 12 -18 Mos, as of the day of the specialty.

All Veteran Sweepstakes classes are to be divided by sex - 7-9 yrs, 9 to 11 yrs, 11 yrs +, as of the day of the specialty.

**PRIZES** (Regular & Veteran)

Prize money will be divided as follows:

Best in Sweepstakes ..... Trophy, Rosette & 35% of entry fees.

Best of Opposite in Sweepstakes ..... Trophy, Rosette & 25% of entry fees.

First in each class ..... Rosette & 5% of entry fees

25% will be retained by club for administration.

Rosettes and prizes will be awarded for Best in Sweepstakes and Best of Opposite in Sweepstakes

**TROPHIES & PRIZES**

Through the generosity of its members and friends the Pointer Club of Canada will offer suitable prizes and rosettes, for the following awards: Best Of Breed, Best Of Opposite, Sex, Best Of Winners, Winners Dog, Winners Bitch, Reserve Winners Dog, Reserve Winners Bitch, Best Veteran Male And Female, Best Puppy, Best Of Breed Altered, Best Of Opposite Sex Altered, Brace, Stud Dog, Brood Bitch, Field Dog, Canadian Bred, Rosettes will be awarded for the placements in each class.

**AWARD OF MERIT** (rosette) may also be presented at the, judges discretion (at the rate of 1 Award/10 dogs in Best of Breed, competition. All prizes must be claimed at the show

**Social**

To Be Announced

**Rideau Terrier Club Saturday, August 24, 2013**  
**43<sup>rd</sup> ANNUAL SPECIALTY SHOW** - for All Breeds in Group 4



**THE RIDEAU TERRIER CLUB DEDICATES OUR 2013 SHOW  
in fond memory of our dear friend, IRIS BUCKLAND**

**Judge CONFORMATION** - Regular Non-Regular Classes

**David Kirkland**, 387 Holly Brook Rd., Sanford, NC USA 27330-6450

**Judge SWEEPSTAKES** – All Sweepstakes Classes

**Eva Monsen**, 364 Meadowbrook Dr., Milton, ON CAN L9T 3Y7

**Regular Classes** - Divided by Sex (Spayed/neutered dogs may be entered in Veteran class)

Jr (6-9), Sr (9-12), 12 to 18 mos, Canadian Bred, Bred By Exhibitor, Open, Veteran, Specials Only, & Altered.

**Non – Regular Classes:** Exhibition Only, Brace & Team

***The Rideau Terrier Club's BREED OF DISTINCTION FOR 2013 – Cairn Terrier***

**CLUB OFFICERS**

President.....Karen Nesbitt  
Vice-President.....Anita Roy  
Treasurer .....Squibs Mercier  
Secretary .....Laura Grieseson  
  
Show Superintendent.....Jodie O'Meara

**SHOW COMMITTEE**

Hon. Show Chair .....Marion Fleming  
Show Chair .....Linda Bergh  
Trophy Chair.....Mike Sullivan  
Hospitality..... Linda and Jim Mabey  
Hon. Ring Steward .....Chris Raine  
Show Secretary - COLMAR Show Service

**The Rideau Terrier Club will donate \$1 per entry in the Specialty  
towards the fight against Breed Specific Legislation**

**\$50.00 Armband Draw – Donated by Belle Severn**

**AWARDS**

**All donors to the Trophy Fund will be listed in the Official Show Catalogue**

The Rideau Terrier Club retains its perpetual trophies; keeper prizes are offered to the winners

Best In Specialty – Betty Hyslop Memorial Trophy

Best Puppy in Specialty – Fred Fraser Memorial Trophy

Best Cdn.-bred in Specialty – Ch Redletter Miss Splinter's Memorial Trophy

Best Bred-by-Exhibitor in Specialty (Chosen from the Bred By Class) - Frances Atkins Memorial Trophy

Best Altered Dog in Specialty – Morgan Wueri Trophy

Best Veteran in Specialty – Staffhaven Trophy

Best Canadian-bred in Sweepstakes – Audrey Faibish Memorial Trophy

Best of Breed - Cairn Terrier, Cairndania Commemorative Trophy

Through the kindness of the Cairn Terrier Breeders and Owners the following prizes will be awarded for Cairn Terriers,

Winners Dog & Bitch, Best of Winners, Best of Opp. Sex and Best of Breed & Best Puppy

Prizes & Rosettes at Group level – Best in Specialty, Group 2, 3, & 4; Best Canadian-bred, Best Puppy, Best Bred-by-

Exhibitor, Best Veteran, Best Altered, Best Brace & Best Team

**SWEEPSTAKES**

(All Dogs entered in Sweepstakes must also be entered in one of the Regular Classes at the Specialty.)

Classes are divided by sex – Junior 6-9 mos., Senior 9-12 mos., & 12-18 mos. on the day of the Specialty.

Prizes in each class – 1<sup>ST</sup> – 25%; 2<sup>ND</sup> – 20%, 3<sup>RD</sup> – 15%, 4<sup>TH</sup> – 15% of entry fees received for that class.

Best in Sweeps – rosette

Best of Opposite Sex in Sweeps –rosette

Best Canadian Bred in Sweeps – (Perpetual Trophy), a prize and rosette

Flat ribbons will be awarded for 1<sup>ST</sup> through 4<sup>TH</sup> place in each class.

Balance of 25% will be retained by the Rideau Terrier Club

**For More information Contact - Linda Bergh [lindabergh21@hotmail.com](mailto:lindabergh21@hotmail.com)**



---

---

**VIZSLA Canada INC**  
NATIONAL SPECIALTY SHOW FOR VIZSLAS (Smooth)  
**Saturday, August 24, 2013**

**CONFORMATION - Regular & Non-Regular Classes**

**Linda Kelly**, 22879 705th Ave, Dassel, MN USA 55325-3325



**SWEEPSTAKES – All Sweepstakes Classes**

**Stewart Dankner**, 1153 Parthia Cres., Mississauga, Ont. L4Y 2L3

**OFFICERS**

President .....	Linda Currie	Vice-President.....	Jayne Coneybeare
Treasurer .....	Mabel Bingley	Correspondence Secretary .....	Billie Velestuk
Recording Secretary.....	Bev Lawson		

**Directors:**

BC –Heidi Bray, Quebec - Jacqueline Veillette, Atlantic - Richard Stoveld, Ontario – Julie Donnell

Show Chair – Terri Corneil

Show Superintendent .....Jodie O'Meara Show Secretary ..... COLMAR Show Service

**Regular Classes** - (divided by sex) - Baby Puppy 3-6 mos, Jr Puppy 6- 9 mos, Sr Puppy 9- 12 mos, 12-18 Month, Canadian Bred, Bred by Exhibitor, Open, Specials Only , Veterans (open to all dogs over 7 years of age and older on the day of the Specialty) & Sexually Altered Class

**Non-Regular Classes** - Exhibition Only, Brace Class, Stud Dog & Get – Brood Bitch & Progeny

**Unofficial Classes** (divided by sex) - Field Dog & Field Bitch (Must have any Field Title from CKC, AKC, NASTRA, NAVHDA)

**TROPHIES AND ROSETTES**

Trophies and/or Rosettes are offered by Vizsla Canada for Best of Breed, Best of Opposite Sex, Best of Winners, Best Puppy, Best Baby Puppy, Winners Dog & Bitch, Reserve Winners Dog & Bitch, Best Altered in Breed, Altered Dog & Bitch, Stud Dog, Brood Bitch, Best Brace, Field Dog, Field Bitch, Best Canadian Bred in Specialty (not necessarily from the Cdn Bred Class), 1<sup>st</sup> in each class.

Rosettes for 2<sup>nd</sup> through 4<sup>th</sup> in each class

**Award Of Merit:** One rosette will be offered for every ten dogs competing at Best of Breed level. Awards of Merit will be presented at the discretion of the judge.

Trophies & Rosettes will be given for the Highest Qualifying Score for a Vizsla in the SD& G all breed trials in Obedience, Rally and Agility when entered in the trials being held on the day of the Specialty.

**SWEEPSTAKES**

All Dogs entered in Sweepstakes must also be entered in one of the regular classes or exhibition only at the specialty.

Sweepstakes classes (divided by sex) – 3 – 6 mos, 6 - 9 Mos, 9 -12 Mos, & 12 -18 Mos

Trophy & Rosette for Best in Sweepstakes, Best of Opposite in Sweepstakes, & Best Puppy in Sweeps

**VETERANS SWEEPSTAKES**

All Dogs entered in Veteran Sweepstakes must be entered the regular classes or exhibition only at the specialty

Classes, divided by sex are offered for dogs 7 years & older.

Trophy and Rosette for Best in Veteran Sweepstakes and Best of Opposite in Veteran Sweepstakes.

**SWEEPSTAKE PRIZES:**

Entry fee in each class for both sweepstakes will be divided: 1<sup>st</sup> – 40%, 2<sup>nd</sup> – 30%, 3<sup>rd</sup> – 20%, 4<sup>th</sup> – 10%

25% of entry money will be retained by SD & G DA for administration costs in both sweepstakes

***Professional handlers may only handle dogs they own or co-own in both Sweepstakes. Professional handler is any person who has ever accepted remuneration for handling any breed of dog in the show ring.***

**2013 Specialty– Host Hotel**

Comfort Inn – 1625 Vincent Massey Drive, Cornwall, ON, K6H 5R6

Reservations: direct (613) 937-0111 or 1-800-424-6423 Rate is \$105.00 CDN plus taxes per night

No fee for dogs. Please phone the hotel directly to make reservations.

Tell them you are booking a room under the group “Vizsla Canada Specialty”

Rooms held until August 1st, 2013

All Vizsla Canada Specialty exhibitors and their families are invited to join us for a light luncheon hosted by Vizsla Canada.

For More information regarding this specialty **Contact**  
**Terri Corneil**, [tcorneil@shaw.ca](mailto:tcorneil@shaw.ca)



Specialty Show

**Border Terrier Club Of Ontario  
Sunday August 25, 2013**



**CONFORMATION** - Regular & Non-Regular Classes

**Barbara Steinbacher Dalane,**  
66 Lake Walkill Rd, Sussex, NJ, USA 07461

**SWEEPSTAKES** - Regular & Veteran Sweepstakes Classes

**Julie LaFreniere,** 156 Nichewaug Rd, Petersham, MA, USA 01366

**OFFICERS**

President .....Pat Dimitrovski      Vice-President .....Kirsten Goodman  
Secretary/Treasurer .....Karen Nesbitt  
Show Chairperson .....Jane Cairns  
Show Superintendent .....Jodie O'Meara      Show Secretary ..... COLMAR Show Service

**CLASSES** - Divided by Sex

**Regular Classes:** Baby Puppy ( 3 – 6), Junior (6-9), Senior (9-12), (12-18), Canadian Bred, Bred By Exhibitor, Open, Veteran, Specials Only.

**Non- Regular Classes:** Exhibition only, Stud Dog, Brood Bitch,

**UNOFFICIAL CLASSES:** Working Terrier (for any Border Terrier, either sex, who has attained any CKC Working Title, American Working Terrier Association, (CKC recognized) certificate of Gameness, or an American Kennel Club Junior Earthdog, Senior Earthdog or Master Earthdog title. Spayed or neutered animals may compete. Award for first in class only.)

**Note:** Dogs entered for the unofficial classes must also be entered in one of the official classes or Exhibition Only. If entered in Unofficial classes, spayed/neutered dogs must be entered in exhibition only.

**PRIZES**

Through the generosity of members and friends, Prizes and/or Rosettes will be awarded for Best Of Breed, Best Of Opposite, Best Baby Puppy in Breed, Best Puppy, Winners Dog, Winners Bitch, Best Of Winners, Veteran Dog & Bitch, Working Dog & Bitch, Stud Dog, Brood Bitch, awards for Best Otter Head, Best Bred by Exhibitor in Specialty. In addition, an award will be offered for all Border Terriers receiving a qualifying score in any of the SD & G Obedience, Rally, or Agility trials on the day of the specialty.

The prize for Best Otter Head will be awarded jointly by the Breed and Sweepstakes Judges

**AWARD OF MERIT:** One Rosette will be offered for every ten dogs entering the Best of Breed ring. Award of Merit will be presented at the discretion of the Judge

**Perpetual Trophies**

**Best in Specialty Perpetual Trophy**

The **Elaine Marshall Perpetual Trophy** for Best in Regular (Puppy) Sweepstakes  
**Russethill Trophy** for Best Bred By Exhibitor in Specialty.

**SWEEPSTAKES**

**Please Note:** All Dogs entered in Sweepstakes must also be entered in one of the official classes at the specialty.

This specialty will include SWEEPSTAKES, VETERAN SWEEPSTAKES as follows:

All Regular Sweepstakes classes divided by sex - 6 - 9 Mos, 9 -12 Mos, & 12 -18 Mos, as of the day of the specialty.

All Veteran Sweepstakes classes are to be divided by sex - 7-years and over, as of the day of the specialty.

**Prizes:** SWEEPSTAKES & VETERAN SWEEPSTAKES

40 % of all entries, & Rosette, will be awarded for Best in Sweeps & for BOS in Sweeps.

Flat ribbons will be awarded for 2<sup>nd</sup> to 4<sup>th</sup> placements in each class. Balance of 20% will be retained for Administration

**THE BORDER TERRIER CLUB OF ONTARIO - Picnic**

Sunday August 25/13, hosted by The Border Terrier Club of Ontario.

A post-show picnic will be held on site at 5pm at a cost of \$10/person.

please contact Pat Dimitrovski at patdimitrovski@hotmail.com to reserve .

**SILENT AUCTION** -- There will be a Silent Auction hosted by The Border Terrier Club of Ontario.

Contact - Sophie Cairns at 8815 Purdy Rd, Ashton, ON K0A 1B0 email baytreeborders@xplornet.com  
of your donation and bring it along on Sunday, August 25, 2013

**"BORDER BITS"**- All Border Terriers attending the Stormont, Dundas and Glengarry shows are

invited to join us at 4 pm on Sunday, August 25 for pre-dinner hospitality and this fun and educational event. This will be a "hands on" event that encourages all attending to join in the judging, assessing these distinctive traits that help to define our breed type. Enter your dog for Best Carrot Tail, Best Teeth and Bite, Best Rib or Best Hide and Coat".

Enter on the day. Prizes will be awarded to the winner in each of the four categories.

**For More information Contact - Karen Nesbitt - knesbitt@kos.net**

---

---

# Ottawa Valley Pointing Dog Club

SPECIALTY SHOW for

Kleiner Munsterlander Vorstehund, Braque Français, Wire-Haired Pointing Griffon, Pointer, Pointer (GLH, GSH, GWH), Pudelpointer, Setter ( Irish, English, Gordon, Irish R & W), Spaniel (Blue Picardy, Brittany, French), Spinone Italiano, Vizsla (SM & WH), Weimaraner

## Sunday, August 25, 2013

### CONFORMATION - Regular & Non-Regular Classes

#### **Mr. Richard Beauchamp**

1241 Knollwood Dr , PMB #4, Cambria, CA USA 93428-3343

### SWEEPSTAKES – All Sweepstakes Classes

**Joanne Barrie.** 549 Scotchline Road, Oxford Mills, ON



**PROUDLY SPONSORED BY**

**Eukanuba**

### OFFICERS

President .....	Kevin MacWilliams	Vice-President .....	Linda Cooney
Treasurer .....	Deborah Cook	Secretary .....	Gail Docherty
Field Director .....	Kevin MacWilliams	Hospitality .....	OVPDC Members
Show Chair .....	Gail Docherty/ Deborah Cook		
Show Superintendent .....	Jodie O'Meara	Show Secretary .....	COLMAR Show Service

### CLASSES - Divided by Sex

Regular Classes: Junior (6-9), Senior (9-12), (12-18), Canadian Bred, Bred By Exhibitor, Open, Veteran, Specials Only.

Non – Regular Classes: Exhibition Only, Field Dog\*.

\*Entries in Field Class may be spayed or neutered & must be entered in any OVPDC Specialty class or Exhibition Only

*\*The Field Dog class will be judged after Best of Breed for each breed*

### TROPHIES AND ROSETTES

The following Ribbons, Rosettes and Trophies have been made possible by the generosity of members and friends of the Ottawa Valley Pointing Dog Club and by Eukanuba:

Ribbons will be awarded 1st thru 4th Place and to Winners Dog & Bitch in all Regular Classes

#### **Rosettes will be awarded:**

In each breed for Best of Breed; Best of Opposite Sex; Best of Winners, Best Veteran, Best Puppy; and Best Field Dog

To Best in Multiple Breed Specialty (MBS); Best Puppy in MBS; Best Veteran in MBS; Best Field Dog in MBS

Highest qualifying score in Obedience by a pointing breed, on each of Saturday and Sunday with host club obedience trials

Highest qualifying score in Rally by a pointing breed, on each of Saturday and Sunday with host club obedience trials

Highest cumulative daily score in agility by a pointing breed, on each of Saturday and Sunday at host club agility trials

#### **Trophies will be awarded:**

To Best in Multiple Breed Specialty (MBS); Best Puppy in MBS; Best Veteran in MBS; Best Field Dog in MBS; Best of Breed; Best Field Dog in Breed; Highest qualifying score in Obedience, by a pointing breed during 2 days (Saturday/Sunday); Highest qualifying score in Rally, by a pointing breed during 2 days (Saturday/Sunday); Highest qualifying score in obedience, by a German Short-Haired Pointer during 2 days (Saturday/Sunday); Highest Cumulative 2 day (Saturday/Sunday) Score in agility, by a pointing breed.

#### **Three Ottawa Valley Pointing Dog Club Versatility Awards.**

- (1) Open to all Pointing Breeds (must not be entered in CKC field test)
- (2) Open to all German Short-Haired Pointers (must be entered in CKC field test)
- (3) Open to all Pointing Breeds (must be entered in CKC field test)

(Continued on next page.....)

(.....Continued from the previous page)

#### **Perpetual Trophies and Awards**

The following perpetual trophies will be awarded but will remain with the hosting club:

- Best in Multiple-Breed Specialty
- Best Puppy in Multiple-Breed Specialty
- Best Veteran in Multiple-Breed Specialty
- Best Field Dog in Multiple-Breed Specialty
- Best in Sweepstakes – Puppy and Veteran
- Highest Qualifying Score in Obedience (all Pointing Breeds competing)
- Highest Qualifying Score for a German Short-Haired Pointer in Obedience
- Highest Qualifying Score in Rally (All Pointing Breeds Competing)
- Highest Cumulative Score in Agility (all Pointing Breeds competing)
- Highest Qualifying Score in the Hunt Test (all Pointing Breeds competing)
- The OVPD Club Versatility Award (All Pointing Breeds Competing)
- The OVPD Club Versatility Award (German Short-Haired Pointer)
- The OVPD Club Versatility Award – Field- (all Pointing Breeds competing)

#### **Unofficial classes**

- Best Field Dog in Breed\*
  - Best-in-Multiple Breed Specialty (Best in each breed to compete)
  - Best Puppy in Multiple Breed Specialty (Best Puppy in each breed to compete)
  - Best Veteran in Multiple Breed Specialty (Best Veteran in each breed to compete)
  - Best Field Dog in Multiple Breed Specialty (Best Field Dog in each breed to compete)
- \* Must have at least 1 confirmed qualifying score in a CKC or AKC hunting event, and must also enter Regular Specialty Classes or Exhibition Only (Veteran & Exhibition entries may be spayed/neutered)

#### **Sweepstakes**

- Sweepstakes\* – Not divided by Sex or Breed, (6 to 9 months, 9 to 12 months, 12-18 months)
- Veterans\* Sweepstakes - Not divided by Sex or Breed, (7-10 years, over 10 years)  
(Veterans may be spayed or Neutered)  
Breeds & sexes will be judged together

\* Must also enter Regular Specialty Classes or Exhibition Only

**Prizes** for Sweepstakes and Veteran Sweepstakes: Prize money to be divided as follows:

75% of the entry money received will be divided by the total number of entries and awarded to the winner of each of the classes based on the number of dogs entered in that class.

No additional money will be awarded to the Best in Sweepstakes.

The remaining 25% of the entry fee will be retained to defray expenses.

Best in Sweepstakes, & Best Veteran in Veteran Sweepstakes

#### **Special Events**

All OVPDC members, friends and exhibitors are invited to ringside for refreshments on the day of the specialty.

Booster: (All Pointing Breeds) Saturday, August 24, 2013

Obedience Competition (Friday, Saturday & Sunday, with Host Show)

Rally Competition (Friday, Saturday & Sunday, with Host Show)

Agility Competition (Friday, Saturday & Sunday with Host Show)

CKC Field Test nearby (Tuesday August 27, 2013)

3 OVPDC Versatility Awards - (awarded at Field event Tuesday August 27, 2013)

#### **Junior Handling**

JUNIOR HANDLING will be offered – Judge: TBA, Time during the lunch break

All Juniors should register with the Show Secretary

one hour before competition.

Flats for 1st to 4th in each class, and a Rosette & Prize for Best Junior Handler & Reserve Junior

Handler overall Junior Handlers - each 1st place winner will receive a prize from "Eukanuba"



**Please visit [www.ovpdc.org](http://www.ovpdc.org)**

**PROUDLY SPONSORED BY**  
**Eukanuba**



---

---

**SPECIALTY SHOW  
FOR MINIATURE SCHNAUZERS ONLY**

Sponsored by Rideau Terrier Club - **Sunday, August 25, 2013**

The 2013 Rideau Terrier Club Miniature Schnauzer Specialty is dedicated  
to the memory of Danielle Joncas (Audigny Miniature Schnauzers)

**CONFORMATION** - Regular Non-Regular Classes

**Fabián Daza Almendrales,**

Avenida 9 No. 116-20 Consultorio 626, **Bogotá, Columbia**

**CLUB OFFICERS**

President.....Karen Nesbitt  
Vice-President.....Anita Roy  
Treasurer .....Squibs Mercier  
Secretary .....Laura Grieveson

**SHOW COMMITTEE**

Show Chair .....Jodie O'Meara  
Show Superintendent.....Jodie O'Meara  
Show Secretary - COLMAR Show Service

**Regular Classes** - Divided by Sex (Spayed/neutered dogs may be entered in Veteran class)

Jr (6-9), Sr (9-12), 12 to 18 months, Canadian Bred, Bred By Exhibitor, Open, Veteran, Specials Only.

**Non – Regular Classes:** Exhibition Only,

**AWARDS**

Prize & Rosette for Best of Breed,  
Rosettes will be awarded to, Best of Opposite, Best Puppy, Best Veteran  
Winners Dog, and Bitch, Best of Winners, Reserve Winners Dog, and Bitch.

**Perpetual Trophy**

???

**For More information Contact - Karen Nesbitt - [knesbitt@kos.net](mailto:knesbitt@kos.net)**

**PLEASE CHECK EACH SPECIALTY FOR THE CLASSES THAT ARE OFFERED**

<input type="checkbox"/> <b>Borzoi</b> Canada- Saturday Aug 24/13 <input type="checkbox"/> <b>Irish Setter</b> Club of Canada- Saturday Aug 24/13 <input type="checkbox"/> <b>Ottawa Valley All Setter</b> Association- Saturday Aug 24/13 <input type="checkbox"/> <b>Pointer</b> Club of Canada National - Sat August 24, 2013 <input type="checkbox"/> <b>German Shorthaired Pointer</b> CC -Sat August 24, 2013		<b>SD &amp; G Specialties</b> <input type="checkbox"/> Rideau <b>Terrier</b> Club - Group Four Specialty- Sat Aug 24/13 <input type="checkbox"/> <b>Vizsla</b> Canada (National) - Saturday August 24, 2013 <input type="checkbox"/> <b>Border Terrier</b> Club of ON - Sunday August 25, 2013 <input type="checkbox"/> Ottawa Valley <b>Pointing Dog Club</b> - Sunday August 25, 2013 <input type="checkbox"/> <b>Miniature Schnauzer</b> - RTC -Sunday, August 25, 2013	Armband # _____
 <b>Price List - Entry Fee:</b> \$ 29.00 CDN/USD <b>Listing Fee:</b> \$ 9.70 & Baby Puppy No Listing Fee <b>Other Fees:</b> Exhibition, Sweepstakes, Non Regular, \$15.00 CDN/USD			
<b>PRE - ORDERED CATALOGUES - <input type="checkbox"/> ALL BREED \$ 10.00 CDN/USD</b>			
<b>Cheques Payable</b> to SD & G Dog Association		<b>Entries Close: Tuesday July 30, 2013 at 8pm</b>	
<b>CONFORMATION</b> <input type="checkbox"/> BABY. Puppy (3-6 mth) <input type="checkbox"/> 12 - 18 months <input type="checkbox"/> Canadian Bred <input type="checkbox"/> Open <input type="checkbox"/> Veteran <input type="checkbox"/> JR. Puppy (6 - 9 mth) <input type="checkbox"/> 12 - 15 months <input type="checkbox"/> Bred By Exhibitor <input type="checkbox"/> Specials Only <input type="checkbox"/> Sexually Altered <input type="checkbox"/> SR. Puppy (9 - 12 mth) <input type="checkbox"/> 15 - 18 months			
<b>SWEEPSTAKES</b> <input type="checkbox"/> 3-6 MONTHS <input type="checkbox"/> 9 - 12 months <input type="checkbox"/> 15-18 months <input type="checkbox"/> 7-9 years <input type="checkbox"/> 9 years + <input type="checkbox"/> 11-12 years <input type="checkbox"/> 6 - 9 MONTHS <input type="checkbox"/> 12-15 months <input type="checkbox"/> 12-18 months <input type="checkbox"/> 7 -10 years <input type="checkbox"/> 10 years + <input type="checkbox"/> 13 years + <input type="checkbox"/> 18 - 24 months <input type="checkbox"/> 9 -11 years <input type="checkbox"/> 11 years + <input type="checkbox"/> 3 Generation Sweepstakes			
<b>SPECIALTY OBEDIENCE</b> <input type="checkbox"/> Pre- Novice <input type="checkbox"/> Novice A <input type="checkbox"/> Novice B <input type="checkbox"/> Novice C <input type="checkbox"/> Open A <input type="checkbox"/> Open B <input type="checkbox"/> Utility A <input type="checkbox"/> Utility B <input type="checkbox"/> Intermediate Novice   <b>JUMP HEIGHTS</b> Height -    Width -			
<b>NON REGULAR CLASSES</b> <input type="checkbox"/> Exhibition Only <input type="checkbox"/> Brace <input type="checkbox"/> Brood Bitch <input type="checkbox"/> Stud Dog <input type="checkbox"/> Parade of Veterans <input type="checkbox"/> Parade of Titleholders <input type="checkbox"/> Field Dog <input type="checkbox"/> TEAM <b>ANY OTHER CLASS NOT LISTED</b> <input type="checkbox"/>			
<b>BREED</b>		<input type="checkbox"/> Short - Haired <b>SEX:</b> <input type="checkbox"/> MALE OR <input type="checkbox"/> FEMALE <input type="checkbox"/> Long - Haired	
<b>REGISTERED NAME OF DOG</b> Check One & Enter Number Here <input type="checkbox"/> CKC Reg # <input type="checkbox"/> CKC PEN # <input type="checkbox"/> CKC ERN # <input type="checkbox"/> CKC Misc Cert.# <input type="checkbox"/> LISTED			
<b>DATE OF BIRTH:</b> Please Circle Month Jan Feb Mar Apr May June July Aug Sept Oct Nov Dec Day _____ Year _____.		<b>IS THIS A PUPPY?</b> <input type="checkbox"/> Yes or <input type="checkbox"/> No <b>PLACE OF BIRTH?</b> <input type="checkbox"/> Canada <input type="checkbox"/> Elsewhere	
<b>BREEDER(S)</b>			
<b>SIRE</b>			
<b>DAM</b>			
<b>REGISTERED OWNER(S)</b>			
<b>OWNER'S ADDRESS</b>			
<b>CITY</b>	<b>PROV/STATE</b>	<b>POSTAL CODE/ZIP</b>	
<b>NAME OF OWNERS AGENT (IF ANY) AT THE SHOW</b>			
<b>AGENT'S ADDRESS</b>			
<b>CITY</b>	<b>PROV/STATE</b>	<b>POSTAL CODE/ZIP</b>	
<b>Mail ID to:</b> <input type="checkbox"/> OWNER Or <input type="checkbox"/> AGENT			
<small>I certify that I am the registered Owner(s) of the dog or that I am the authorized agent of the Owner(s) whose name(s) I have entered above and accept full responsibility for all statements made in this entry. In consideration of the acceptance of this entry, I (we) agree to be bound by the rules and regulations of the Canadian Kennel Club and any additional rules and regulations appearing in the premium list. Also, by signing this form I certify that I will not hold the Show giving Club, it's members, Directors, Employees, or Agents, liable in the event of any accident or misfortune however caused.</small>			
Signature of Agent or Owner _____		Phone Number _____	
a 15% + HST, charge applies on all Credit Card Charges		Email address _____	
<input type="checkbox"/> VISA <input type="checkbox"/> MasterCard <input type="checkbox"/> AMEX <b>Expiry Date:</b> Month > _____ Year > _____			
<b>Card Number:</b> _____ - _____ - _____ - _____			
<b>Name of Card Holder:</b> _____			
<b>Fax #</b> _____ <b>Mail To:</b> COLMAR Show Service, 40 Mercer St, Chatham, ON, Canada N7M 6E1 <b>519-351-3223</b> <b>Web Site:</b> www.colmars.com			

All Fees are payable at time of entry. No entry will be processed or entered in this show without payment.  
 Listing fees are applicable for all dogs entered in the shows that do not have an individual CKC Reg. Number or an ERN number.

**Note:** Overflow camping hydro (electric) is \$50.00 and **MUST to be pre paid** by August 15, 2013  
 Please forward payment to; Jodie O'Meara,  
 6135 Garlandside Rd., Cumberland, ON K4B 1S7  
 For more information contact - Jeff Dale, [jdale@trademarkmedia.ca](mailto:jdale@trademarkmedia.ca)

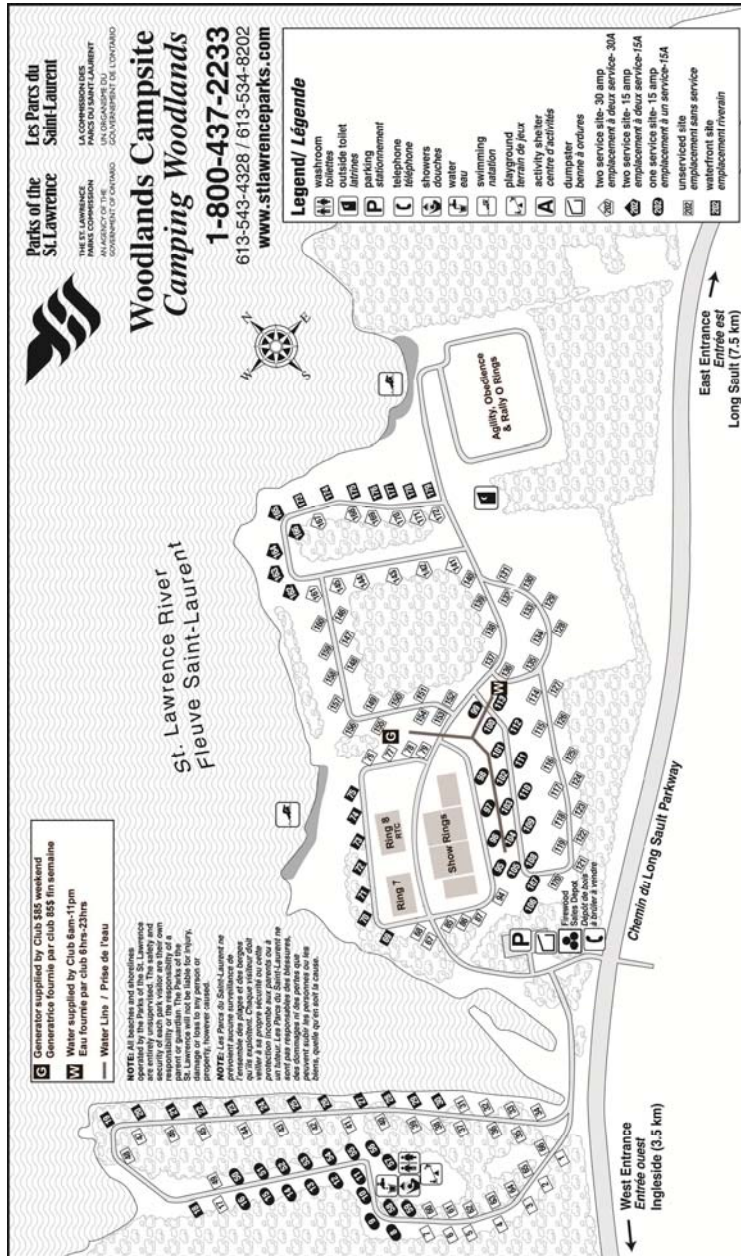

**RV Trailer and Exhibitor Parking & Electrical Hook-ups**  
 RV's & Trailers Reservations Accepted & Strongly Suggested, Please call 1-800-437-2233. Inform the Park you are with the Dog Show  
 There is no site sharing & visitors are not permitted to enter the park after 8pm. Limited Electrical Hook-ups. Don't be disappointed book early.  
**No refunds under any circumstances. Electrical - per receptacle \$ 85.00 CDN or USD. Any & All unpaid hook-ups will be removed.**  
**All Electrical hook-ups are to be paid at the show and to SD & G.** Please refer to the map for campsite you wish to reserve closest to amenities.  
 It is your responsibility to have enough cord to reach the generator, or hose for Water Hook-up. Refer to Map for locations. Water lines are marked on map (W).  
 SD & G or it's affiliates do not accept or assume any liability for any damages caused by removal of unpaid electrical or Water Hook-ups.  
 Unavailable Sites: - 71, 72, 83, 84, 88-92, 93, 95, 96, 98&, 100, 102, 103, 105-108, 109, 153-156, 154, 155, 163-166, 172  
 Please Contact Jeff Dale, 613-366-2030 ext # 2000 [jdale@trademarkmedia.ca](mailto:jdale@trademarkmedia.ca)

**Have More Than Ten Dogs?** - Exhibitors /Handlers with 10 or more dogs contact - Jeff Dale, 613-366-2030 ext# 2000 jdale@trademarkmedia.ca - for any help in your stay.

**No show or event - Specialty, All Breed, Performance Event, or Best in Show Judging, shall be delayed for any Exhibitor who has a conflict in another ring or event.**

**All exhibitors are expected to have alternative arrangements made for any possible conflict.**

### **ACCOMMODATIONS**

The following Motels/Hotels may accept dogs. Some of them may require a deposit or room-cleaning fee. Please verify acceptance of dogs in rooms when making reservations and respect Motel/Hotel property to ensure that you will be welcomed back.

If you are planning on leaving your dogs crated in your room, please do not leave them alone. Some dogs have a tendency to voice their disapproval to this situation and to the other guests.

**Best Western** 1515 Vincent Massey Dr., Cornwall ON  
613-932-0451

**Comfort Inn** 1625 Vincent Massey Dr., Cornwall ON  
613-937-0111

**Days Inn** 1541 Vincent Massey Dr., Cornwall ON  
613-937-3535

**Lion Motel** Hwy 32 exit # 778, Long Sault, ON  
613-634-2119

**Nites Inn** 2120 Vincent Massey Dr., Cornwall ON  
613-932-9623

**Eukanuba** 



### **DIRECTIONS TO THE SHOW SITE**

(Map only as reference please refer to an official Ontario road map)

